

GMAX™ II

3900/5900/5900HD/7900

Quick Operator's Guide

⚠ WARNING

This procedure is for water-base paints and flushing fluids. For solvent-base paints and flushing fluids (i.e. mineral spirits), you must read Fire and Explosion Hazard in the Operating Instructions. * check the Graco operations manual delivered with the unit for more details.

SETUP

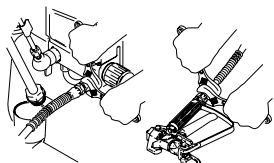

Connect hose to sprayer and gun. Tighten hose connections with wrench.



Unscrew tip & guard from gun.

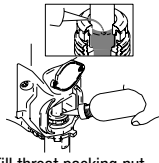

Fill throat packing nut with TSL to prevent premature packing wear.

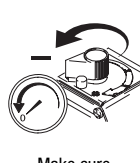

Make sure power switch is set to OFF.

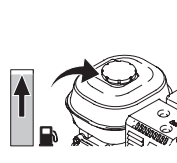

Check oil level of motor and pump.

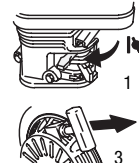

Cold engine starts.

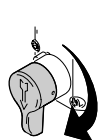
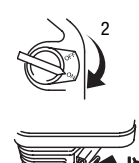

Turn prime valve to Prime position (down).



Place siphon tube in pail partially filled with water.

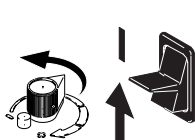

Turn pressure control knob to lowest pressure, and set power switch to ON.



Increase pressure until sprayer starts and water runs out of prime tube. Let water run out of prime tube for 15 seconds.



Decrease pressure until sprayer stops.



Turn prime valve to Spray position (horizontal).



Make sure safety lever of gun is OFF.



Aim gun at inside wall of water pail and squeeze trigger.



Increase pressure until sprayer starts. Keep gun triggered into water pail for 1 minute. Release trigger.



Turn prime valve to Prime position (down).



Place siphon tube in paint pail, but leave drain tube in water pail.



Aim gun at inside wall of water pail, and squeeze trigger.

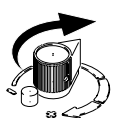

Increase pressure until sprayer starts and paint comes out of drain tube.



Keeping gun triggered into water pail, turn prime valve to Spray position (horizontal).



When paint comes out of gun, release trigger and turn safety lever of gun to ON.

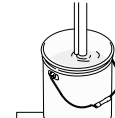

Transfer drain tube to paint pail.

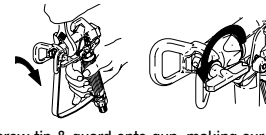

Screw tip & guard onto gun, making sure arrow-shaped handle of tip is pointing forward. You can reverse this tip to quickly clear clogs without taking it apart.

CHOOSE THE RIGHT TIP & FILTER



| | Ink | Stains | Laquers | Enamels | Urethanes | Acrylics | Emulsions | Latex | Block filler | Intrinsics | Texture material for spray applications | NEW 1 st digit X5 =fan width* | WORN Time to change! | | | | | | | |
|-------------|-----|----------|---------|----------|-----------|----------|-----------|-------|--------------|------------|---|--|----------------------------|-------|-----|-----|-----|-----|-------|-------|
| | | 109 | 111 | 113 | 115 | | 119 | 121 | | | | | 5 cm | 3 cm | | | | | | |
| | 207 | 209 | 211 | 213 | 215 | 217 | 219 | 221 | 223 | 225 | | 235 | 10 cm | 7 cm | | | | | | |
| | 307 | 309 | 311 | 313 | 315 | 317 | 319 | 321 | 323 | 325 | 327 | 331 | 15 cm | 10 cm | | | | | | |
| | | 409 | 411 | 413 | 415 | 417 | 419 | 421 | 423 | 425 | 427 | 429 | 433 | 435 | 439 | 443 | 451 | 455 | 20 cm | 15 cm |
| | | 509 | 511 | 513 | 515 | 517 | 519 | 521 | 523 | 525 | 527 | 529 | 531 | 533 | 535 | 543 | 551 | 555 | 25 cm | 20 cm |
| | | 609 | 611 | 613 | 615 | 617 | 619 | 621 | 623 | 625 | 627 | 629 | 631 | 633 | 635 | | 645 | 655 | 30 cm | 25 cm |
| | | | | | | | | | 721 | 723 | 725 | 729 | | 735 | | | | | 35 cm | 30 cm |
| | | | | | 815 | 817 | 819 | 821 | | | | 827 | 831 | 833 | 835 | | | | 40 cm | 35 cm |
| | | | | | 917 | | | | | | | | | 935 | | | | | 45 cm | 40 cm |
| pump filter | | 200 mesh | | 100 mesh | | | 60 mesh | | 30 mesh | | | | | none | | | | | | |
| gun filter | | 100 mesh | | 100 mesh | | | 60 mesh | | | | | | | none | | | | | | |

* at 30 cm spraying distance

SPRAYING



Turn safety lever of gun to OFF.

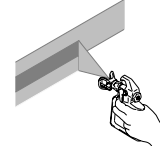
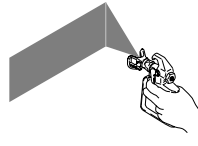
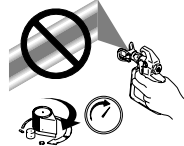

Point gun at area to be sprayed about 30 cm from surface, and begin moving gun before triggering. A good spray pattern is evenly distributed as it hits surface. Set pressure just high enough to spray without heavy edges. Use smaller tip size for thinner material and a larger tip size for thicker material if pressure adjustment cannot achieve even spray pattern.

SHUTDOWN AND CLEANUP * for AutoClean²: see bottom of this page



Set power switch to OFF.

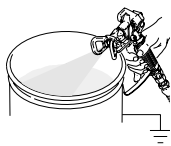

Trigger gun until pressure is relieved.

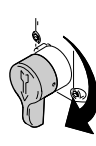

Turn prime valve to Prime position (down).

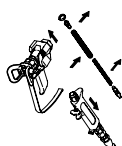

Remove gun filter assembly.

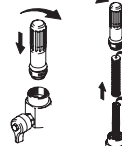

Remove manifold filter and spacer.

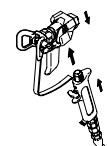

Assemble gun without filter.

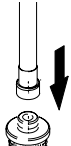

Unscrew inlet screen from siphon tube.



Unscrew tip & guard from gun. Clean gun filter, inlet screen, tip, guard and manifold filter with water and brush.

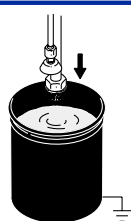

Place drain tube and siphon tube in pail of water.

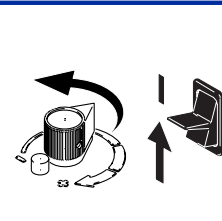

Turn pressure control knob to lowest setting, set power switch to ON, and increase pressure until sprayer starts. Let sprayer run and flush itself for 2 minutes.

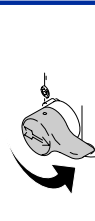

Keeping gun triggered into water pail, turn prime valve to Spray position (horizontal).



Keep gun triggered into pail for 1 minute, until water coming out of gun is clean.

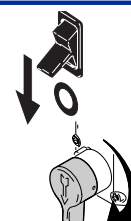

Set power switch to OFF, turn pressure control knob to lowest setting, and turn prime valve to Prime position (down).

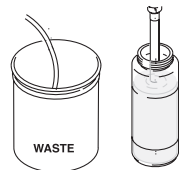

Place drain tube in waste pail and siphon tube in container of Pump Armor™

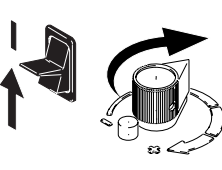

Set power switch to ON, and increase pressure until sprayer starts.



As soon as Pump Armor comes out of drain tube, set power switch to OFF.

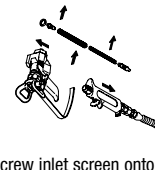

Screw inlet screen onto siphon tube, replace manifold filter and spacer, and assemble gun with filter, tip and guard.

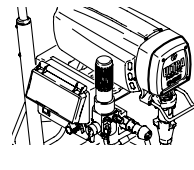

Wipe outside of sprayer, hose and gun with rag soaked in water or mineral spirits.

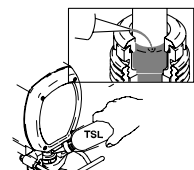

Fill throat packing nut with TSL™

AUTOCLEAN²™ GUIDE

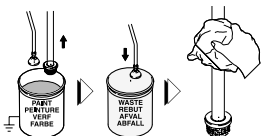

Remove suction and drain tubes from paint. Place drain tube into waste pail and wipe suction tube clean.



Place suction tube in appropriate cleaning fluid.

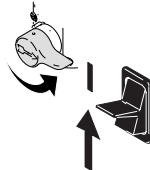

Close drain valve. Switch power ON.

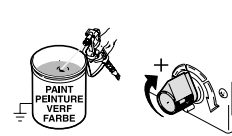

To save paint from hose and pump, trigger gun into paint pail and increase pressure. When cleaning fluid appears, release gun trigger.

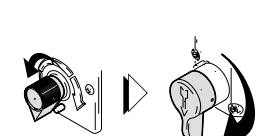

Turn pressure all the way down. Open drain valve.

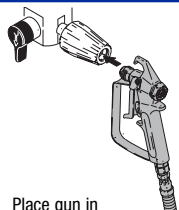

Place gun in AutoClean connector.

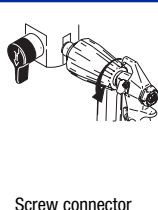

Screw connector onto gun.

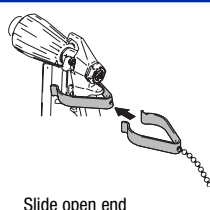

Slide open end over back of handle.



Rotate trigger lock clip 90° to lock trigger open.



Press display button until timer appears and turn pressure control knob to highest.



When finished, remove trigger clip from gun handle.

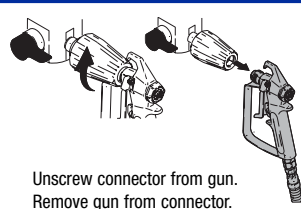

Unscrew connector from gun. Remove gun from connector.



Close drain valve.



With clean fluid, briefly trigger gun into waste pail several times to clear any debris from front of gun.

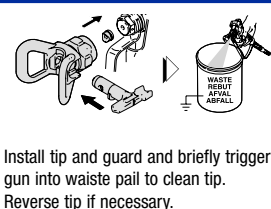

Install tip and guard and briefly trigger gun into waste pail to clean tip. Reverse tip if necessary.