

# T-MAX™ 506/657

## Quick Operator's Guide

### ⚠ WARNING

This procedure is for water-based paints and flushing agents. For solvent-based paints and flushing agents (i.e. mineral spirits), you must first read the section on Fire and Explosion Hazards in the Operating Instructions. Please note this Quick Guide is at no means replacing the official Graco manual. Graco can at no means be liable for any consequences of not following the safety regulations as stipulated in the official manual. \* Please check the Graco operations manual supplied with the unit for more details.

### SET-UP

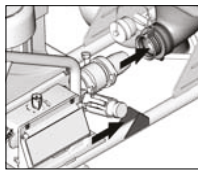

Connect pump module to hopper cart.

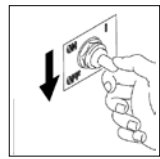
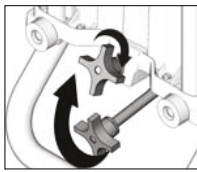

Turn pump control off (O). Plug electrical cord into grounded outlet.

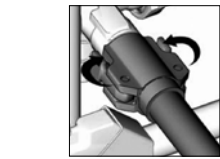
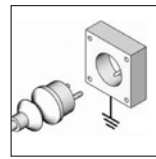

Remove pump plug. Connect product tube to pump outlet.

### START-UP



Spray **WITHOUT** Air  $\odot < .25$  mm



Fill product hopper with pre-mixed texture product.



Add water if thinning is required. Mix thoroughly.



Turn pressure control knob until steady stream flows from product tube.

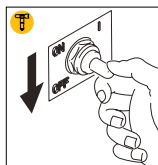

Turn pump OFF.

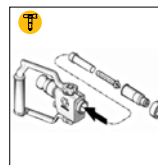

Install filter and tip extension.

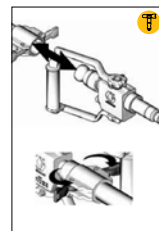

Connect applicator to product tube.

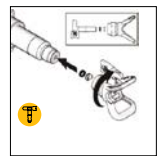

Screw tip assembly onto applicator.

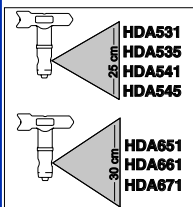

Use different tip nozzle size to adjust flow.

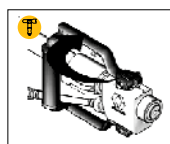

Turn applicator OFF. Turn ON/OFF switch to ON.



Turn pressure control to maximum. To spray, aim applicator at wall from 0.5 m distance wall and open applicator.



To clean clogged tip, turn applicator OFF, turn tip 180° to CLEAN position, aim towards free area, turn applicator ON. When clog clears, turn applicator OFF and tip to SPRAY position.

### PRESSURE RELEASE PROCESS



Turn pressure control off (O).

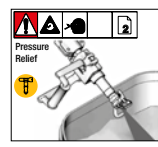

Aim applicator into hopper. Turn applicator ON.

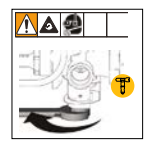

Loosen nut on bottom of pump 2-3 turns to release pressure.

### STAR-TUP



Spray **WITH** Air  $\odot \leq 1.5$  mm



Fill product hopper with mixed texture product.



Place product tube into hopper, turn ON/OFF switch to ON. Turn control knob to 'green' section and allow material to product 30 sec.

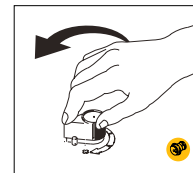
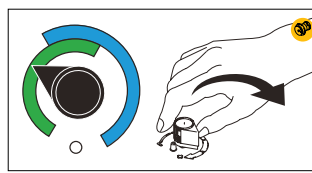

Turn pump control knob to shut pump off.

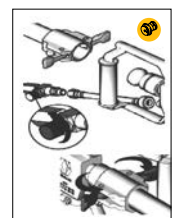

Screw air hose and valve to applicator. Connect product tube to gun.

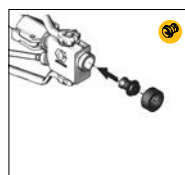

Turn applicator valve OFF. Insert air nozzle.

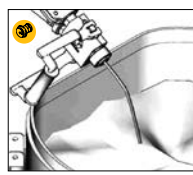

Hold applicator over product hopper and turn applicator ON.

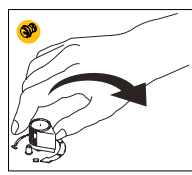

Turn air compressor ON. Turn pump control knob to 'green' section to achieve desired product flow rate.

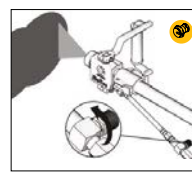

Regulate air valve for proper atomization.

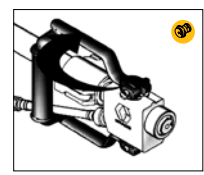

To stop spraying, turn applicator OFF.

# CLEAN-UP

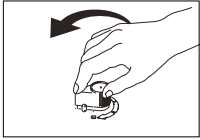

Turn pump control knob counter-clockwise, to shut off pump.  
Close applicator after pressure release.  
Close air valve.

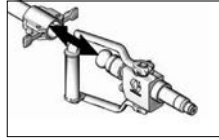

Shut air compressor OFF if spraying with air.  
Remove applicator from product tube.  
Clean applicator.



Turn pump control clockwise to pump unused texture product out of product hopper and tube.



Scrape remaining product in hopper into pump to be pumped from sprayer.

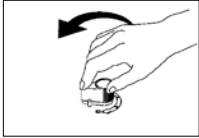

Turn pump control to (0) to shut pump OFF.



Remove drain plug from hopper.  
Clean hopper with water, brush and sponge. Insert drain plug.  
Fill hopper with 1/3 clear water.

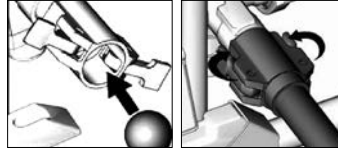

Insert moistened cleaning ball into pump.  
Connect product tube to pump outlet.

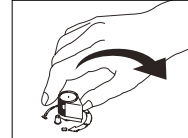

Turn pump control clockwise to start pump.

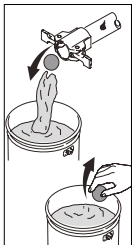

Run pump until cleaning ball exits product hose.  
Retrieve cleaning ball. Repeat till water comes out clear.

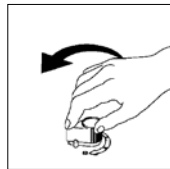

Rotate pump control to (0) to shut pump off.

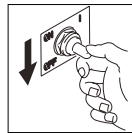

Set ON/OFF switch to OFF.

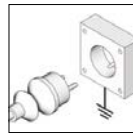

Clean applicator, spray tips and guard with brush.

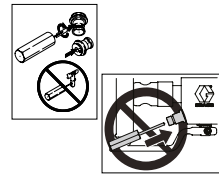
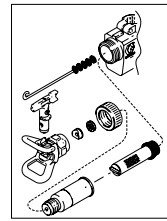

Clean hardened product from applicator nozzles with air nozzle cleaner.

# CHOOSE THE RIGHT TIP (HDA-XXX)

	XTRA LIGHT	LIGHT	MEDIUM	HEAVY
	HDA531	HDA541	HDA651	HDA671
HDA535	HDA545	HDA661	-	

	VERY FINE - 3 MM	FINE - 4 MM	MEDIUM - 6 MM	MEDIUM HEAVY - 8 MM	HEAVY - 10 MM
	248888	248524	248525	248526	248527