

# INSTRUCTIONS—PARTS LIST

This manual contains IMPORTANT  
WARNINGS AND INSTRUCTIONS  
READ AND RETAIN FOR REFERENCE



**306—840**

Rev. F  
Supersedes E

## AIR DRIVEN AGITATORS

100 psi (7 bar) MAXIMUM WORKING PRESSURE

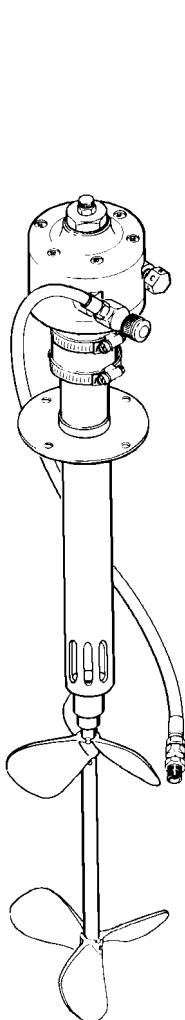

**Model 206—758, Series A**  
**Carbon Steel Agitator**  
For 30 gallon mix tanks  
and 55 gallon drums; 1/2 HP Motor

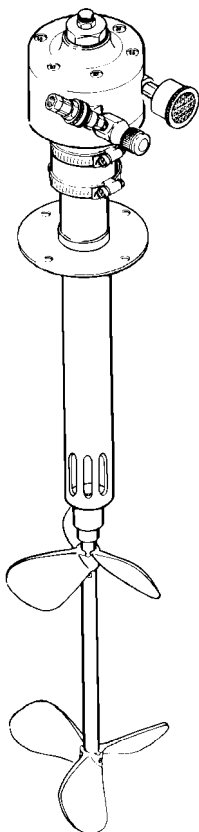

**Model 206—760, Series A**  
**Carbon Steel Agitator**  
For 60 gallon mix tanks; 1 HP Motor

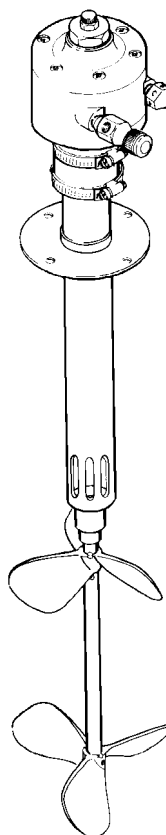

**Model 207—953, Series A**  
**Carbon Steel Agitator**  
For 15 gallon mix tanks; 1/2 HP Motor

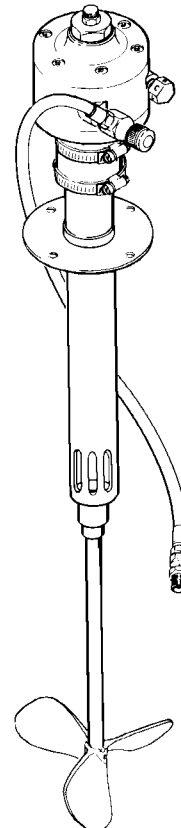

**Model 222—698, Series A**  
**Stainless Steel Agitator**  
For 30 gallon mix tanks and  
55 gallon drums; 1/2 HP Motor

### WARNING

**Hazard of using Fluid Containing Halogenated Hydrocarbons with Models 206—758, 206—760 & 207—953**

The propellers on the carbon steel agitators are aluminum. NEVER use 1,1,1-trichloroethane, methylene chloride, other halogenated hydrocarbon solvents or fluid containing such solvents with aluminum parts. Such use could result in a serious chemical reaction, with the possibility of explosion, which could cause death, serious bodily injury and/or substantial property damage.

Consult your fluid suppliers to ensure that the fluids being used are compatible with aluminum parts.

## Air Requirements

For continuous use, the 0.5 HP (373 W) agitator air motor typically requires 3 to 4 cfm (0.9 to 0.12 m<sup>3</sup>/min); the 1 HP (746 W) motor typically requires 6 to 8 cfm (0.17 to 0.23 m<sup>3</sup>/min).

## Preparing the Agitator for Use

### WARNING

To reduce the risk of serious bodily injury, including cuts, amputation of fingers, and splashing in the eyes or on the skin, always shut off the agitator and disconnect the air line before checking or repairing the agitator.

**NOTE:** The mounting gasket is not included with the agitator. To order, see the **Mounting Hole Diagram** (page 8) for the gasket part number.

1. Install the agitator on the cover of the fluid supply tank, with the gasket in place.
2. Position the agitator so the air line can be attached easily and will not obstruct other tank openings, lines, etc. Then bolt it in place.

**NOTE:** Refer to the **Dimensional Drawing** and **Mounting Hole Diagram** on page 8. See Fig 1 for air hose connections.

3. Install an air line filter to remove dirt and moisture from the air supply.
4. Downstream from the filter, install an air line lubricator for automatic air motor lubrication. Set the lubricator feed rate at 1 to 3 drops per minute. See **ACCESSORIES** on page 8.

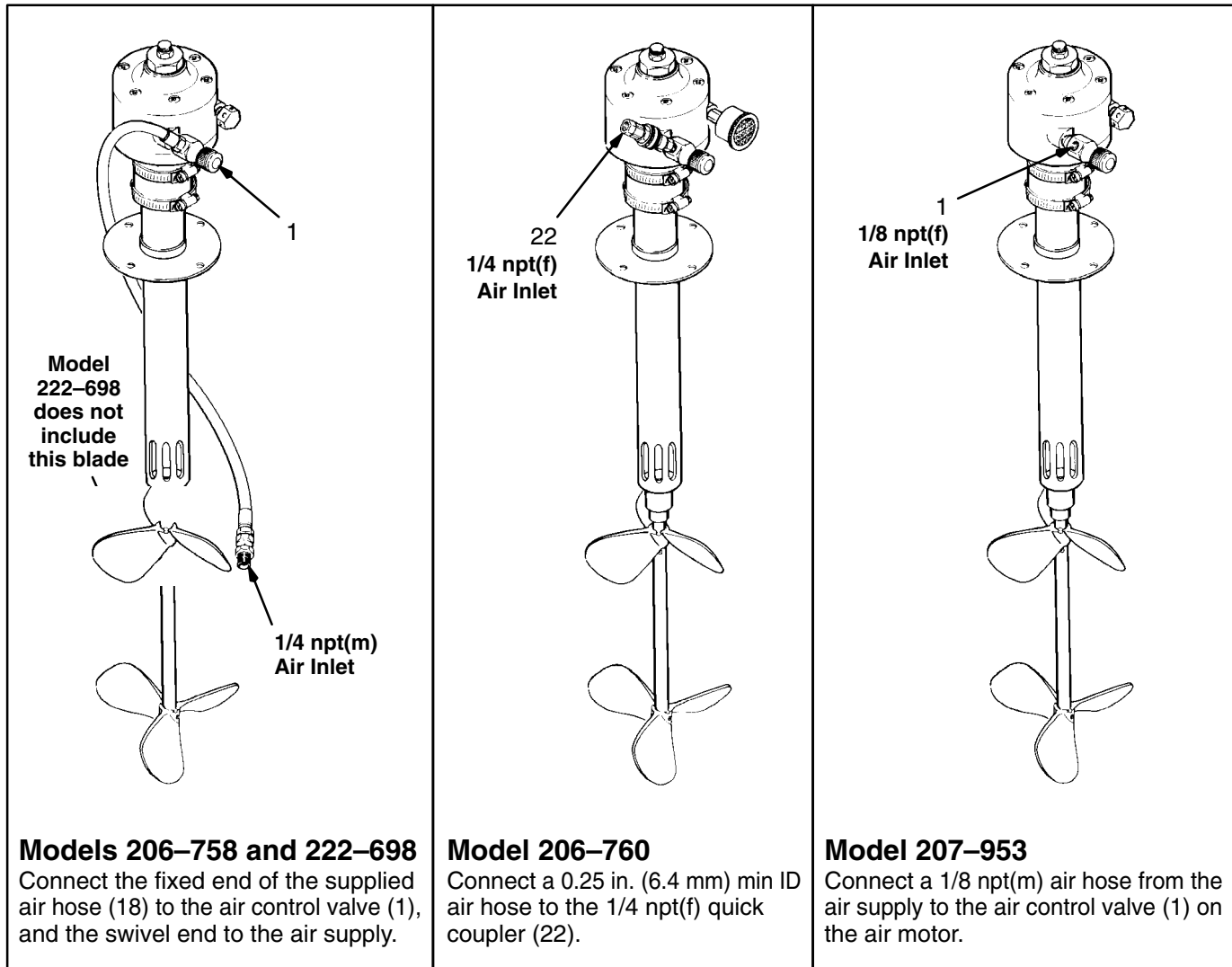

Fig 1

## OPERATION

**NOTE:** Reference numbers in parentheses refer to the callouts in the Parts Drawing and Fig 1.

Regulate the agitator speed with the air metering valve (1). Use the lowest agitator speed needed for thorough agitation of the paint. Excessive agitator speed may cause the paint to foam.

### WARNING

To reduce the risk of serious bodily injury, including cuts, amputation of fingers, and splashing in the eyes or on the skin, always shut off the agitator and disconnect the air line before removing or raising the agitator from the fluid supply tank.

### Finding the Proper Agitator Speed

1. Fill the fluid supply tank to about 3 or 4 in. (75 to 100 mm) above the agitator propellers (16).
2. Start the agitator and gradually increase the speed until a vortex begins to form in the paint. Reduce the speed slightly, then fill the tank.

**NOTE:** If you install an air shut-off valve in the supply line, you can set the same agitator speed each time it's used without repeating the procedure above.

3. Operate the agitator continuously while supplying paints or other fluids to the system.

## AIR MOTOR SERVICE

### WARNING

To reduce the risk of serious bodily injury, including cuts, amputation of fingers, and splashing in the eyes or on the skin, always shut off the agitator and disconnect the air line before removing or raising the agitator from the fluid supply tank.

### Lubricating the Air Motor

If an air line lubricator is not installed, the air motor must be manually lubricated daily. Lubricate the agitator air motor by placing 2 or 3 drops of SAE No. 10 detergent oil in the motor's air inlet. Run the agitator for about 1/2 a minute.

### Cleaning the Air Motor

If the agitator operation is erratic or sluggish, clean the air motor (11) as follows:

1. Remove the muffler and fill the muffler cavity with kerosene.
2. Operate the agitator slowly until all the kerosene is blown out.

### WARNING

To reduce the risk of serious bodily injury, including splashing of kerosene in the eyes or on the skin, or inhaling kerosene mist, keep your face away from the exhaust while flushing.

**NOTE:** Do not try to repair the air motor yourself. Contact a Graco authorized service depot.

### Model 206-758, Series A

Carbon Steel Agitator for 30 gallon mix tanks  
and 55 gallon drums

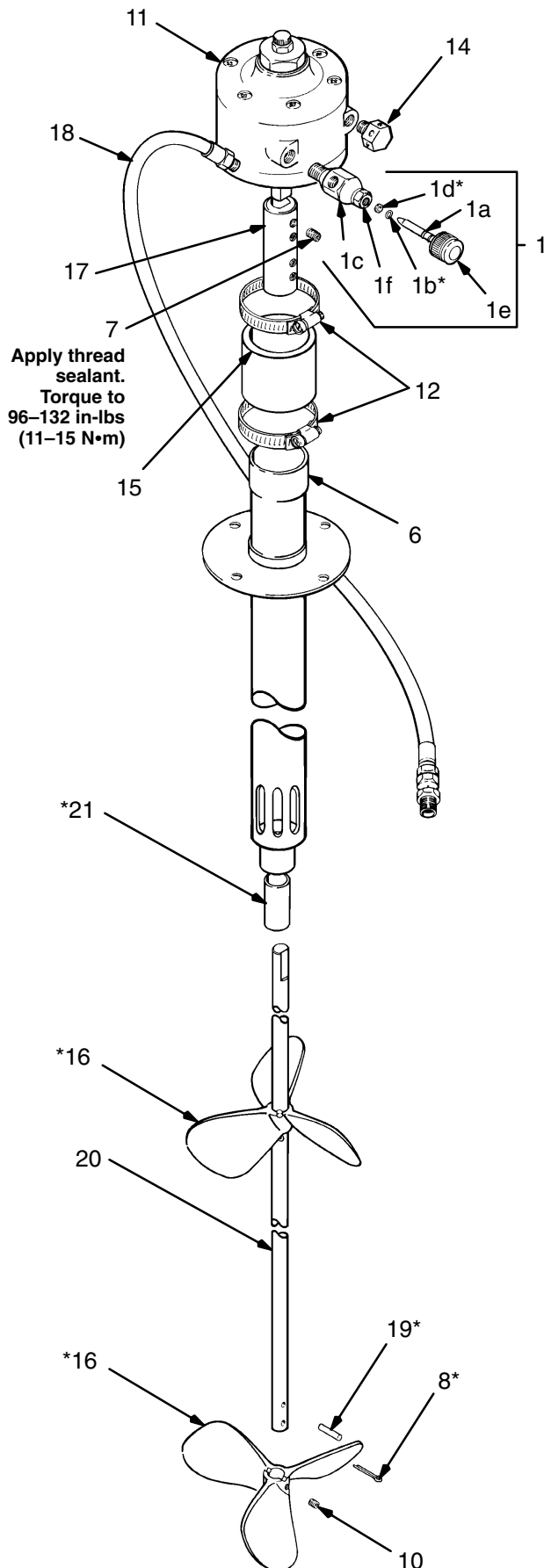

#### REF

NO.	PART NO.	DESCRIPTION	QTY
1	206-264	NEEDLE VALVE ASSEMBLY; Includes items 1a-1f	1
1a	166-529	•NEEDLE	1
1b	157-628*	•O-RING; nitrile rubber	1
1c	165-722	•HOUSING, air valve	1
1d	166-531*	•WASHER, friction	1
1e	164-698	•KNOB, adjusting	1
1f	166-532	•NUT, packing	1
6	207-622	GUIDE, agitator	1
7	100-053	SCREW, soc hd cup pt set; 5/16-18 x 1/4	4
8	100-579*	PIN, cotter; 0.11 (2.8 mm) dia; 1" (25 mm) long	2
9	100-633	WRENCH, hex key; 5/16 set screw size (not shown)	1
10	101-118	SCREW, soc hd cup pt set; No.10-24 x 1/2	2
11	101-140	MOTOR, air; 0.5 HP (373 W)	1
12	101-368	CLAMP, hose	2
13	101-369	WRENCH, hex key; No. 10 or 12 set screw (not shown)	1
14	156-969	MUFFLER, air exhaust	1
15	158-865	COUPLER, rubber	1
16	159-854*	PROPELLER; aluminum	2
17	159-858	COUPLING, steel	1
18	160-023	HOSE, air; cpld 1/8 npt (mbe) swivel one end; 0.25" (6.4 mm) ID; 18" (457 mm) long	1
19	160-077*	PIN, shear	2
20	172-313	SHAFT, agitator	1
21	166-565*	BEARING, PTFE®	1
22	101-369	WRENCH, hex key (not shown)	1

\*Recommended "tool box" spare parts. Keep on hand to reduce down time.

Loctite® is a registered trademark of the Loctite Corp.

#### HOW TO ORDER REPLACEMENT PARTS

- To be sure you receive the correct replacement parts, kits or accessories, always give all of the information requested in the chart below.
- Check the parts list to identify the correct part number; do not use the ref. no. when ordering.
- Order all parts from your nearest Graco distributor.

6 digit Part Number	Qty	Part Description

# PARTS DRAWING AND LIST FOR MODEL 206-760

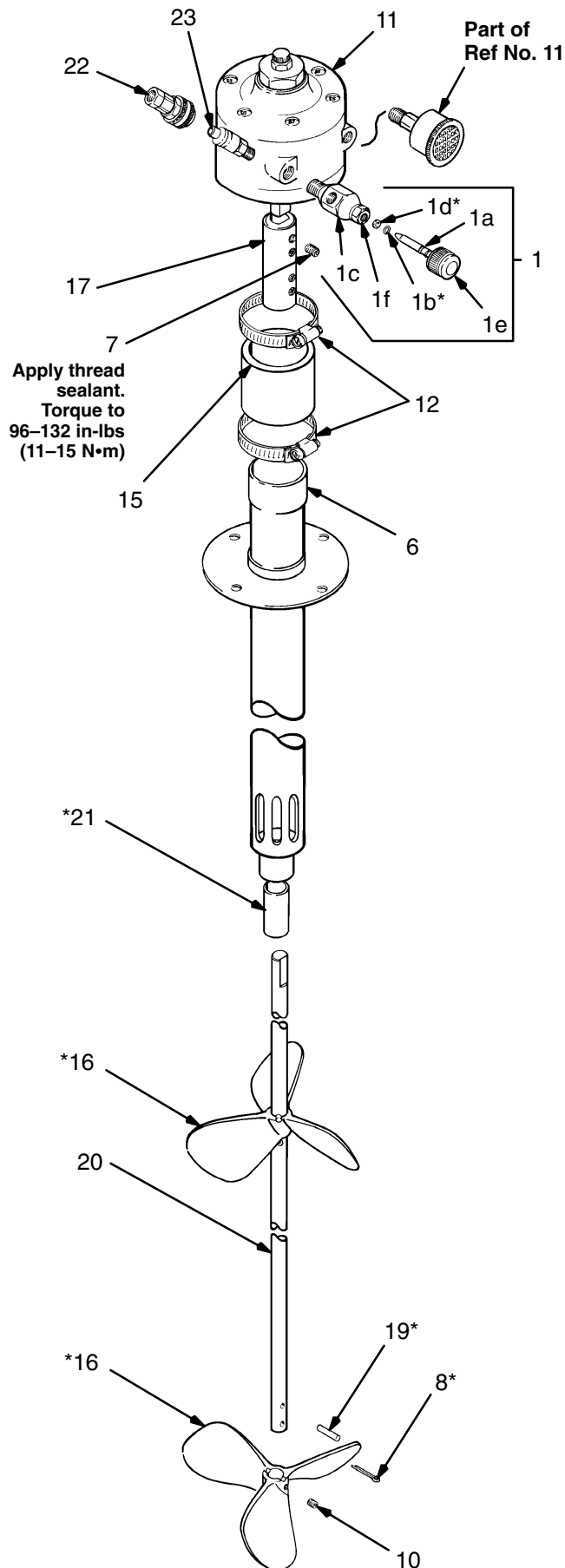

## Model 206-760, Series A

Carbon Steel Agitator for 60 gallon mix tanks

REF NO.	PART NO.	DESCRIPTION	QTY
1	206-264	NEEDLE VALVE ASSEMBLY; Includes items 1a-1f	1
1a	166-529	•NEEDLE	1
1b	157-628*	•O-RING; nitrile rubber	1
1c	165-722	•HOUSING, air valve	1
1d	166-531*	•WASHER, friction	1
1e	164-698	•KNOB, adjusting	1
1f	166-532	•NUT, packing	1
6	206-759	GUIDE, agitator	1
7	100-053	SCREW, soc hd cup pt set; 5/16-18 x 1/4	4
8	100-579*	PIN, cotter; 0.11 (2.8 mm) dia; 1" (25 mm) long	2
9	100-633	WRENCH, hex key; 5/16 set screw size (not shown)	1
10	101-118	SCREW, soc hd cup pt set; No.10-24 x 1/2	2
11	101-388	MOTOR, air; 1 HP (746 W)	1
12	101-368	CLAMP, hose	2
13	101-369	WRENCH, hex key; No. 10 or 12 set screw (not shown)	1
15	158-865	COUPLER, rubber	1
16	159-854*	PROPELLER; aluminum	2
17	159-858	COUPLING, steel	1
19	160-077*	PIN, shear	2
20	172-311	SHAFT, agitator	1
21	166-565*	BEARING, PTFE®	1
22	208-536	COUPLER, air line	1
23	169-969	FITTING, air line	1
24	101-369	WRENCH, hex key (not shown)	1

\*Recommended "tool box" spare parts. Keep on hand to reduce down time.

Loctite® is a registered trademark of the Loctite Corp.

## HOW TO ORDER REPLACEMENT PARTS

- To be sure you receive the correct replacement parts, kits or accessories, always give all of the information requested in the chart below.
- Check the parts list to identify the correct part number; do not use the ref. no. when ordering.
- Order all parts from your nearest Graco distributor.

6 digit Part Number	Qty	Part Description

**Model 207-953, Series A**

Carbon Steel Agitator for 15 gallon mix tanks

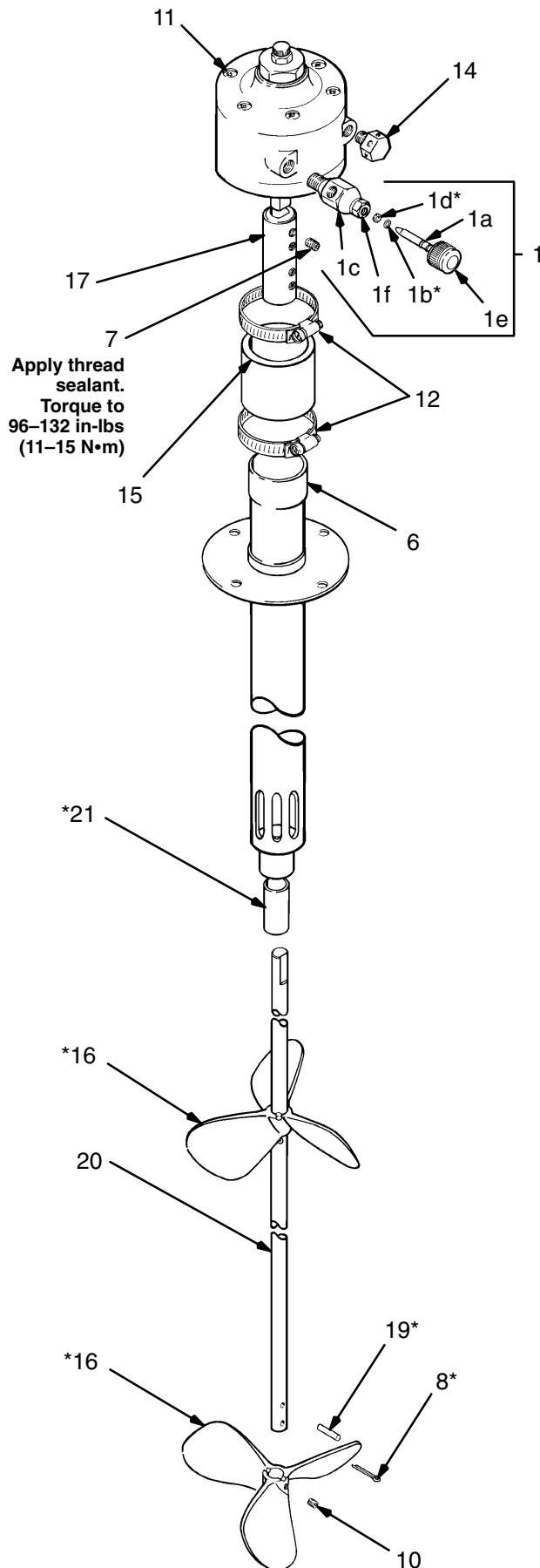

REF NO.	PART NO.	DESCRIPTION	QTY
1	206-264	NEEDLE VALVE ASSEMBLY; Includes items 1a-1f	1
1a	166-529	•NEEDLE	1
1b	157-628*	•O-RING; nitrile rubber	1
1c	165-722	•HOUSING, air valve	1
1d	166-531*	•WASHER, friction	1
1e	164-698	•KNOB, adjusting	1
1f	166-532	•NUT, packing	1
6	207-431	GUIDE, agitator	1
7	100-053	SCREW, soc hd cup pt set; 5/16-18 x 1/4	4
8	100-579*	PIN, cotter; 0.11 (2.8 mm) dia; 1" (25 mm) long	2
9	100-633	WRENCH, hex key; 5/16 set screw size ( <i>not shown</i> )	1
10	101-118	SCREW, soc hd cup pt set; No.10-24 x 1/2	2
11	101-140	MOTOR, air; 0.5 HP (373 W)	1
12	101-368	CLAMP, hose	2
13	101-369	WRENCH, hex key; No. 10 or 12 set screw ( <i>not shown</i> )	1
14	156-969	MUFFLER, air exhaust	1
15	158-865	COUPLER, rubber	1
16	159-854*	PROPELLER; aluminum	2
17	159-858	COUPLING, steel	1
19	160-077*	PIN, shear	2
20	172-353	SHAFT, agitator	1
21	166-565*	BEARING, PTFE®	1
22	101-369	WRENCH, hex key ( <i>not shown</i> )	1

\*Recommended "tool box" spare parts. Keep on hand to reduce down time.

Loctite® is a registered trademark of the Loctite Corp.

**HOW TO ORDER REPLACEMENT PARTS**

- To be sure you receive the correct replacement parts, kits or accessories, always give all of the information requested in the chart below.
- Check the parts list to identify the correct part number; do not use the ref. no. when ordering.
- Order all parts from your nearest Graco distributor.

6 digit Part Number	Qty	Part Description

# PARTS DRAWING AND LIST FOR MODEL 222-698

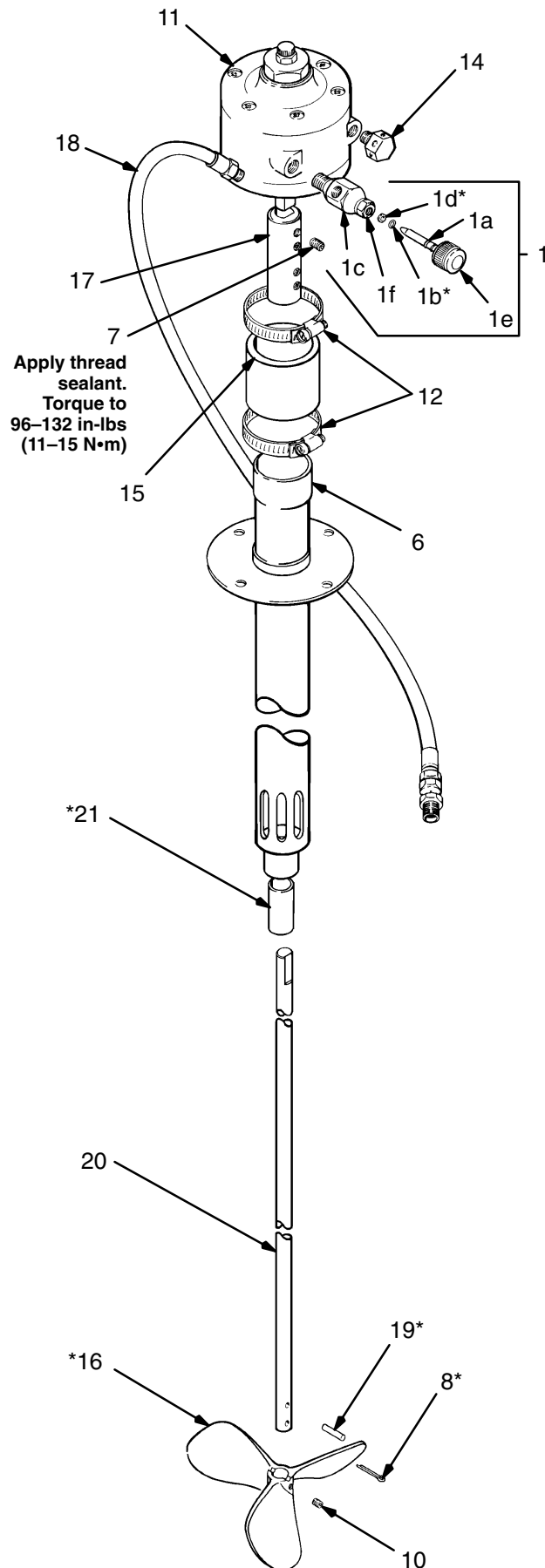

## Model 222-698, Series A

Stainless Steel Agitator for 30 gallon mix tanks and 55 gallon drums

REF NO.	PART NO.	DESCRIPTION	QTY
1	206-264	NEEDLE VALVE ASSEMBLY; Includes items 1a-1f	1
1a	166-529	•NEEDLE	1
1b	157-628*	•O-RING; nitrile rubber	1
1c	165-722	•HOUSING, air valve	1
1d	166-531*	•WASHER, friction	1
1e	164-698	•KNOB, adjusting	1
1f	166-532	•NUT, packing	1
6	222-696	GUIDE, agitator	1
7	100-053	SCREW, soc hd cup pt set; 5/16-18 x 1/4	3
8	100-579*	PIN, cotter; 0.11 (2.8 mm) dia; 1" (25 mm) long	1
9	100-633	WRENCH, hex key; 5/16 set screw size (not shown)	1
10	101-248	SCREW, soc hd cup pt set; No.10-24 x 1/2	1
11	101-140	MOTOR, air; 0.5 HP (373 W)	1
12	101-368	CLAMP, hose	2
14	156-969	MUFFLER, air exhaust	1
15	158-865	COUPLER, rubber	1
16	185-398*	PROPELLER; stainless steel	1
17	159-858	COUPLING, steel	1
18	160-023	HOSE, air; cpld 1/8 npt (mbe) swivel one end; 0.25" (6.4 mm) ID; 18"(457 mm) long	1
19	185-401*	PIN, shear	2
20	185-389	SHAFT, agitator	1
21	185-402*	BEARING, PTFE®	1
22	101-369	WRENCH, hex key (not shown)	1

\*Recommended "tool box" spare parts. Keep on hand to reduce down time.

Loctite® is a registered trademark of the Loctite Corp.

## HOW TO ORDER REPLACEMENT PARTS

- To be sure you receive the correct replacement parts, kits or accessories, always give all of the information requested in the chart below.
- Check the parts list to identify the correct part number; do not use the ref. no. when ordering.
- Order all parts from your nearest Graco distributor.

6 digit Part Number	Qty	Part Description

## ACCESSORIES

*Accessories must be purchased separately.*  
Use only **GENUINE GRACO PARTS AND ACCESSORIES.**

### Air Line Filter 106–148

250 psi (17.5 bar) MAXIMUM WORKING PRESSURE  
3/8" npt; without gauge; includes 20 micron element,  
5 oz. bowl

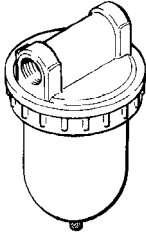

### Air Line Lubricator 214–847

250 psi (17.5 bar) MAXIMUM WORKING PRESSURE  
3/8" npt

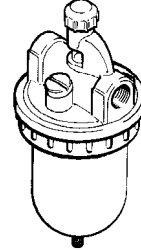

## DIMENSIONAL DRAWING

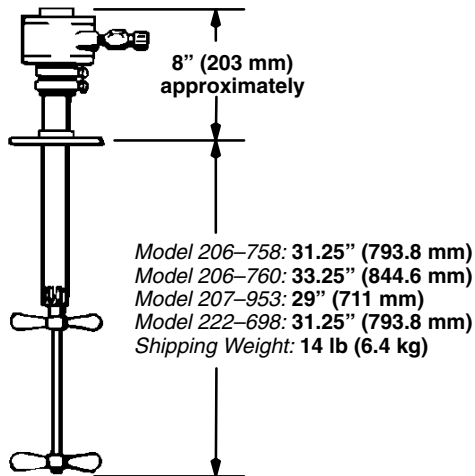

## MOUNTING HOLE DIAGRAM

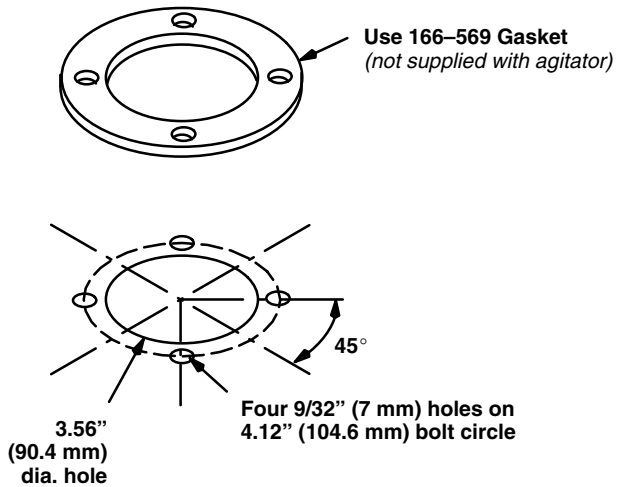



## TECHNICAL DATA

Maximum Working Pressure ..... 100 psi (7 bar)  
 Motor Power Rating  
*Models 206–758, 207–953, 222–698* 1/2 HP (373 W)  
*Model 206–760* ..... 1 HP (746 W)  
 Wetted Parts  
*Models 206–758, 207–953, 206–760* .. Aluminum,  
 PTFE®, Carbon Steel  
*Model 222–698* ..... Stainless Steel,  
 Polyether Ether Ketone  
 Air Consumption ..... See graphs below

PTFE

## SERVICE INFORMATION

ADDED wrench 101–369 to all agitator parts lists.  
 ADDED sealant and torque instructions to the coupling  
 setscrews (item no. 7) on all agitators.

## AIR CONSUMPTION

**NOTE:** Graphed lines show air inlet pressure.

**1/2 HORSEPOWER MOTOR**

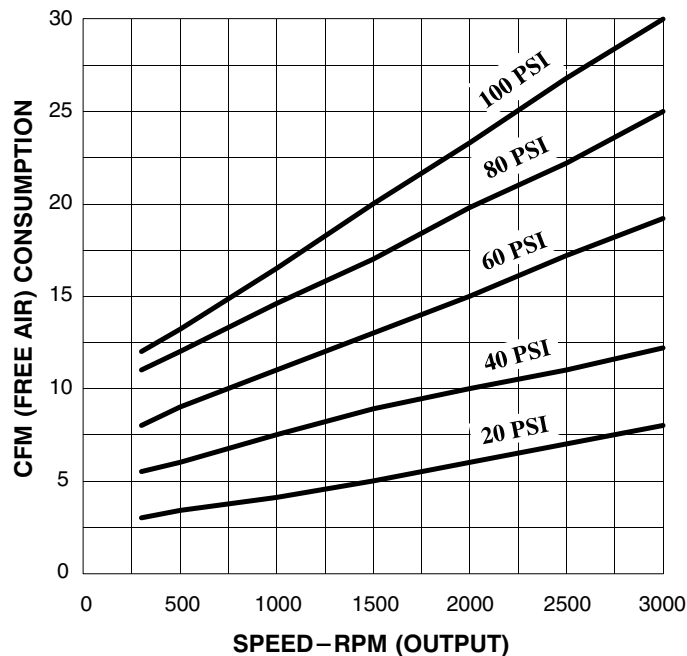

**1 HORSEPOWER MOTOR**

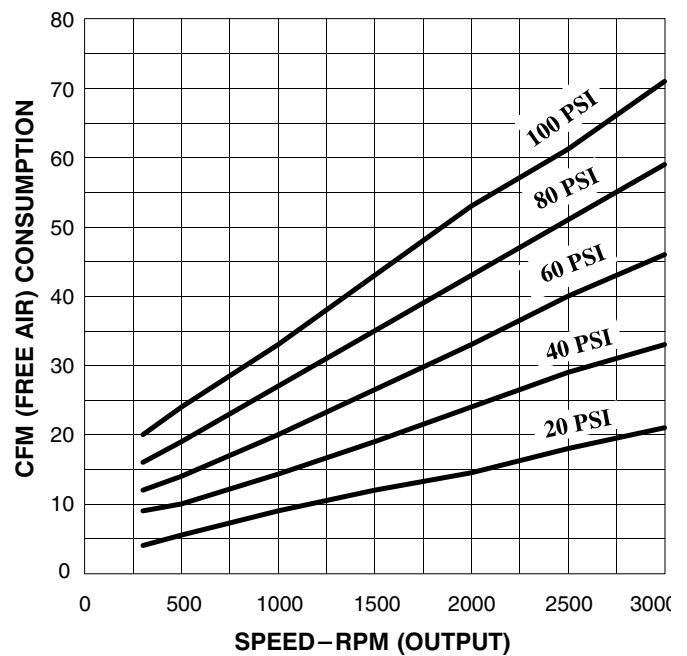

## NOTES

NOTES

[illegible]

# THE GRACO WARRANTY AND DISCLAIMERS

## WARRANTY

Graco warrants all equipment manufactured by it and bearing its name to be free from defects in material and workmanship on the date of sale by an authorized Graco distributor to the original purchaser for use. As purchaser's sole remedy for breach of this warranty, Graco will, for a period of twelve months from the date of sale, repair or replace any part of the equipment proven defective. This warranty applies only when the equipment is installed, operated and maintained in accordance with Graco's written recommendations.

This warranty does not cover, and Graco shall not be liable for, any malfunction, damage or wear caused by faulty installation, misapplication, abrasion, corrosion, inadequate or improper maintenance, negligence, accident, tampering, or substitution of non-Graco component parts. Nor shall Graco be liable for malfunction, damage or wear caused by the incompatibility with Graco equipment of structures, accessories, equipment or materials not supplied by Graco, or the improper design, manufacture, installation, operation or maintenance of structures, accessories, equipment or materials not supplied by Graco.

This warranty is conditioned upon the prepaid return of the equipment claimed to be defective to an authorized Graco distributor for verification of the claimed defect. If the claimed defect is verified, Graco will repair or replace free of charge any defective parts. The equipment will be returned to the original purchaser transportation prepaid. If inspection of the equipment does not disclose any defect in material or workmanship, repairs will be made at a reasonable charge, which charges may include the costs of parts, labor and transportation.

## DISCLAIMERS AND LIMITATIONS

THE TERMS OF THIS WARRANTY CONSTITUTE PURCHASER'S SOLE AND EXCLUSIVE REMEDY AND ARE IN LIEU OF ANY OTHER WARRANTIES (EXPRESS OR IMPLIED), INCLUDING WARRANTY OF MERCHANTABILITY OR WARRANTY OF FITNESS FOR A PARTICULAR PURPOSE, AND OF ANY NON-CONTRACTUAL LIABILITIES, INCLUDING PRODUCT LIABILITIES, BASED ON NEGLIGENCE OR STRICT LIABILITY. EVERY FORM OF LIABILITY FOR DIRECT, SPECIAL OR CONSEQUENTIAL DAMAGES OR LOSS IS EXPRESSLY EXCLUDED AND DENIED. IN NO CASE SHALL GRACO'S LIABILITY EXCEED THE AMOUNT OF THE PURCHASE PRICE. ANY ACTION FOR BREACH OF WARRANTY MUST BE BROUGHT WITHIN TWO (2) YEARS OF THE DATE OF SALE.

## EQUIPMENT NOT COVERED BY GRACO WARRANTY

GRACO MAKES NO WARRANTY, AND DISCLAIMS ALL IMPLIED WARRANTIES OF MERCHANTABILITY AND FITNESS FOR A PARTICULAR PURPOSE, WITH RESPECT TO ACCESSORIES, EQUIPMENT, MATERIALS, OR COMPONENTS SOLD BUT NOT MANUFACTURED BY GRACO. These items sold, but not manufactured by Graco (such as electric motor, switches, hose, etc.) are subject to the warranty, if any, of their manufacturer. Graco will provide purchaser with reasonable assistance in making any claim for breach of these warranties.

### SALES/DISTRIBUTION

Toll Free 800-367-4023  
(In Minnesota 612-623-6743)

*Contact sales personnel  
Locate authorized distributors  
Product information literature*

### TECHNICAL ASSISTANCE

Toll Free 800-543-0339  
(In Minnesota 612-623-6922)

*Product recommendations  
System layout  
Repair advice  
Warranty inquiries*

**Factory Branches:** Atlanta, Chicago, Dallas, Detroit, Los Angeles, West Caldwell (N.J.)

**Subsidiary and Affiliate Companies:** Canada; England; Switzerland; France; Germany; Hong Kong; Japan

**GRACO INC. P.O. BOX 1441 MINNEAPOLIS, MN 55440-1441**

PRINTED IN U.S.A. 306-840 5-64 Revised 11-89