

INSTRUCTIONS-PARTS LIST



307-361
Rev C
Supersedes B

This manual contains **IMPORTANT WARNINGS AND INSTRUCTIONS**
READ AND RETAIN FOR REFERENCE

AIR MOTOR MUFFLERS

FOR MONARK® AND PRESIDENT® AIR MOTORS

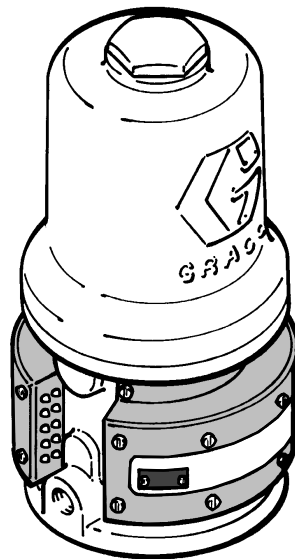

MODEL 215-354
Fits Monark Air Motors
Except Models 205-237, 205-471, and 207-546

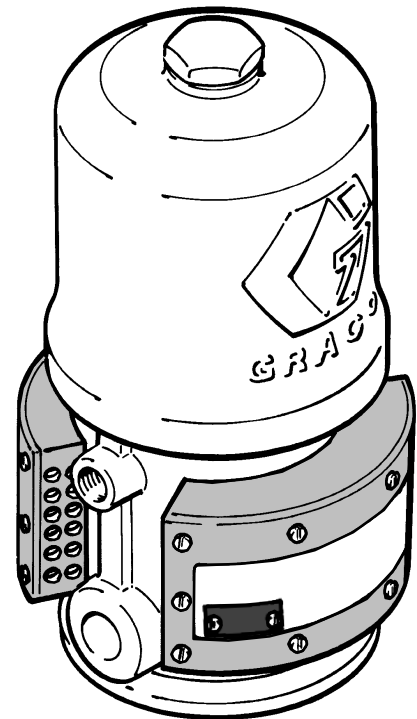

MODEL 214-873, Series A
Fits President Air Motors

IMPORTANT

You cannot order parts or request service and warranty information for the complete pump without the information on the serial plate.

LUFTMOTOR-AIR MOTOR	
Model	
Series	

PART NO.	PUMP	MAX.GPM(I/MIN)
+ MAX AIR PSI (bar) +		
RATIO	SERIES	SERIAL

Record all the information from the air motor and serial plate in these spaces. Keep this manual in a safe place as an extra precaution.

INSTALLATION

WARNING

Pressure Relief Procedure

To reduce the risk of serious bodily injury, including fluid injection, splashing in the eyes or on the skin, or injury from moving parts, ALWAYS follow this procedure whenever you shut off the pump, and before installing, removing, cleaning or servicing any part of your system.

1. Engage the gun's safety latch.
2. Shut off the air to the pump.
3. Close the bleed-type master air valve (required in your system).
4. Disengage the gun safety latch.
5. Hold a metal part of the gun firmly to the side of a

grounded metal pail, and trigger the gun to relieve pressure.

6. Engage the gun safety latch.
7. Open the drain valve, having a container ready to catch the drainage.
8. Leave the drain valve open until you are ready to spray again.

If you suspect that the spray tip or hose is completely clogged, or that pressure has not been fully relieved after following the steps above, VERY SLOWLY loosen the tip guard retaining nut or hose end coupling and relieve pressure gradually, then loosen completely. Now clear the tip or hose.

NOTE: Reference numbers and letters in parentheses in the text refer to Figs. 1 and 2 and the Parts Drawings.

Unscrew the plate retaining screws and remove the identification plate (A) and warning plate (C) from both sides of the air motor. To avoid twisting the screw heads off if the screws are hard to remove, tap lightly on the screw heads with a hammer, then remove them.

Removing the Serial Plate

Using a side cutter, cut off the back of the rivets holding the serial plate (B) to the identification plate (A). Push out the rivets with an awl or similar tool. See Fig. 1.

BE SURE to keep the serial plate and reinstall it on the muffler as described on page 3. You cannot order parts or request service or warranty information without the serial plate information. Record the serial plate (B) and identification plate (A) information on the front of this

manual as an added precaution. Keep the manual in a safe place.

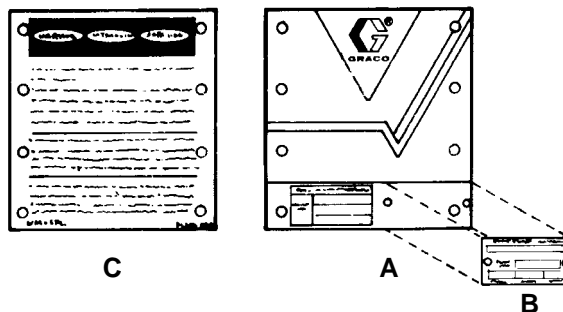
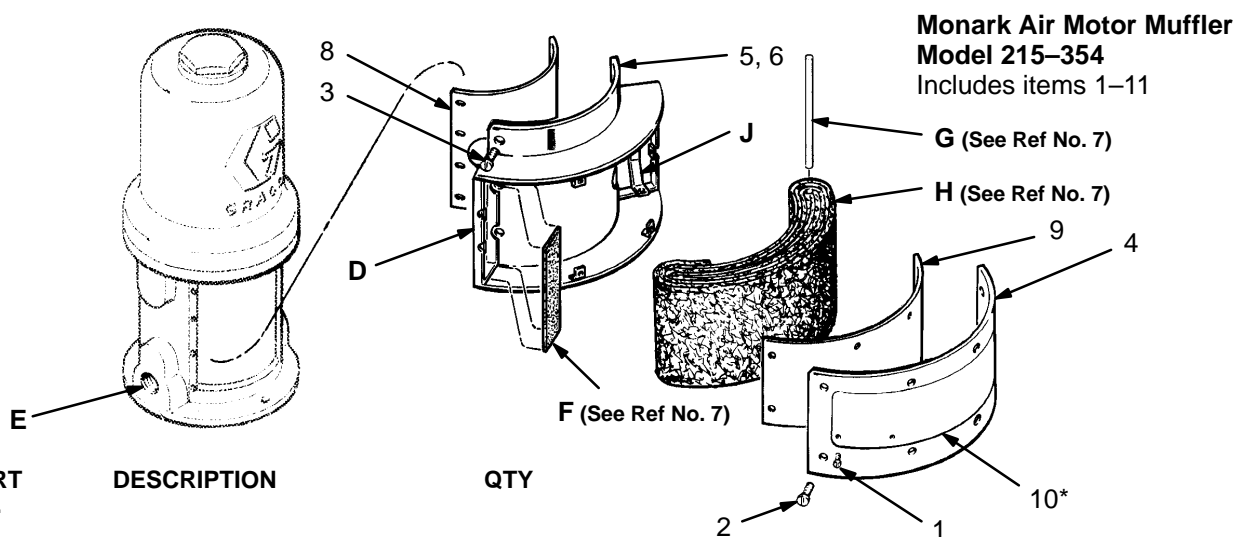

Fig 1

Discard the old identification plate (A) and warning plate (C). The muffler kit includes an identification plate for one side and a warning label (10), in English, for the other side. A warning label (11) in French, German and Spanish is also included with the muffler.

PARTS DRAWING



REF NO.	PART NO.	DESCRIPTION	QTY
1	100-178	SCREW, tapping, pnhd; No. 6 x 0.188" long	2
2	100-264	SCREW, mach, pnhd; 10-24 x 0.312" long	16
3	104-985	SCREW, thd forming	16
4	176-655	SHIELD, muffler	2
5, 6	215-352	BASE, muffler, front and rear	2
7	215-353	MUFFLER PAD KIT Includes bronze muffler, pin, filter	2
2	307-361		

8	176-683	GASKET, base	2
9	176-656	GASKET, shield	2
10	176-665*	LABEL, warning; English	1
11	176-667*	LABEL, warning; Spanish, German, French (not shown)	1

* Extra warning labels are available at no charge. Refer to "How to Order Parts" on the back page.

Install Muffler Base

Install the muffler bases (5, 6) on the air motor with the perforated end flanges (D) facing the fluid outlet (E) of the pump. See the Parts Drawings. Install the screws (3) and tighten them evenly so the muffler fits tightly to the air motor.

NOTE: Install the screws (3) in the inside set of mounting holes on all President muffler bases, except President Air Motor Models 210-007 and 205-038. Use the outside set of mounting holes on the muffler's rear base on these two air motors.

Install the filter (F) on the inside of the perforated end flange (D). See Parts Drawings. With pin (G) inserted in the muffler pad (H) as shown, lay the pad in the muffler base (5 or 6) and snap the pin into the spring clip (J). Bend the clips if necessary to securely hold the pin. Repeat for the other base.

Install Muffler Shields

Place the muffler shields (4) over the bases and secure with the screws (2).

Attach the serial plate (B) to the shield (4) with the screws (1). See Fig 2.

With the air motor operating, check all around the muffler base for air leaks. Adjust the screws (2) if necessary.

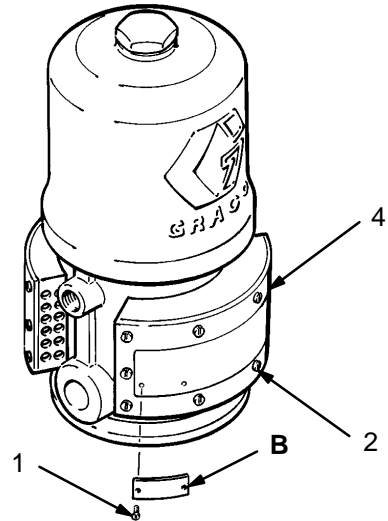
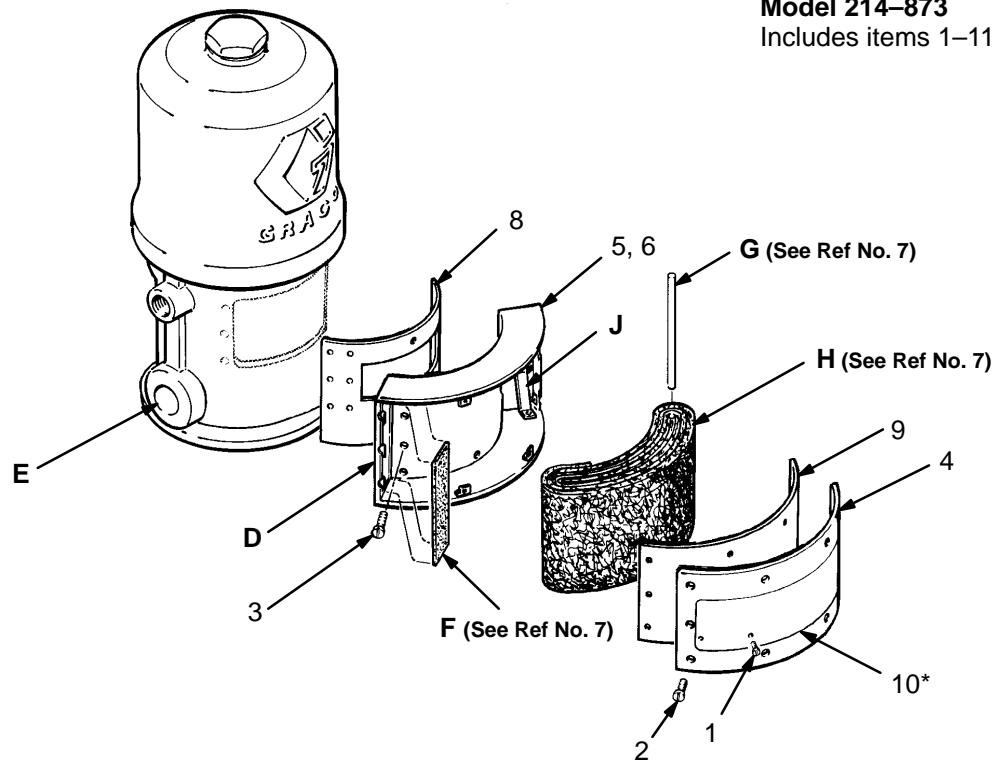

Fig 2

PARTS DRAWING

**President Air Motor Muffler
Model 214-873**
Includes items 1-11



REF NO.	PART NO.	DESCRIPTION	QTY	REF NO.	PART NO.	DESCRIPTION	QTY
1	100-178	SCREW, tapping, pnhd; No. 6 x 0.188" long	2	7	215-374	MUFFLER PAD KIT Includes bronze muffler pad, pin, filter	2
2	100-264	SCREW, mach, pnhd; 10-24 x 0.312" long	20	8	181-076	GASKET, muffler	2
3	104-985	SCREW, thd forming	16	9	176-325	GASKET, muffler	2
4	176-318	SHIELD, muffler	2	10	176-665*	LABEL, warning; English	1
5	218-921	BASE, muffler, front	1	11	176-667*	LABEL, warning; Spanish, German, French (not shown)	1
6	218-920	BASE, muffler, rear	1				

* Extra warning labels are available at no charge.

Refer to "How to Order Parts" on the back page.

HOW TO ORDER PARTS

- 1 To be sure you receive the correct replacement parts, kits or accessories, always give all of the information requested in the chart below.
2. Check the parts list to identify the correct part number; do not use the ref. no. when ordering.
3. Order all parts from your nearest Graco distributor.

6 digit Part Number	Qty	Part Description

SERVICE INFORMATION

The procedure for installing the muffler base has been updated.

THE GRACO WARRANTY AND DISCLAIMERS

WARRANTY

Graco warrants all equipment manufactured by it and bearing its name to be free from defects in material and workmanship on the date of sale by an authorized Graco distributor to the original purchaser for use. As purchaser's sole remedy for breach of this warranty, Graco will, for a period of twelve months from the date of sale, repair or replace any part of the equipment proven defective. This warranty applies only when the equipment is installed, operated and maintained in accordance with Graco's written recommendations.

This warranty does not cover, and Graco shall not be liable for, any malfunction, damage or wear caused by faulty installation, misapplication, abrasion, corrosion, inadequate or improper maintenance, negligence, accident, tampering, or substitution of non-Graco component parts. Nor shall Graco be liable for malfunction, damage or wear caused by the incompatibility with Graco equipment of structures, accessories, equipment or materials not supplied by Graco, or the improper design, manufacture, installation, operation or maintenance of structures, accessories, equipment or materials not supplied by Graco.

This warranty is conditioned upon the prepaid return of the equipment claimed to be defective to an authorized Graco distributor for verification of the claim. If the claimed defect is verified, Graco will repair or replace free of charge any defective parts. The equipment will be returned to the original purchaser transportation prepaid. If inspection of the equipment does not disclose any defect in material or workmanship, repairs will be made at a reasonable charge, which charges may include the costs of parts, labor and transportation.

DISCLAIMERS AND LIMITATIONS

THE TERMS OF THIS WARRANTY CONSTITUTE PURCHASER'S SOLE AND EXCLUSIVE REMEDY AND ARE IN LIEU OF ANY OTHER WARRANTIES (EXPRESS OR IMPLIED), INCLUDING WARRANTY OF MERCHANTABILITY OR WARRANTY OF FITNESS FOR A PARTICULAR PURPOSE, AND OF ANY NON-CONTRACTUAL LIABILITIES, INCLUDING PRODUCT LIABILITIES, BASED ON NEGLIGENCE OR STRICT LIABILITY. EVERY FORM OF LIABILITY FOR DIRECT, SPECIAL OR CONSEQUENTIAL DAMAGES OR LOSS IS EXPRESSLY EXCLUDED AND DENIED. IN NO CASE SHALL GRACO'S LIABILITY EXCEED THE AMOUNT OF THE PURCHASE PRICE. ANY ACTION FOR BREACH OF WARRANTY MUST BE BROUGHT WITHIN TWO (2) YEARS OF THE DATE OF SALE.

EQUIPMENT NOT COVERED BY GRACO WARRANTY

GRACO MAKES NO WARRANTY, AND DISCLAIMS ALL IMPLIED WARRANTIES OF MERCHANTABILITY AND FITNESS FOR A PARTICULAR PURPOSE, WITH RESPECT TO ACCESSORIES, EQUIPMENT, MATERIALS, OR COMPONENTS SOLD BUT NOT MANUFACTURED BY GRACO. These items sold, but not manufactured by Graco (such as electric motor, switches, hose, etc.) are subject to the warranty, if any, of their manufacturer. Graco will provide purchaser with reasonable assistance in making any claim for breach of these warranties.

Factory Branches: Atlanta, Chicago, Dallas, Detroit, Los Angeles, West Caldwell (N.J.)

Subsidiary and Affiliate Companies: Canada; England; Switzerland; France; Germany; Hong Kong; Japan

GRACO INC. P.O. BOX 1441 MINNEAPOLIS, MN 55440-1441

PRINTED IN U.S.A. 307-361 9-79 Revised 9-89