

IM5 Electronics Repair Kit

309456B

ENG

Electronic Lubricant Meters

500 psi (3.4MPa, 34 BAR) Maximum Working Pressure

Part No. 245598

For use with petroleum-based and synthetic oils, antifreeze, and windshield washer fluid only.

Not approved for use in European Explosive Atmospheres.

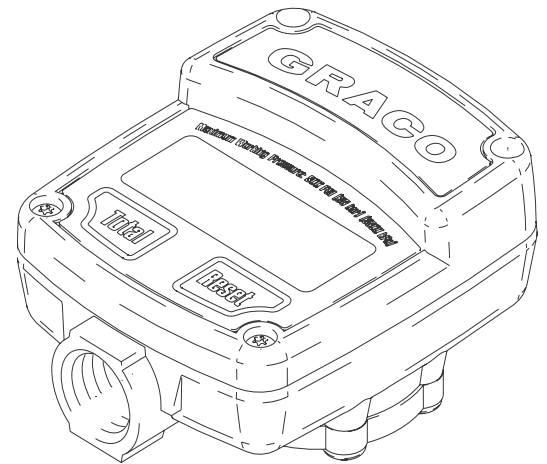

Important Safety Instructions

This manual contains important warnings and information.

READ AND KEEP FOR REFERENCE.

For detailed instructions and warnings see manual 308687.

⚠ WARNING

Pressure Relief Procedure

To reduce the risk of serious bodily injury, including fluid injection or splashing in the eyes or on the skin, always follow this procedure when you shut down the system and before you check or repair the meter or any part of the system.

1. Turn off the power supply to the pump.
2. Trigger the valve into a waste container to relieve pressure.
3. Open any bleed-type master air valves and fluid drain valves in the system.
4. Leave the drain valve open until you are ready to dispense again.

Handle and dispose of a used electronic control properly.

To reduce the risk of a fire, explosion, and serious burns to the body, handle and dispose of a used electronic control properly.

Do not short circuit, charge, force over discharge, disassemble, crush, penetrate, incinerate, or heat the battery to a temperature exceeding 185° F (85° C). Any misuse or abuse of the battery could cause it to leak or explode.

The approvals displayed here apply to electronic lubricant meter 239824 only, not to kit 245598.



3172585
Conforms
to FM 3610
Cert. to CAN/CSA Std. C22.2
No. 157



INTRINSICALLY SAFE
APPARATUS AND ASSOCIATED
APPARATUS FOR USE IN CLASS 1,
DIV. 2, GROUP C, D, T6

Replacing the Electronic Control

NOTICE

To avoid damaging the electronic components of the control:

- **Do not** remove the black cover over the electronic area when you replace the battery. There are no user-replaceable components under this cover.
- Do not lay anything on the electronics.
- Do not twist or force parts. Align parts properly as instructed.

⚠ WARNING

To reduce the risk of a fire, explosion, and serious burns to the body, handle and dispose of a used battery properly.

Do not short circuit, charge, force over discharge, disassemble, crush, penetrate, incinerate, or heat the battery to a temperature exceeding 185° F (85° C). Any misuse or abuse of the battery may cause it to leak or explode.

⚠ WARNING

To avoid malfunction or high-pressure fluid spray, do not remove the metal cover of the metering unit. There are no user-serviceable parts inside.

⚠ WARNING



FIRE AND EXPLOSION HAZARD

Only remove or replace the battery in a non-hazardous location, away from flammable fluids or fumes.

You must use of the following battery types:

- Duracell® MN1604, PC1604
- Eveready® EN22, 522

Use of any batteries other than those specified could affect the intrinsic safety of this unit.

1. Relieve the pressure.

⚠ WARNING

To reduce the risk of serious injury, when you are instructed to relieve pressure, always follow the **Pressure Relief Procedure** on page 1 (front cover).

2. Remove the four screws (3) holding the electronic control (1) and the metering unit (4) together as shown in Fig. 1.
3. Remove battery. See manual 308687 for complete warnings and instructions for removing and replacing battery.
4. Remove all gasket material from metering unit (4).
5. Assemble adhesive side of new gasket (2) to metering unit (4).
6. Replace battery. Install the electronic control (1) to the metering unit (4), aligning the longer screw boss on the meter housing with the counterbore in the plastic housing.
Note: Installing a new battery at this time is recommended.
7. Install the four screws (3) holding the electronic control (1) and the metering unit (4) together. Torque the screws to 15 to 20 in-lb (1.7 to 2.3 N-m) or until no gap exists between the electronic control and the metering unit.

NOTICE

Closing the gap between the electronic control and the metering unit is very important; it ensures that no moisture can enter the electronics.

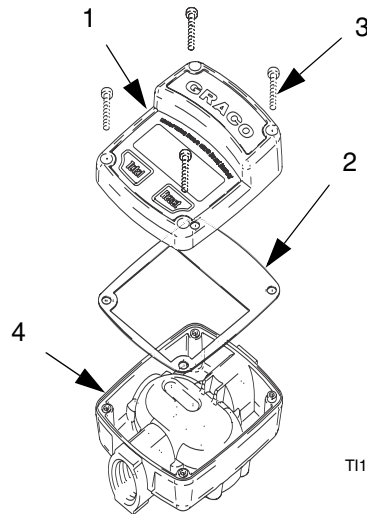

T11706A

Fig. 1

All written and visual data contained in this document reflects the latest product information available at the time of publication. Graco reserves the right to make changes at any time without notice.

Original instructions. This manual contains English. MM 309456

Graco Headquarters: Minneapolis

International Offices: Belgium, China, Japan, Korea

GRACO INC. P.O. BOX 1441 MINNEAPOLIS, MN 55440-1441

Copyright 2001, Graco Inc. is registered to ISO 9001

For the latest information about Graco products, visit www.graco.com

Revised 02/2010