

Paket GH833 OEM

311526A

- Koristite s arhitektonskim premazima, bojama, krovnim premazima i premazima za ravnanje -

Dio br. 249767, 253473

Maksimalni radni pritisak 27,6 MPa, 275,8 bara (4000 psi)



Važne sigurnosne upute

Pročitajte sva upozorenja i upute sadržane u ovom priručniku. Čuvajte ovaj priručnik.

Tehnički podaci

Omjer boja/hidraulika	1,45:1
Podaci korisnika	
• Maksimalni hidraulički pritisak	19,0 MPa, 190 bara (2750 psi)
• Potrebni hidraulički tijek	23,6 l/m
Izlaz uređaja	
• Maksimalni pritisak tekućine	27,6 MPa, 275 bara (4000 psi)
• Maksimalni tijek	15,1 l/m
Maksimalna vrijednost ciklusa	64 ciklusa u minuti
Dimenzije	
Visina	1003 mm
Širina	190,5 mm
Dubina	140 mm
Težina	28,6 kg

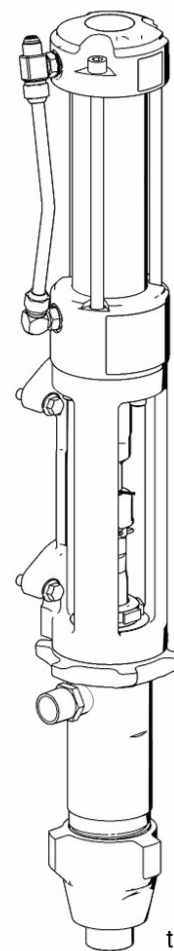

ti7580a

PROVEN QUALITY. LEADING TECHNOLOGY.

Dijelovi

FN	Part No.	Description	Qty	FN	Part No.	Description	Qty
				106	117609	FITTING, tee, branch, str thd	1
7	120226	SCREW, hex hd, flange	4	121	116407	CLIP, hairpin	1
36	287834	KIT, pump, displacement, includes 141	1	122	15G204	NUT, retaining	1
40	116554	WASHER, flat	1	124	197340	COVER, coupler	1
42	15G501	SLEEVE, valve, hydr, motor	1	125	244819	COUPLING, assembly	1
43	15G503	STOP, valve, hydraulic motor	1	141	15H335	FITTING, nipple, 1 in. npt, includes 36	1
44	15D256	SCREW, cap, sch	2	169▲	15G877	LABEL, front	1
45	101947	BALL, bearing	2	170	15G878	LABEL, Graco logo	1
46	15G270	YOKE, arm, hydraulic motor	2	175▲	15B063	LABEL, includes 75	1
48	105270	SCREW, shoulder, sch	4	163‡	15H201	SHIELD, pump	1
52	287869	CYLINDER, hydraulic motor	1	164‡	111235	SCREW, mach, pnh	1
53	287870	KIT, piston, includes 62	1	165‡	120317	NUT, wing	1
53a		BEARING, piston	1				
53b		O-RING, piston	1				
53c		SEAL, piston, hydraulic motor	1				
59	287870	KIT, rod	1				
59a		SEAL, rod	1				
59b		BEARING, rod	1				
59c		WIPER, rod	1				
62	116084	PACKING, o-ring	2				
63	15G559	HOUSING, hydraulic motor, lower	1				
66	101970	PLUG, pipe	1				
73	15G639	ADAPTER, hydraulic motor/pump	1				
74	120202	SCREW, cap sch	3				
75	288061	CAP, hydraulic head, includes 175	1				
76	287868	PISTON, hydraulic	1				
90	120138	SCREW, cap, socket head	3				
91	120146	SPRING, compression	1				
97	287841	TUBE	1				
104	120065	FITTING, hydraulic	1				
105	117607	FITTING, elbow std thd	1				

▲ Zamjenske naljepnice i kartice za opasnost i upozorenje možete dobiti bez naknade.

‡ Koristi se na modelu 253473.

Jedinica Opis

- ① HIDRAULIČKI ULAZ, 19,05 mm - 16 UNF 2A, 37° muški zvonasti
- ② HIDRAULIČKI POVRAT, 28,58 mm - 12 UN 2A, 37° muški zvonasti
- ③ PROREZ ZA UČVRŠĆENJE, 4X, 11,11 mm - 14 UNC 2B, prirubna glava, glavati vijak, preporučena duljina 44,45 mm (Graco broj dijela 120226)
- ④ 25,4 mm - 11-1/2 NPT ženski
- ⑤ 38,1 mm - 11-1/2 NPT muški

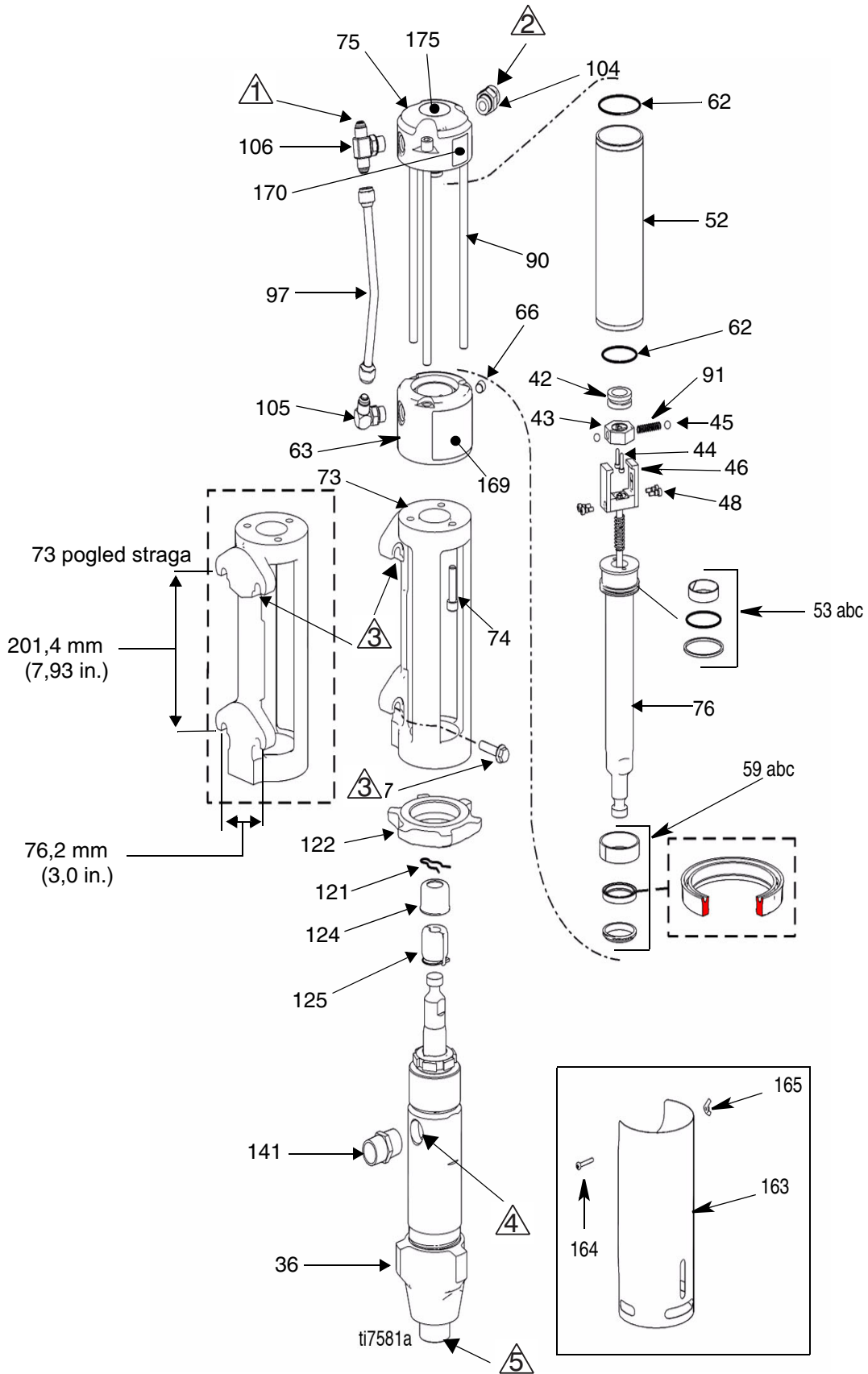

*All written and visual data contained in this document reflects the latest product information available at the time of publication.
Graco reserves the right to make changes at any time without notice.*

Graco Headquarters: Minneapolis

International Offices: Belgium, China, Japan, Korea

GRACO INC. P.O. BOX 1441 MINNEAPOLIS, MN 55440-1441

www.graco.com

Printed in USA 4/2006