

Matrix[®] 5 or Matrix[®] 15 Meter Oil Bar

313013E
EN

- For fixed mounting of Matrix Meters -

Model No.: 255370 - Configures Matrix 5 or Matrix 15 Meters for Oil Bar Installation

Model No.: 256719 - Oil Dispenser Bar

Model No.: 257556 - Front Panel Kit



Important Safety Instructions

Read all warnings and instructions in this manual and the Matrix meter instruction manual 313046. Save these instructions.

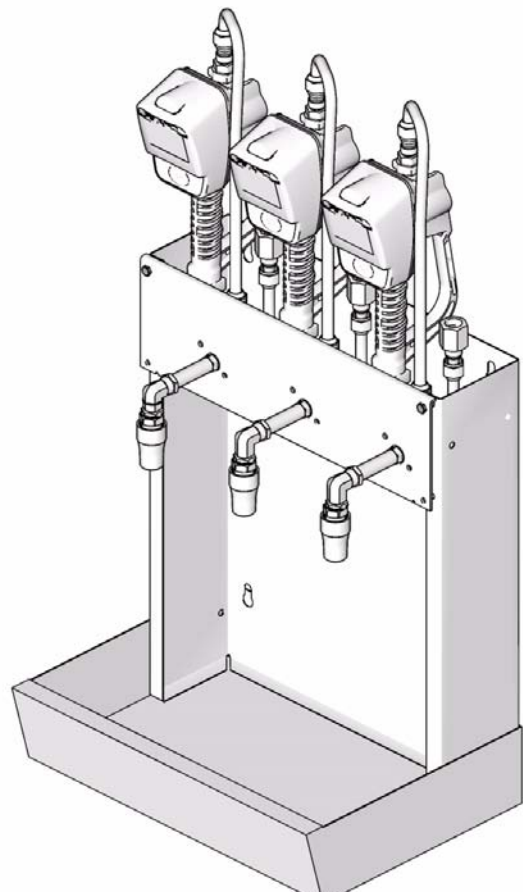

Installation Instructions

The following Steps 1- 10 are for first time installations only. Refer to Parts, pages 9 and 10 for reference numbers included with these instructions.

Front Panel Kit 257556 Installations Only.

NOTE: If you are using Oil Dispenser Bar Kit 256719, skip step 1.

1. To retrofit an existing oil bar to accommodate Matrix meters, install spacers (201) between oil bar (A) and front panel (203) (FIG. 1).

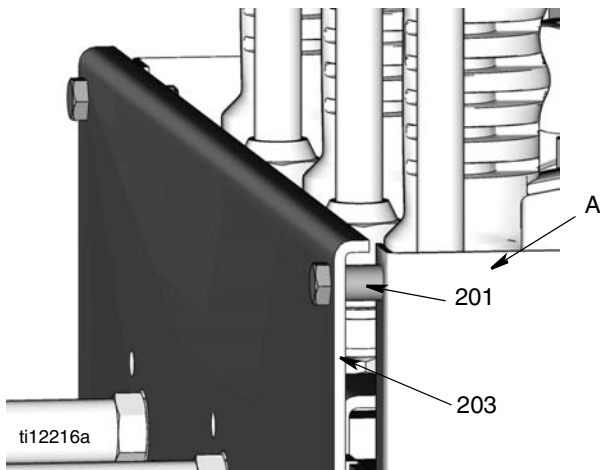

FIG. 1

All Matrix Meters except Matrix 15 Model: 257539.

NOTE: For Matrix 15 Meter 257539, skip step 2.

2. Remove swivel (a), spacer (b) and o-ring (C) from meter (FIG. 2). Reinstall spacer (b).

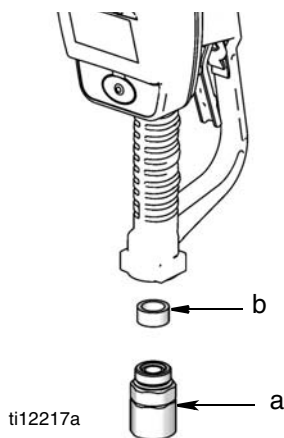

FIG. 2

All Matrix Meters and Oil Bar Installations

3. Install o-ring (16) on bulk head fitting (3) as shown in FIG. 3.

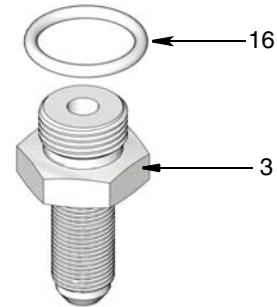

FIG. 3

4. Secure meter in a vise (FIG. 4).

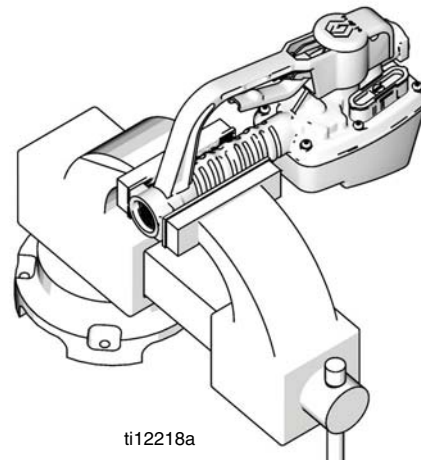

FIG. 4

5. Install bulk head fitting (3) in meter inlet (FIG. 5). Use wrench to snug fitting.

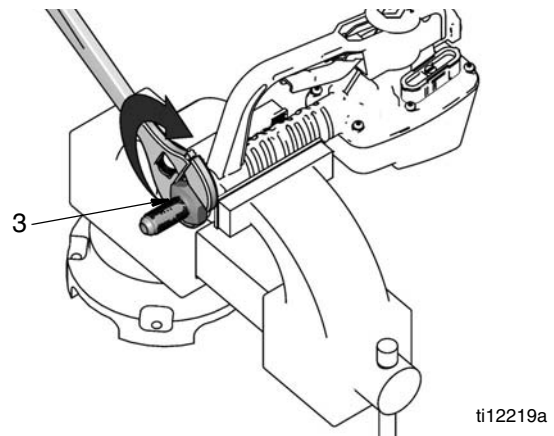

FIG. 5

6. Install fitting (4) in meter outlet (FIG. 6). Snug fitting with a wrench.

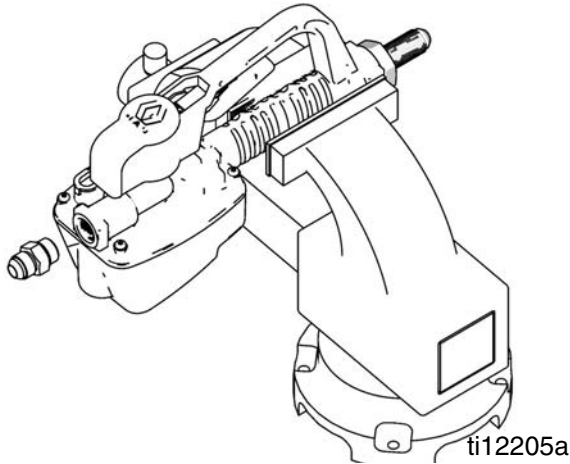

FIG. 6

7. Install bracket (8) over threads of bulk head fitting (3). Refer to FIG. 7 for proper alignment of bracket to meter. Also, following the procedure outlined in steps a - b (below) will help you align the bracket correctly.

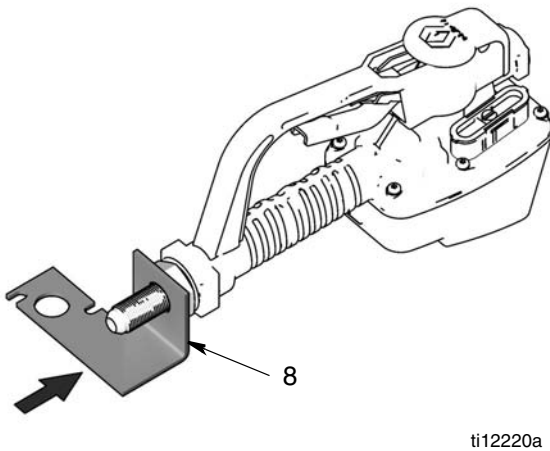

FIG. 7



Front of bracket must be parallel to the front of the meter.

- a. Remove meter from vise and place it face down on a padded surface so the bracket is square to the table top as shown in FIG. 7.
- b. Align bracket (8) with meter, making sure the bracket is parallel to the front of the meter and

correctly oriented for installation in the oil bar as shown in FIG. 7.

- c. Install nut (11) (FIG. 8). Finger tighten.

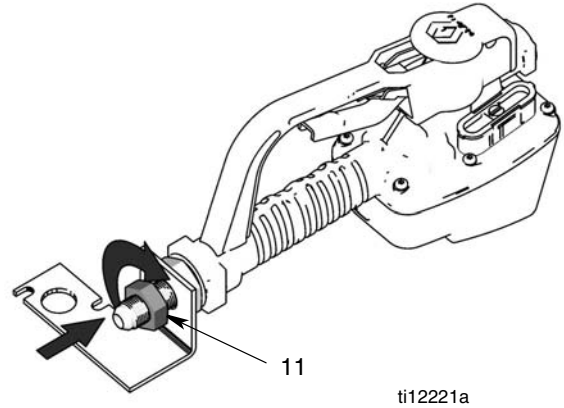

FIG. 8

- d. Return meter to vise. Use a wrench to tighten nut (11) (FIG. 9).

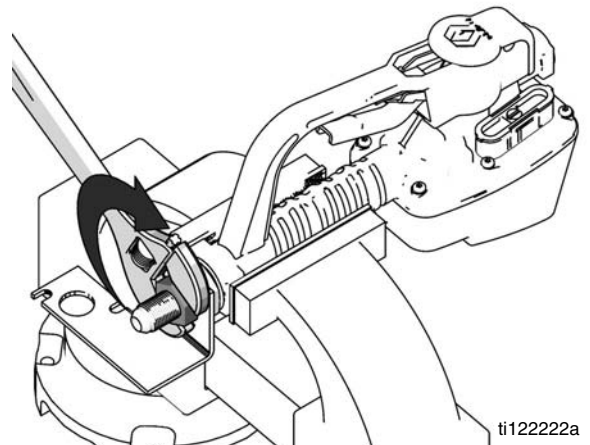

FIG. 9

8. Remove meter from vise and lay it face down on padded surface.

9. Install fluid inlet tube (1) at a 45° angle to meter as shown in FIG. 10.

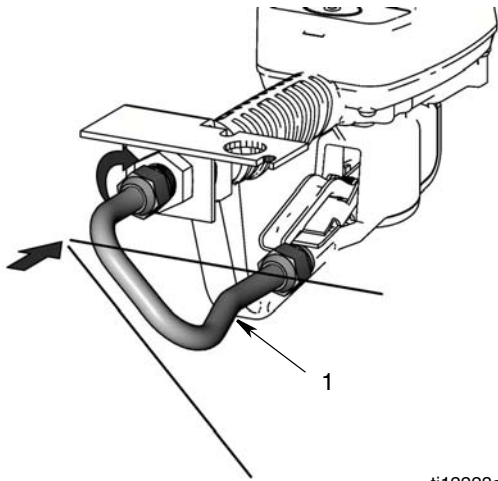



FIG. 10

10. Use a wrench to tighten fitting. Be careful while tightening fitting that the tube does not move out of position.

Installing Meter in Oil Bar

 When installing more than one meter in the Oil Bar, always install meters from left to right.

1. Install adapter fitting (5) in opening (a) of manifold (14). Tighten securely. Refer to FIG. 11 to determine correct installation position.

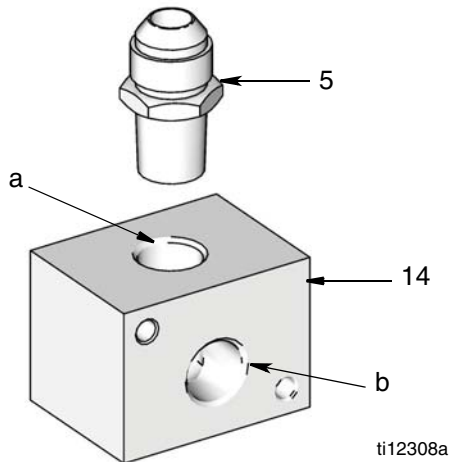

FIG. 11

2. Position manifold (14) inside oil bar, orienting opening (b) on the front of the manifold with the opening (c) in the front panel (107) as shown in FIG. 12.

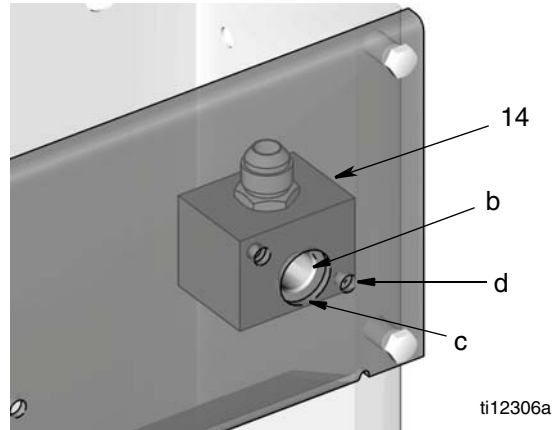

FIG. 12

3. First, only install **lower** front screw (12) and washer (9) in opening (d) to loosely secure manifold to front panel. (Refer to FIG. 12 and FIG. 13.) **Do not snug or tighten the screw securely.** Only turn it until threads are engaged enough to hold the manifold in place.

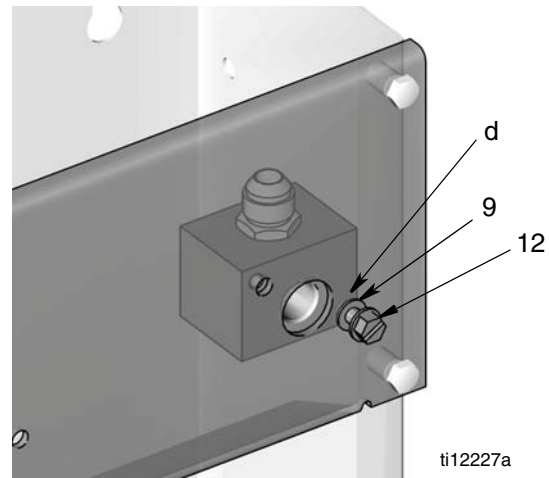

FIG. 13

4. Install meter *in* oil bar housing.

Bracket (8) should fit between manifold (14) and the front panel (107) and notch (e) fits over threads on screw (12) (installed in Step 3) (See FIG. 14).

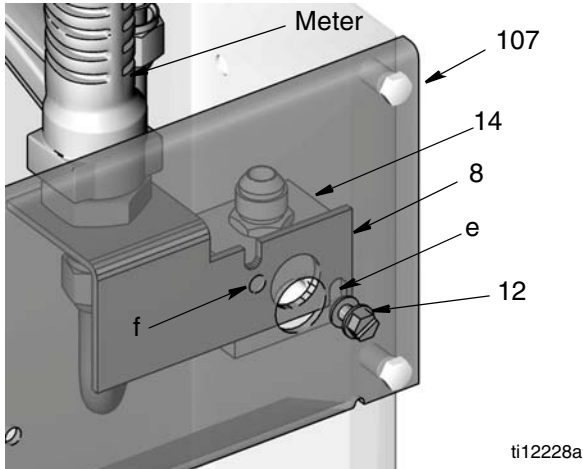

FIG. 14

5. Install washer (9) and screw (12) in opening (f) (FIG. 14 and FIG. 15). Tighten securely.

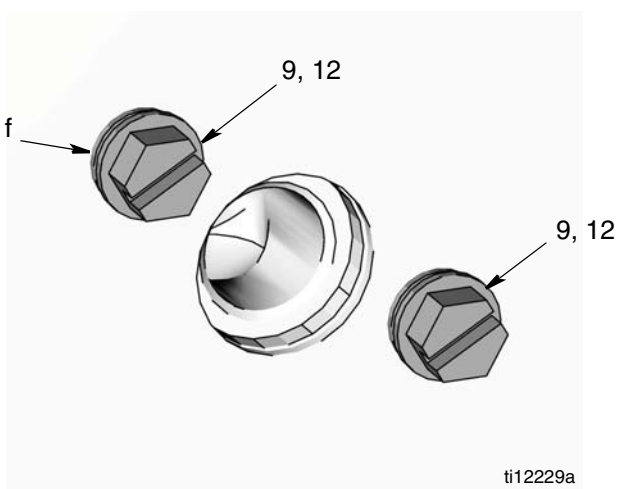

FIG. 15

6. Attach fluid outlet tube (2) to fitting adapter (5) on manifold (14) and fluid outlet fitting (4) (FIG. 16). Finger tighten both fittings until they are securely attached. Then use a wrench to snugly tighten each fitting.

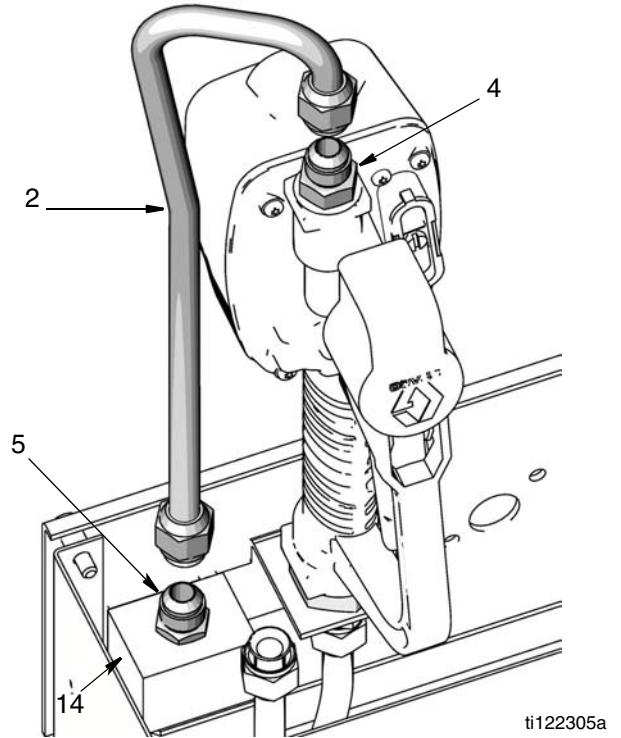

FIG. 16

7. Attach fluid inlet tube (1) to fluid inlet fitting (7) (FIG. 17). Tighten securely.

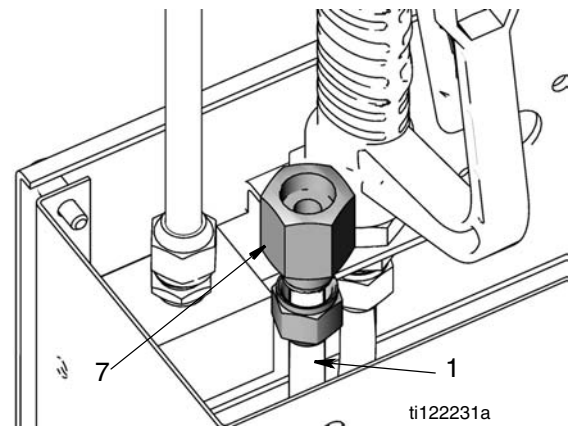

FIG. 17

8. Wrap threads of nipple adapter (13) with PTFE tape.

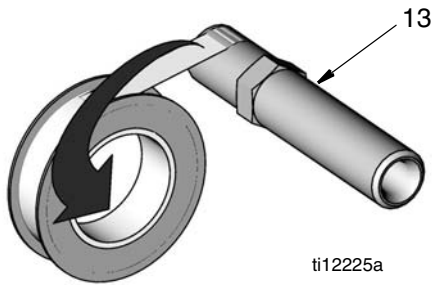

FIG. 18

9. Install nipple adapter (13) to manifold (14) through large hole in front panel (107) (FIG. 19).

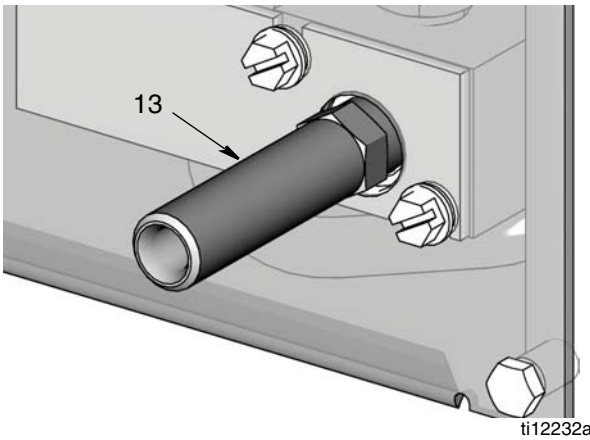

FIG. 19

10. Install swivel elbow (6) and high flow nozzle (15) to nipple adapter (13). Tighten securely.

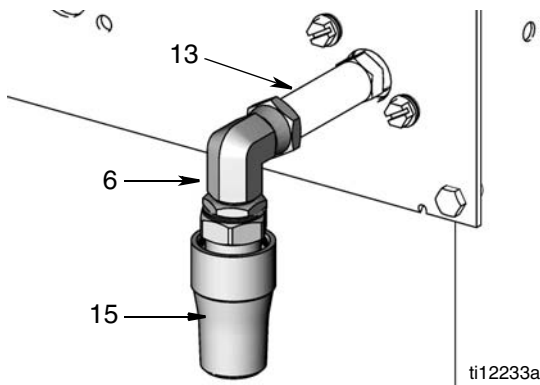

FIG. 20

Battery Replacement

- If you cannot remove the battery cover from the meter following this battery replacement procedure, you will have to completely remove the meter from the oil bar to replace the batteries.
- When replacing batteries, always replace **all** batteries in the meter using four new batteries. Do not mix old, used batteries with new batteries.

1. Use an angled screwdriver (as shown in FIG. 21) or a thin coin to turn cover screw clockwise approximately 1/4 turn. This will sufficiently loosen the screw that is securing battery compartment cover to remove cover. (You do not need to completely remove screw; just loosen it enough to release cover.)

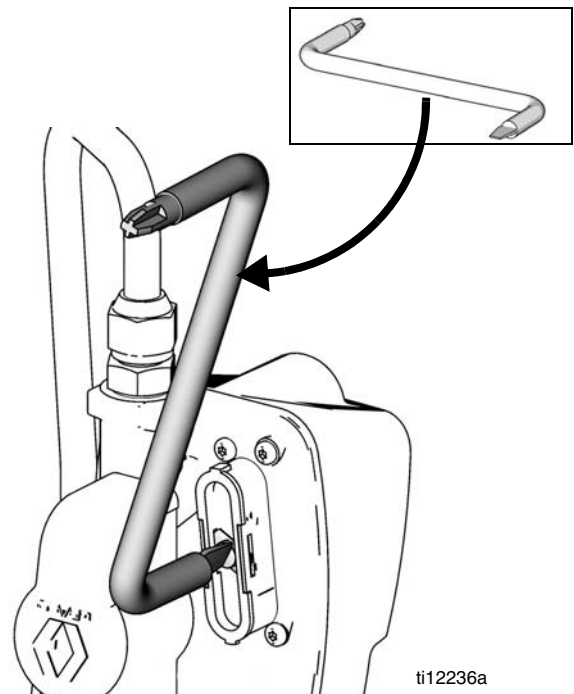

FIG. 21

2. Install **four NEW** batteries. Refer to FIG. 22 for proper battery orientation in meter. Be sure they are installed correctly or the meter will not function.

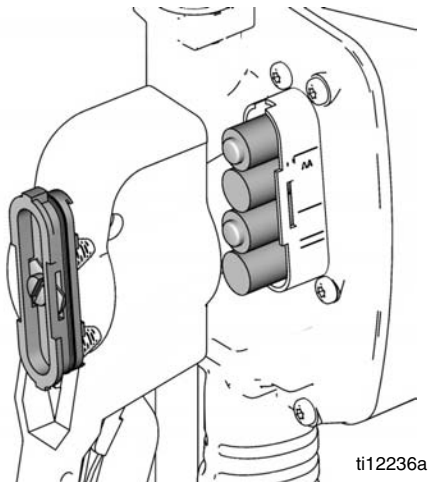

FIG. 22

3. Replace cover. Use your thumb or finger to push cover tightly down over batteries.
4. Use an angled screw driver or small coin to turn screw counter-clockwise about 1/4 turn to fasten cover in place.

Oil Bar Disassembly

When you need to perform maintenance or repair work on a meter, follow this procedure to disassemble the oil bar.

1. **Relieve pressure** following the Pressure Relief procedure described in the Matrix meter instruction manual.

2. Place a container under the drain valve. Pull meter trigger to dispense as much of the fluid remaining in the line as possible.

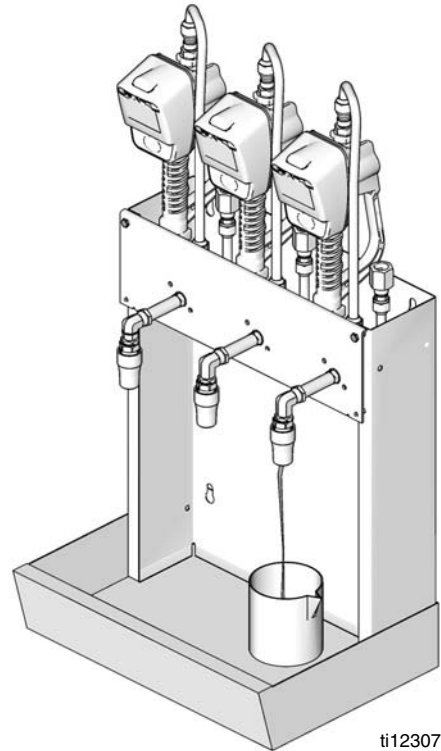

FIG. 23

3. Disconnect fluid inlet tube (1) from fluid inlet fitting (7) (FIG. 24).

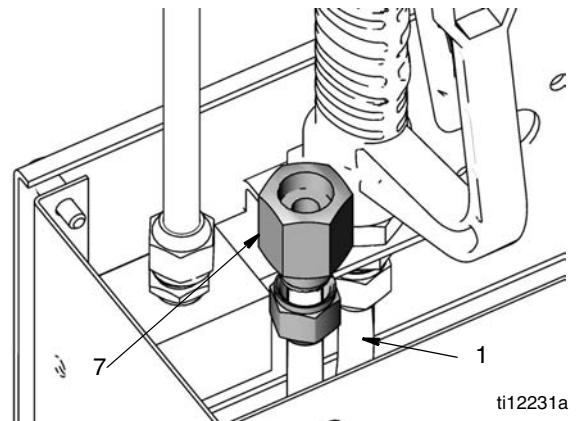

FIG. 24

- Disconnect fluid outlet tube (2) at both meter adapter (4) and manifold fitting (5). Place a rag under the tube to catch any drops of oil that may still be in the tube and drip out.

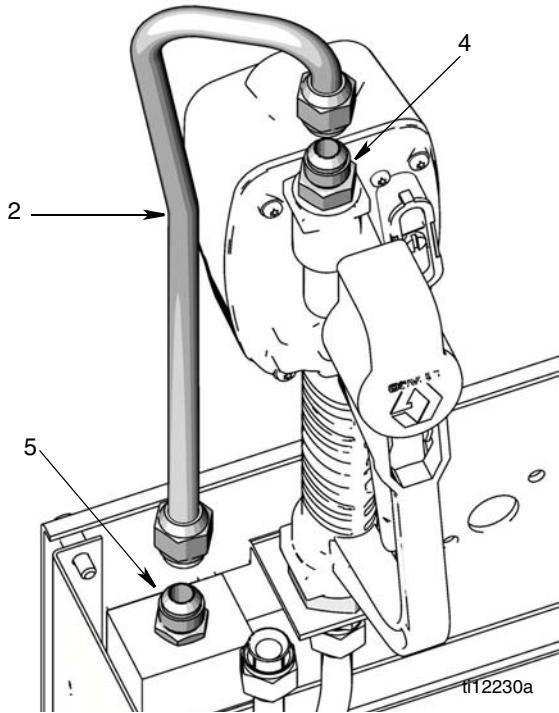

FIG. 25

- Unscrew nipple adapter (13), elbow (6) and swivel nozzle (15) assembly and remove assembly from manifold (14) (FIG. 26).

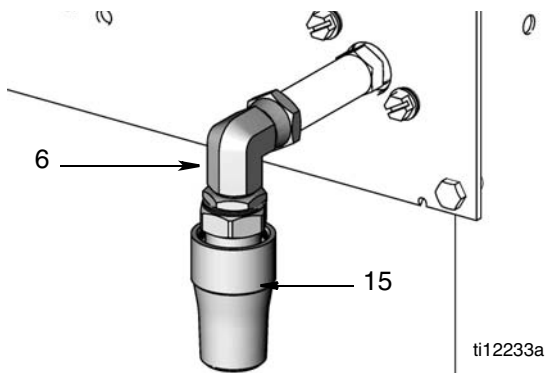

FIG. 26

- Only remove top screw (12) and washer (9) (FIG. 27).

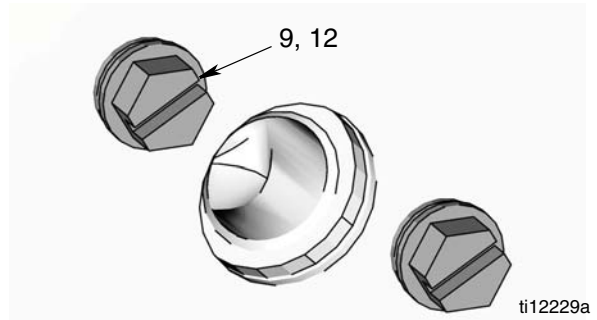

FIG. 27

- Loosen, but do not remove, bottom screw (12).
- Lift meter straight up and out of oil bar housing. (FIG. 28).

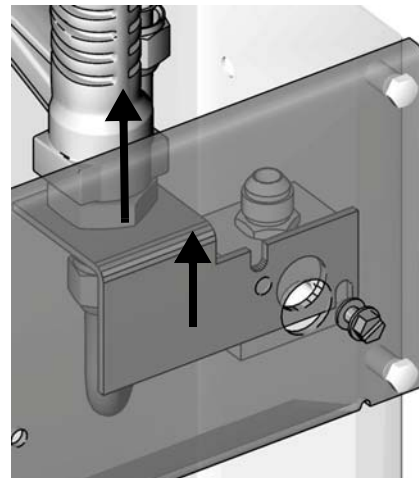

FIG. 28

- To protect meter, lay it face down on a padded surface while performing any maintenance or service work on the meter or oil bar.
- Follow **Installing Meter in Oil Bar** instructions beginning on page 4 for reassembly instructions.

Parts

Meter Kit: 255370

Ref	Part	Description	Qty
1	121074	TUBE, inlet	1
2	121075	TUBE, outlet	1
3	121076	FITTING, bulkhead	1
4	121077	FITTING, 37 flare x orb	1
5	121078	FITTING, adapter, 37 flare x npt	1
6	121079	SWIVEL, elbow orb x npsm	1
7	121080	ADAPTER, 37 flare x npt	1
8	121081	BRACKET, mounting	1
9	100016	WASHER, lock	2
11	100071	NUT, hex	1
12	108296	SCREW, mach,hex washer hd	2
13	160790	NIPPLE, adapter	1
14	181317	MANIFOLD, dispenser	1
15	255461	NOZZLE, high flow	1
16	105765	O-RING	1

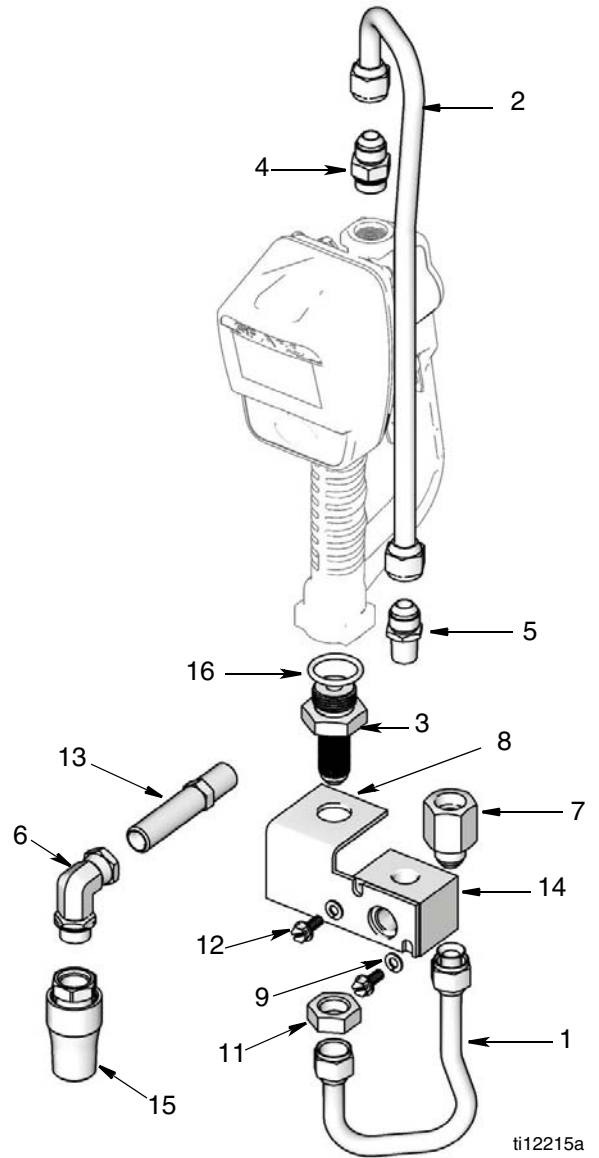

Dispense Bar Kit: 256719

FN	Part No.	Description	Qty
101	100015	NUT, hex	16
102	100016	WASHER, lock	16
103	104663	PLUG, pipe	1
104	108296	SCREW, mach, hex washer	16
105	159346	WASHER	6
107	121082	PANEL, front	1
108	15V705	WRAPPER, dispenser	1
109	181319	STRAINER, pan	1
110	16D537	PAN, drain	1

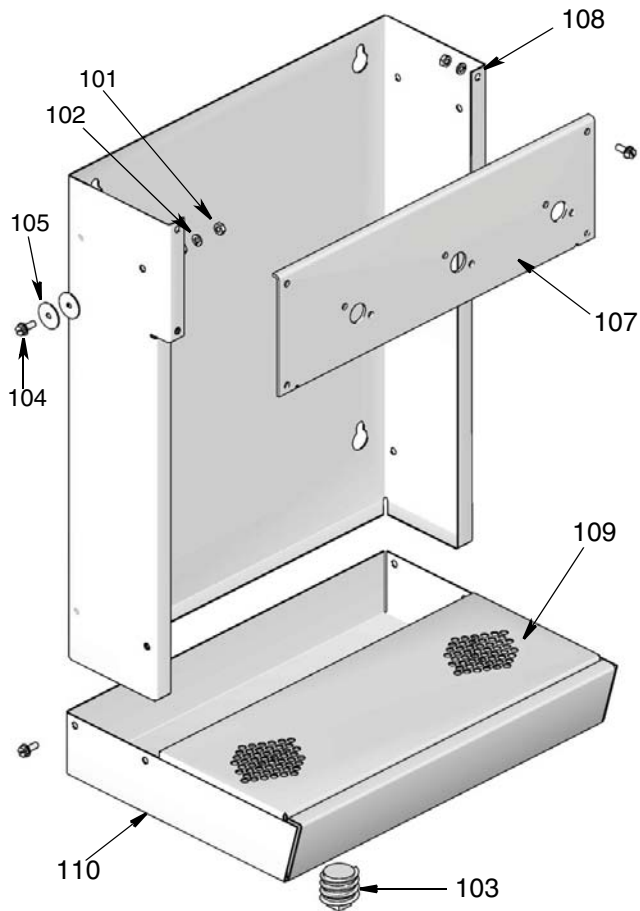

Front Panel Kit : 257556

FN	Part No.	Description	Qty
201	15U916	SPACER	4
202	100021	SCREW, cap hex hd	4
203	121082	PANEL, front	1

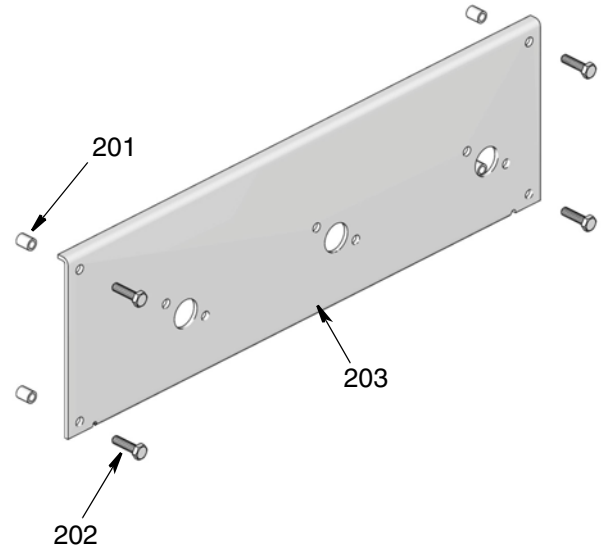

All written and visual data contained in this document reflects the latest product information available at the time of publication. Graco reserves the right to make changes at any time without notice.

For patent information, see www.graco.com/patents.

Original instructions. This manual contains English. MM 313013

Graco Headquarters: Minneapolis
International Offices: Belgium, China, Japan, Korea

GRACO INC. AND SUBSIDIARIES • P.O. BOX 1441 • MINNEAPOLIS MN 55440-1441 • USA

Copyright 2008, Graco Inc. All Graco manufacturing locations are registered to ISO 9001.

www.graco.com
 Revised July 2012