

AIRLESSCO 6000G Lo-Boy Supplement

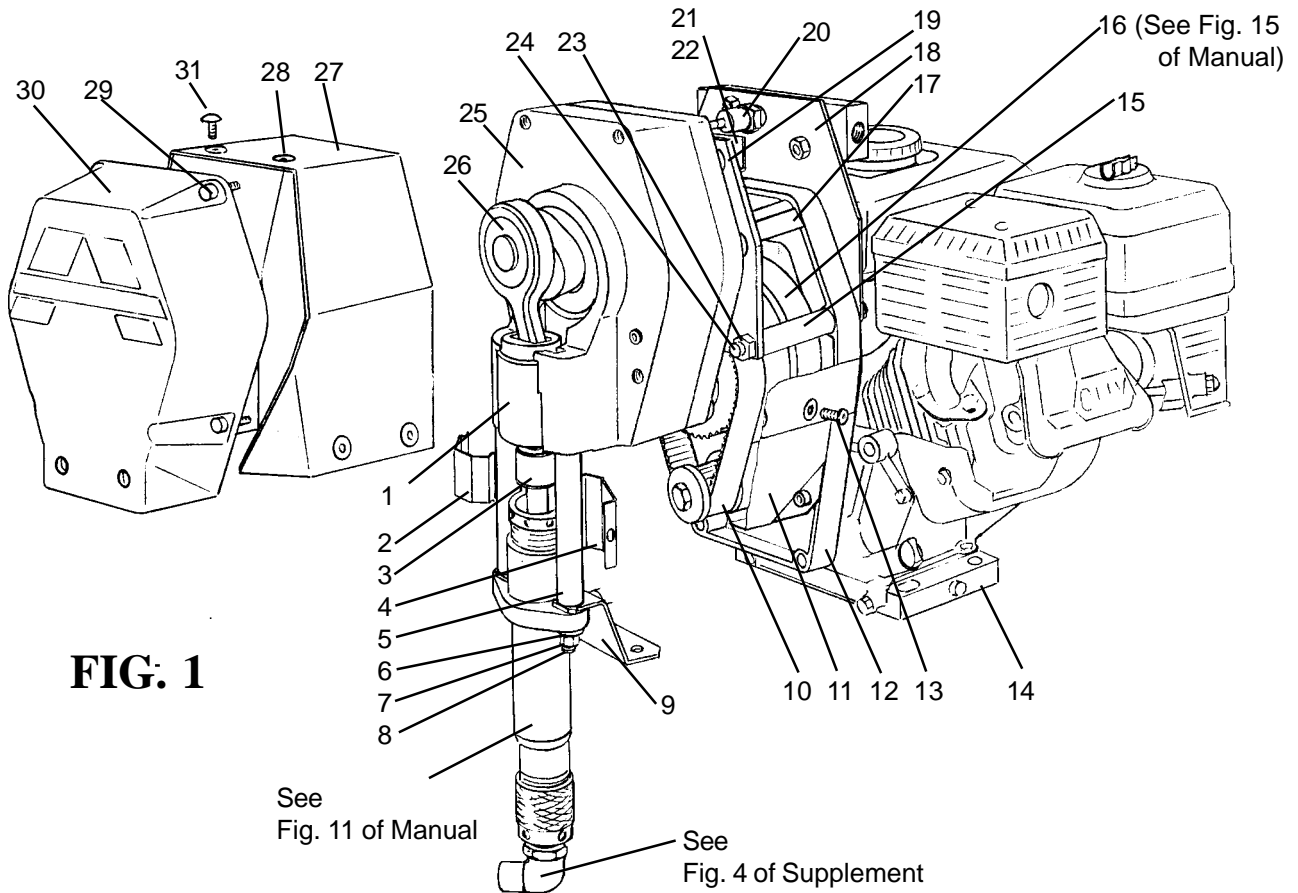

FIG. 1 PARTS LIST, POWER UNIT ASSEMBLY, PN 305-010

Item No.	Part No.	Description	Item No.	Part No.	Description
1	301-047	Sleeve Bearing	17	301-529	Cover
2	301-189	Shield Front	18	305-064	Holder-Manifold
3	189-046A	Coupling Set Ass'y	19	305-045	Plate - Gearbox Mount
4	301-092	Shield - Rear	20	331-294	Sensor Ass'y
5	301-048	Spacer - Tube (2)	21	301-282	Pressure Control
6	140-035	Washer, Lock (2)	22	301-523A	Knob Ass'y
7	140-051	Nut (2)	23	140-044	Nut (8)
8	100-328	Stud (2)	24	305-047	Screw (4)
9	305-013	Holder	25	301-270	Gearbox
10	301-231	Cog Belt	26	301-291	Connecting Rod Ass'y
11	305-067	Cover-Bottom	27	305-066	Cover Top
12	305-012	Adaptor	28	301-135	Grommet (6)
13	100-339	Screw (4)	29	100-312	Screw (4)
14	301-524	5.5 HP Engine Ass'y	30	301-022	Cover -Gearbox
15	305-046	Spacer Tube (4)	31	301-337	Screw (2)
16	301-284	Clutch Ass'y			

PAINT SYSTEM ASSEMBLY

FIG. 2

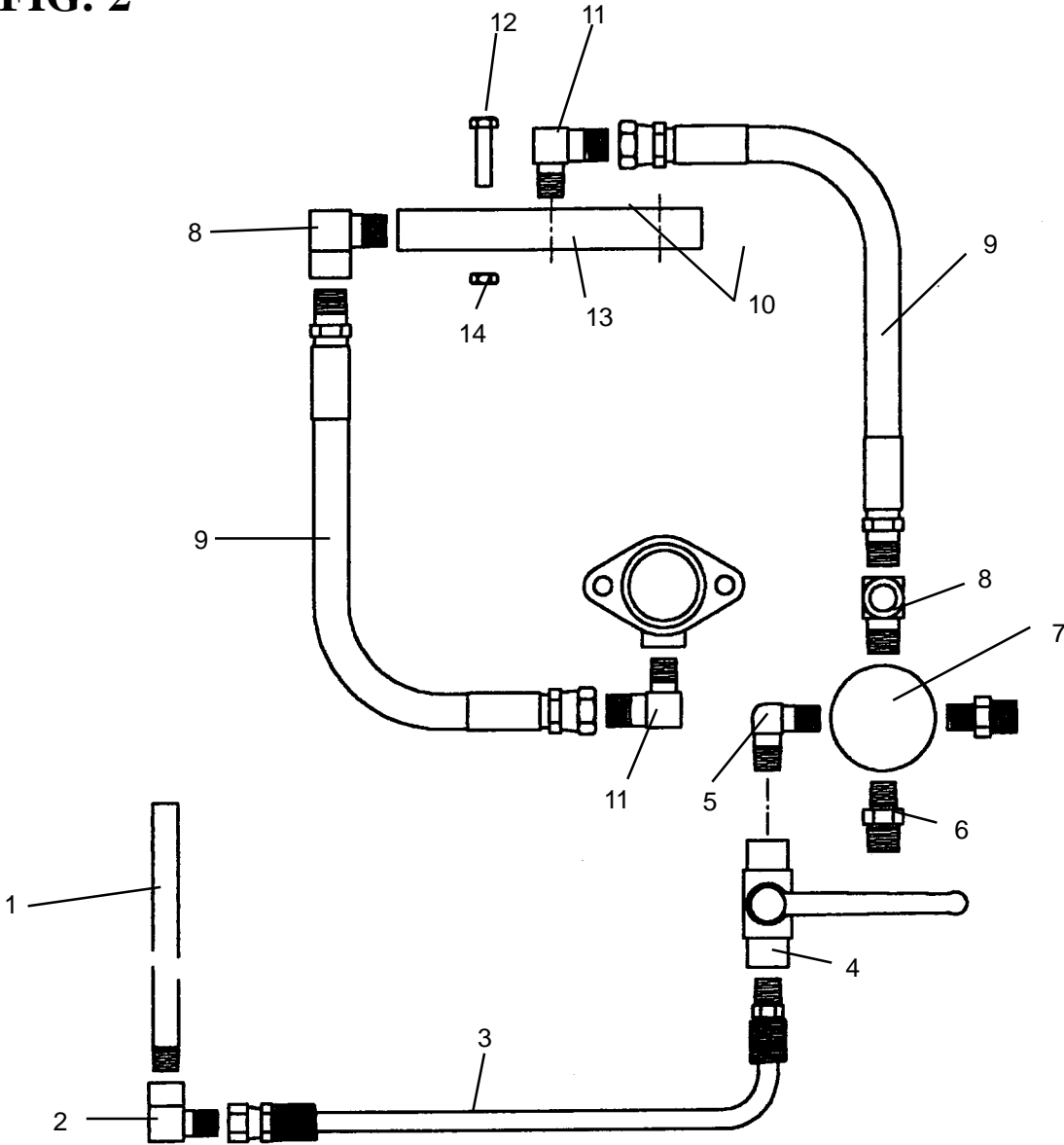
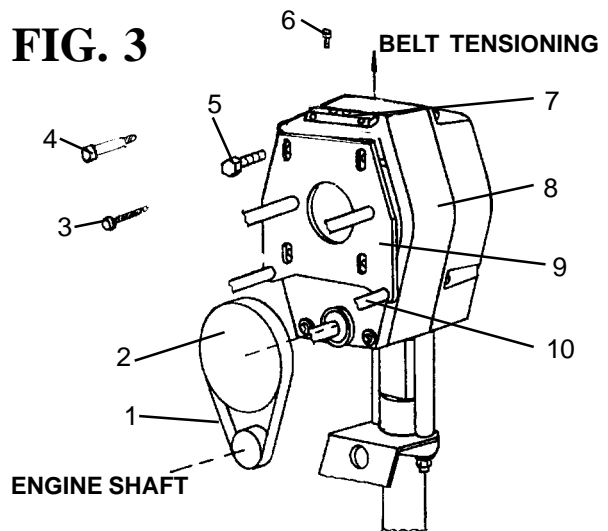

FIG. 2 PARTS LIST, PAINT SYSTEM ASSEMBLY					
ITEM NO.	PART NO.	DESCRIPTION	ITEM NO.	PART NO.	DESCRIPTION
1	188-377	Return Pipe	12	100-345	Screw (2)
2	100-004	Elbow	13	301-253	Manifold Block
3	100-112	Whip Hose	14	100-317	Nut (2)
4	100-019	Ball Valve			
5	100-002	Elbow			
6	100-109	Nipple (2)			
7	301-360	Maxi Filter			
8	169-013	Elbow			
9	100-123	Hose			
10	100-028	Plug (2)			
11	100-141	Elbow			

FIG. 3 PARTS LIST		
Item No.	Part No.	Description
1	301-231	Cog Belt
2	301-264	Clutch
3	305-088	Screw
4	100-175	Shoulder Screw
5	100-173	Screw Flanged (4)
6	100-174	Set Screw (2)
7	301-534	Block Tensioner
8	301-270	Gearbox
9	305-045	Plate
10	305-046	Spacer Tube (4)



REMOVE CLUTCH AS FOLLOWS:

1. Remove the upper and lower clutch covers (Fig. 1, Item 11 & 27) and gearbox cover (Fig. 1, Item 30).
2. Extract the splash cover (Fig. 1, Item 17) from the clutch brackets and spacer tubes (Fig. 1, Item 15).
3. Disconnect the two clutch leads from the electrical control board leads.
4. Unscrew the whip hose (Fig. 2, Item 9).
5. Remove fluid section as per page 13 of the manual.
6. Slide sleeve bearing (Fig. 1, Item 1) down and out of the gearbox.
7. Cycle connecting rod (Fig. 1, Item 26) to its lowest position and slide it off the gearbox crank.
8. Loosen the belt tensioner set screws (Fig. 3, Item 6) and the four flanged screws (Fig. 3, Item 5) in order to slacken the cog belt.
9. Use two 1/2" wrenches to remove four of the nuts from the studs and spacer tubes (Fig. 1, Items 23,24 & 15). Remove the lower two studs and all four spacer tubes. The upper two studs will normally remain attached to the gearbox plate (Fig. 1, Item 19).
10. Gently slip the cog belt (Fig. 1, Item 10) off the motor shaft sheave (Fig. 4, Item 7).
11. Lift the gearbox with the plate (Fig. 1, Item 25) attached, up and off the unit.
12. Complete Steps 5 - 8 of the Hi-Boy clutch removal procedure. See manual.

INSTALL NEW CLUTCH AS FOLLOWS:

1. Complete Steps 1 - 10 of the Hi-Boy Clutch Installation procedure.
2. Place the gearbox and clutch assembly on the unit ensuring the spacer tubes (Fig. 1, Item 5) are on the studs (Fig. 1, Item 8) prior to inserting the studs into the shock mount bracket (Fig. 1, Item 9)
3. Slide the cog belt over the motor shaft sheave.
4. Put two of the spacer tubes (Fig. 1, item 15) over the upper studs (Fig. 1, Item 24), insert one side of the upper two studs through the manifold holder (Fig. 1, Item 18) and tighten the four nuts (Fig. 1, Item 23).
The other side of the upper studs, normally should still be through the gearbox plate (Fig. 1, Item 19)
5. Insert the lower two studs, with spacer tubes, through the manifold holder and gearbox plate. Tighten the four nuts on both sides of the studs.
6. Screw in the belt tensioner set screws (Fig. 3, Item 6) until they are flush with the top of the tensioner block (Fig. 3, Item 7). This tensions the cog belt.
7. Loctite (blue) and tighten the four flanged screws (Fig. 3, Item 5).
8. Place the connecting rod (Fig. 1, Item 26) and sleeve bearing (Fig.1, Item 1) on the gearbox.
9. Reattach the fluid section as described on page 13 of the manual.
10. Reconnect the fluid hoses (Fig. 2, Item 9) and the suction hose.
11. Connect the two clutch leads to the electrical control board leads.
12. Snap the splash cover in place on the upper spacer tubes (Fig. 1, Item 15).
13. Test clutch for proper operation.
14. Replace all covers.

FIG. 4

FIG. 4 PARTS LIST ENGINE ASS'Y (PN 301-524)		
Item No.	Part No.	Description
1	301-160	Honda 5.5HP Engine
2	305-012	Adaptor
3	136-091	Screw (4)
4	112-029	Key
5	100-357	Screw
6	100-383	Screw (4)
7	301-222A	Sheave
8	301-229	Thrust Plate
9	301-230	Screw

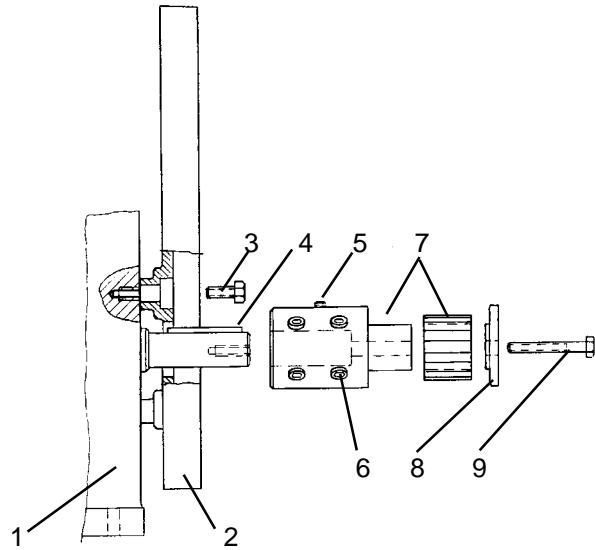

FIG. 5

FIG. 5 PARTS LIST SUCTION ASS'Y (PN 301-517)		
Item No.	Part No.	Description
1	100-165	Elbow
2	301-516	Clamp (2)
3	301-513	Hose
4	301-514	Suction Tube
5	141-008	Inlet Strainer

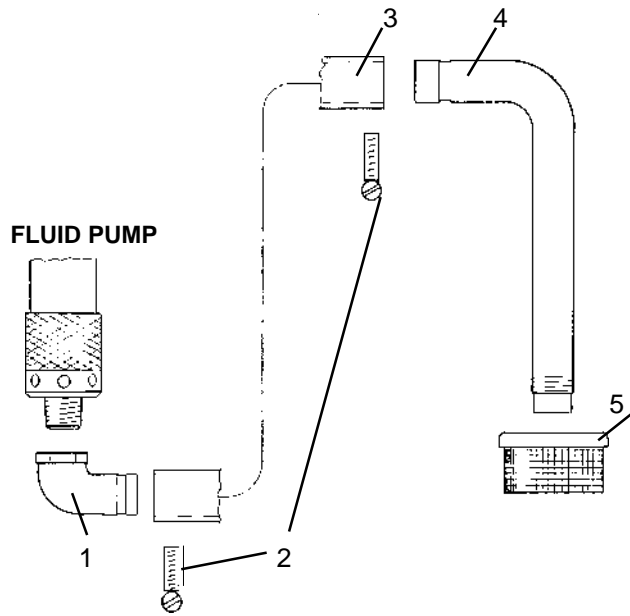

FIG. 6

FIG. 6 PARTS LIST, FRAME ASS'Y, PN 301-515		
Item No.	Part No.	Description
1	301-510	Frame Weldment
2	188-185	Spacer (2)
3	169-050	Screw (2)
4	163-011A	Washer (2)
5	163-008A	Rubber Foot (2)
6	100-317	Centerlock Nut (2)
7	188-367	Axle
8	143-011	Spacer (2)
9	301-165	Wheel (2)
10	143-029	Set Collar (2)
11	301-536	Shock Mount Bushing (4)
12	301-547	Screw (2)
13	100-344	Washer (4)
14	120-021	Nut (2)
15	100-170	Holder
16	301-546	Screw (2)
17	100-020	Lock Nut (2)
18	301-134	Rubber Stopper (2)
19	301-535	Rubber Pad

