

## Pump Repair and Conversion Kit™

308794D

For Medium Volume HIGH-FLO® Pumps



### Important Safety Instructions

Read all warnings and instructions in manual 308793.  
Save those instructions.

PROVEN QUALITY. LEADING TECHNOLOGY.

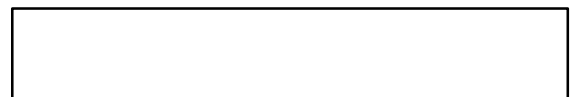

## Pump Seal Kits *See page 4 for parts lists.*

Kit Part No.	Description	Used on Displacement Pumps:	Used on Pumps:
220589	UHMWPE Seal Kit	Standard Kit for 239833 and 239836. Optional Kit for 239859 and 239860.	Standard Kit for 220561, 220564, 220566, 220569, 236601, 236602, 239854, and 239855. Optional Kit for 237222 and 237223.
224934	PTFE Seal Kit	Standard Kit for 239859 and 239860. Optional Kit for 239833 and 239836.	Standard Kit for 237222 and 237223. Optional Kit for pumps listed above.
220588	UHMWPE Seal Kit	Standard Kit for 239834 and 239837.	Standard Kit for 220560, 220563, 220565, 220568, 236605, and 236606.
224935	PTFE Seal Kit	Optional Kit for 239834 and 239837.	Optional Kit for pumps listed above.
220587	UHMWPE Seal Kit	Standard Kit for 239835 and 239838.	Standard Kit for 220559, 220562, 220567, 220570, 220577, 220578, 236712, and 236713.
224936	PTFE Seal Kit	Optional Kit for 239835 and 239838.	Optional Kit for pumps listed above.

## Throat Packing Kits *See page 4 for parts lists.*

Kit Part No.	Description	Used on Displacement Pumps:	Used on Pumps (see note below):
239872	UHMWPE/Leather Kit	Standard Kit for all displacement pumps.	Standard Kit for all Series B Pumps, and Series A of 239854 and 239855.
239866	PTFE Kit	Optional Kit for all displacement pumps.	Optional Kit for all Series B Pumps, and Series A of 239854 and 239855.
239868	Leather Kit	Optional Kit for all displacement pumps.	Optional Kit for all Series B Pumps, and Series A of 239854 and 239855.

**NOTE:** Series A pumps (except 239854 and 239855) use Repair Kits 220586, 220585, and 238162. Refer to manual 307838.

- △1 Lips of v-packings must face down.
- △2 Lips of v-packings must face up.
- △3 Lubricate.
- △4 Models 239859 and 239860 use 8 PTFE v-packings (20), instead of 5 UHMWPE (20) and 3 leather (25) as shown for all other models.
- △5 Used on stainless steel pumps only.
- △6 Relief valve intake seat.
- △7 Intake seat without relief valve.
- △8 Torque to 34–40 N•m (25–30 ft-lb).
- △9 Torque to 68–81 N•m (50–60 ft-lb).
- △10 Torque to 135 N•m (100 ft-lb).

# **Stainless Steel Pump Shown**

**NOTE:** Reference numbers correspond to those in manual 308793.

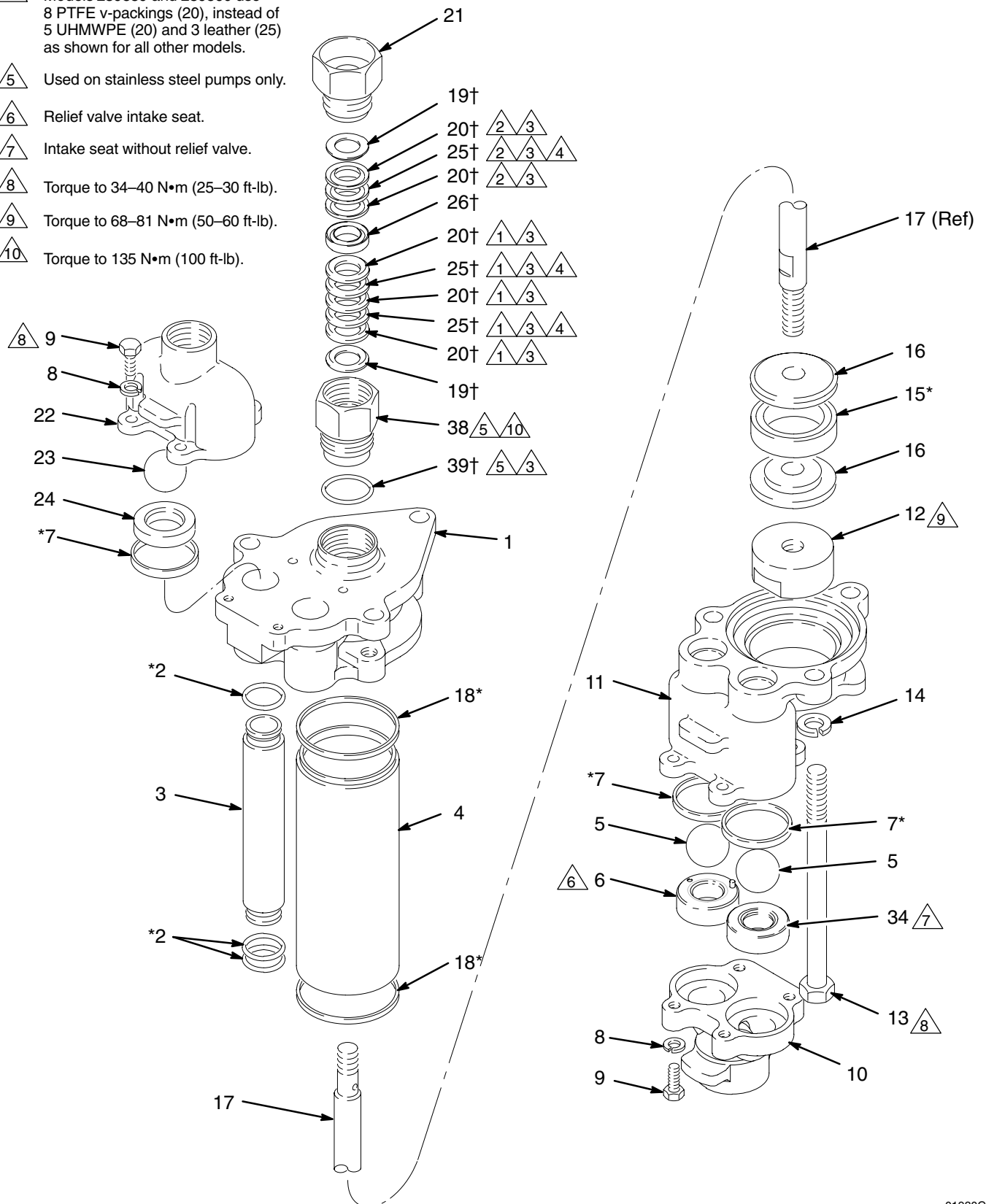

**Fig. 1**

01930C

## Pump Seal Kits

**NOTE:** Part numbers vary by kit. To find the part number used in your kit, read down the chart to find the desired ref. no., then read left to right to find the part number used in your kit.

Ref. No.	Description	Pump Seal Kit Part Numbers						Qty
		220589	220588	220587	224934	224935	224936	
2*	PACKING, o-ring; PTFE	108526	108526	108526	108526	108526	108526	6
7*	GASKET, seat, valve; UHMWPE	181877	181877	181877	181877	181877	181877	4
15*	PACKING, piston; UHMWPE	181680	183039	181793				1
	PACKING, piston; PTFE				187761	187762	187763	1
18*	GASKET, cylinder; UHMWPE	181875	183094	181876	181875	183094	181876	2

\* These parts are included in the Seal Repair Kit.

## Throat Packing Kits

**NOTE:** Part numbers vary by kit. To find the part number used in your kit, read down the chart to find the desired ref. no., then read left to right to find the part number used in your kit.

**NOTE:** Throat Packing Kits 239872, 239866, and 239868 are for use with Series B Pumps only, except for Models 239854 and 239855, which are Series A. All other Series A pumps use Repair Kits 220586, 220585, and 238162. Refer to manual 307838.

Ref. No.	Description	Throat Packing Kit Part Numbers			Qty
		239872	239866	239868	
19†	GLAND, male; sst	192263	192263	192263	2
20†	V-PACKING, throat; UHMWPE	183295			5
20†	V-PACKING, throat; PTFE		183352		8
25†	V-PACKING, throat; leather	183294			3
25†	V-PACKING, throat; leather			183294	8
26†	GLAND, female; sst	192264	192264	192264	1
39†	O-RING; PTFE	107313	107313	107313	1

† These parts are included in the Throat Packing Repair Kit.

## Intake Seat Conversion Kit 239867

Converts Series A High-Flo pumps to the new relief valve intake seat design.

Ref. No.	Description	Part No.	Qty
6	SEAT, intake valve, with relief valve; sst	253483	1
7	GASKET, seat, valve; UHMWPE	181877	2
8	WASHER, flat; 8.4 mm; sst	111003	4
9	CAPSCREW, hex hd; M8 x 1.25 x 25; sst	112084	4
10	HOUSING, intake; sst	192259	1
34	SEAT, intake valve; sst	239865	1

## Throat Cartridge Conversion Kit 239869

Converts carbon steel High-Flo displacement pumps to the cartridge design used on stainless steel pumps.

Ref. No.	Description	Part No.	Qty
1	HOUSING, pump, upper; sst	192512	1
38	CARTRIDGE, throat; sst	192490	1
39	O-RING; PTFE	107313	1

[illegible]

# Graco Standard Warranty

Graco warrants all equipment manufactured by Graco and bearing its name to be free from defects in material and workmanship on the date of sale to the original purchaser for use. With the exception of any special, extended, or limited warranty published by Graco, Graco will, for a period of twelve months from the date of sale, repair or replace any part of the equipment determined by Graco to be defective. This warranty applies only when the equipment is installed, operated and maintained in accordance with Graco's written recommendations.

This warranty does not cover, and Graco shall not be liable for general wear and tear, or any malfunction, damage or wear caused by faulty installation, misapplication, abrasion, corrosion, inadequate or improper maintenance, negligence, accident, tampering, or substitution of non-Graco component parts. Nor shall Graco be liable for malfunction, damage or wear caused by the incompatibility of Graco equipment with structures, accessories, equipment or materials not supplied by Graco, or the improper design, manufacture, installation, operation or maintenance of structures, accessories, equipment or materials not supplied by Graco.

This warranty is conditioned upon the prepaid return of the equipment claimed to be defective to an authorized Graco distributor for verification of the claimed defect. If the claimed defect is verified, Graco will repair or replace free of charge any defective parts. The equipment will be returned to the original purchaser transportation prepaid. If inspection of the equipment does not disclose any defect in material or workmanship, repairs will be made at a reasonable charge, which charges may include the costs of parts, labor, and transportation.

**THIS WARRANTY IS EXCLUSIVE, AND IS IN LIEU OF ANY OTHER WARRANTIES, EXPRESS OR IMPLIED, INCLUDING BUT NOT LIMITED TO WARRANTY OF MERCHANTABILITY OR WARRANTY OF FITNESS FOR A PARTICULAR PURPOSE.**

Graco's sole obligation and buyer's sole remedy for any breach of warranty shall be as set forth above. The buyer agrees that no other remedy (including, but not limited to, incidental or consequential damages for lost profits, lost sales, injury to person or property, or any other incidental or consequential loss) shall be available. Any action for breach of warranty must be brought within two (2) years of the date of sale.

Graco makes no warranty, and disclaims all implied warranties of merchantability and fitness for a particular purpose in connection with accessories, equipment, materials or components sold but not manufactured by Graco. These items sold, but not manufactured by Graco (such as electric motors, switches, hose, etc.), are subject to the warranty, if any, of their manufacturer. Graco will provide purchaser with reasonable assistance in making any claim for breach of these warranties.

In no event will Graco be liable for indirect, incidental, special or consequential damages resulting from Graco supplying equipment hereunder, or the furnishing, performance, or use of any products or other goods sold hereto, whether due to a breach of contract, breach of warranty, the negligence of Graco, or otherwise.

## **FOR GRACO CANADA CUSTOMERS**

The parties acknowledge that they have required that the present document, as well as all documents, notices and legal proceedings entered into, given or instituted pursuant hereto or relating directly or indirectly hereto, be drawn up in English. Les parties reconnaissent avoir convenu que la rédaction du présente document sera en Anglais, ainsi que tous documents, avis et procédures judiciaires exécutés, donnés ou intentés à la suite de ou en rapport, directement ou indirectement, avec les procédures concernées.

# Graco Information

**TO PLACE AN ORDER**, contact your Graco distributor, or call one of the following numbers to identify the distributor closest to you:

**1-800-328-0211 Toll Free**

**612-623-6921**

**612-378-3505 Fax**

*All written and visual data contained in this document reflects the latest product information available at the time of publication.*

*Graco reserves the right to make changes at any time without notice.*

This manual contains English. MM 308794

**Graco Headquarters:** Minneapolis  
**International Offices:** Belgium, China, Japan, Korea

**[www.graco.com](http://www.graco.com)**

308794 09/1997 Revised 08/2006