

Repair



# Interior Texture Sprayers **TexSpray™ RTX 750™** **and RTX 1000™**

309586B

## ***For Water-Based Materials Only***

### **Models:**

**246183, 246555 - RTX 750, 6 Gallon**

*55 psi (3.79 bar) Maximum Fluid Working Pressure*

**246184, 246556 - RTX 1000, 8 Gallon**

*60 psi (4.14 bar) Maximum Fluid Working Pressure*



**Read warnings and instructions.**

### **Related Manuals**



**309584**



**309585**

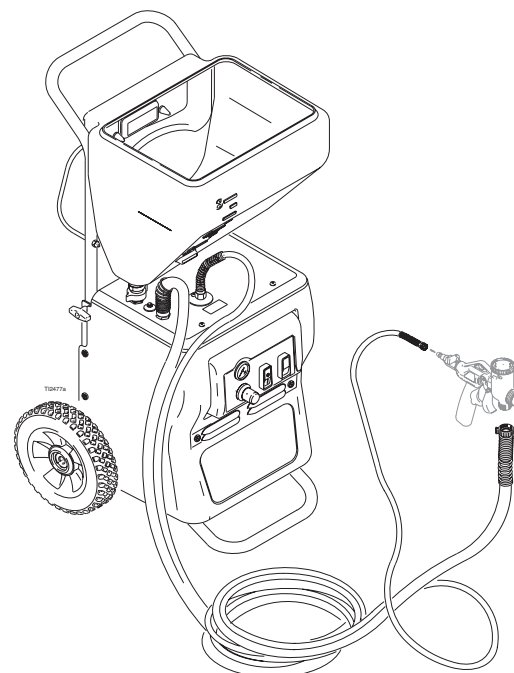

**Model 246184 Shown**

Graco Inc. P.O. Box 1441 Minneapolis, MN 55440-1441

[www.graco.com](http://www.graco.com)



Copyright 2003





Graco Inc. is registered to I.S. EN ISO 9001

**PROVEN QUALITY. LEADING TECHNOLOGY.**

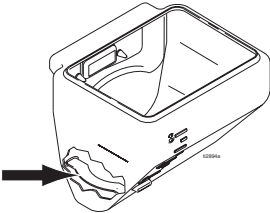

Conforms to ANSI/UL  
standard 1450

|  | WARNINGS  |
|---|---|
|  | <p><b>Fire and Explosion Hazard</b><br/>Improper grounding, poor ventilation, open flames or sparks can cause a hazardous condition and result in fire or explosion and serious injury.</p> <ul style="list-style-type: none"> <li>• The system is for use with water-based materials only. Only use fluids compatible with the equipment. Refer to Technical Data of all equipment manuals. Read fluid and solvent manufacturers warnings.</li> <li>• Ground the equipment. See <b>Grounding and Electrical Requirements</b>, page 5.</li> <li>• If there is any static sparking or you feel an electric shock while using this equipment, stop spraying immediately. Do not use the equipment until you identify and correct the equipment until you identify and correct the problem.</li> <li>• Keep work area free of debris, including solvent, rags and gasoline.</li> <li>• Comply with all applicable state and national fire, electrical and safety regulations.</li> </ul>   |
|  | <p><b>Equipment Misuse Hazard</b><br/>Equipment misuse can cause equipment to rupture, malfunction, or start unexpectedly and cause serious injury.</p> <ul style="list-style-type: none"> <li>• Before operating this equipment, read all manuals, tags, and labels, including material labels and instructions.</li> <li>• Do not expose system to rain. Always store system indoors.</li> <li>• Do not alter or modify equipment.</li> <li>• Do not spray cementitious materials.</li> <li>• Do not exceed maximum working pressure of lowest rated component in your system.</li> <li>• Check equipment daily. Repair or replace worn or damaged parts immediately.</li> <li>• To reduce risk of serious injury, including electric shock and splashing fluid in eyes, follow <b>Pressure Relief Procedure</b> on page 5 before servicing the unit.</li> <li>• Do not use hoses to pull equipment.</li> <li>• Route hoses away from traffic areas, sharp edges, moving parts and hot surfaces. Do not expose Graco hoses to temperatures above 130 F (55 C) or below -35 F (-37 C).</li> <li>• Air hoses at the compressor end, can get very hot! Allow sprayer to cool down 15 minutes before removing air hose.</li> <li>• Store hazardous fluid in an approved container. Dispose of hazardous fluid according to all local, state and national guidelines.</li> <li>• Never directly inhale compressed air. Compressed air may contain toxic vapors.</li> </ul> |

| WARNINGS  |   |
|---|---|
|    | <p><b>Electric Shock Hazard</b><br/>To reduce the risk of electric shock:</p> <ul style="list-style-type: none"> <li>• Be sure sprayer is adequately grounded through electrical outlet, page 5.</li> <li>• Use only 3-wire, extension cords.</li> <li>• Make sure ground prongs are intact on sprayer and extension cords.</li> <li>• Do not operate with cover removed.</li> <li>• Turn off sprayer. Follow <b>Pressure Relief Procedure, page 5</b>, and unplug unit, before removing any parts.</li> </ul>  |
|    | <p><b>Pressurized Equipment Hazard</b><br/>Fluid from gun, leaks or ruptured components can splash in the eyes or on skin and cause serious injury.</p> <ul style="list-style-type: none"> <li>• Follow <b>Pressure Relief Procedure, page 5</b> when you stop spraying and before cleaning, checking or servicing.</li> <li>• Do not point spray gun at anyone; put hand, fingers or rag over nozzle, or stop or deflect leaks with your hand, body, glove, or rag.</li> <li>• Wear protective clothing, gloves, and eyewear.</li> </ul> <div data-bbox="300 976 568 1186">  </div> <ul style="list-style-type: none"> <li>• Before adding material to hopper, install burp guard. When only a small amount of material remains in the hopper, the burp guard prevents material from shooting out when the unit is turned off. This material could splash in the operator's eyes or on skin, or into the air.</li> </ul> |
|  | <p><b>Cleaning Solvent Hazard with Plastic Parts</b><br/>Use only compatible water-based solvents to clean plastic structural or pressure-containing parts. Many solvents can degrade plastic parts to the point where they could fail. Such failure could cause serious injury or property damage. See Technical Data on page 26 of this instruction manual and in all other equipment manuals. Read fluid and solvent manufacturer's warnings.</p>  |

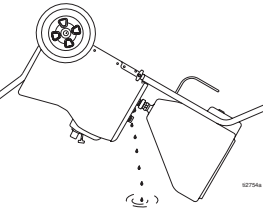
| CAUTION   |   |
|---|---|
|  | <p>Water or material remaining in unit when temperatures are below freezing can damage motor and/or delay pump startup.</p> <p>To insure water and material are completely drained out of unit:</p> <ol style="list-style-type: none"> <li>1. Remove material line from sprayer.</li> <li>2. Tip sprayer up as shown.</li> </ol> <p>Before adding material or starting unit in cold weather, run warm water through pump.</p> |

# Component Identification

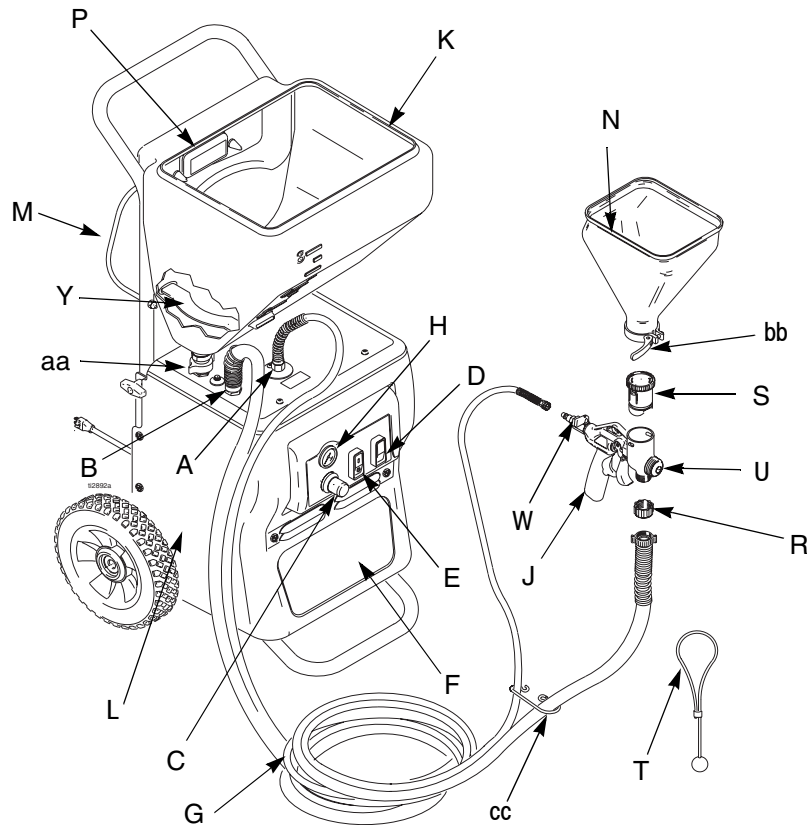

| Item | Component   | Item | Component                    |
|------|---|------|------------------------------|
| A    | Air hose outlet   | N    | Touch-up hopper (3/4 gallon) |
| B    | Material hose outlet  | P    | Nozzle storage               |
| C    | Material flow control (RTX 1000 model only)   | R    | Hose plug                    |
| D    | Hopper gun/spray gun selector switch  | S    | Gun plug                     |
| E    | ON/OFF switch   | T    | Material thickness gauge     |
| F    | Air Compressor (inside)   | U    | Nozzle (3 sizes available)   |
| G    | Material/air hose   | W    | Gun air valve                |
| H    | Material flow indicator (RTX 1000 model only)   | Y    | Burp guard                   |
| J    | Texture spray gun (manual 309584)   | aa   | Hopper fitting (fluid inlet) |
| K    | Material Hopper - 6 gallon, RTX 750 model<br>Material Hopper - 8 gallon, RTX 1000 model | bb   | Hopper clamp                 |
| L    | RotoFlex™ pump (inside)   | cc   | Hose clip                    |
| M    | Hose rack/cord wrap   |      |                              |

# Preparation

## Pressure Relief Procedure



To reduce risk of injury, follow this procedure whenever you see this symbol throughout this manual. Also, perform this procedure whenever you:

- stop spraying.
- check or repair any part of this system.
- install or clean spray nozzle.



### WARNING



page 2

1. Turn Power Switch OFF.

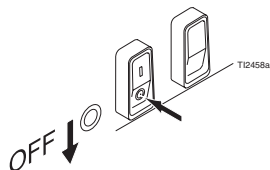

2. Trigger gun into material hopper.

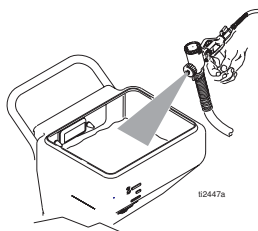

3. Open gun air valve.

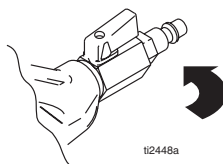

## Grounding and Electrical Requirements

This sprayer must be grounded. Grounding reduces the risk of electrical shock by providing an escape wire for the electrical current. The sprayer cord includes a grounding wire with an appropriate grounding plug. The plug must be plugged into an outlet that is properly installed and grounded in accordance with all local codes and ordinances.

Check with a qualified electrician or serviceman if grounding instructions are not completely understood, or if in doubt as to whether the product is properly grounded. Do not modify plug provided; if it will not fit the outlet, have proper outlet installed by a qualified electrician.



### WARNING



page 2

## 120V AC Systems

- This equipment requires a 120V AC, 60 Hz, 15A circuit with a grounding receptacle. Do not use an adapter with this product.

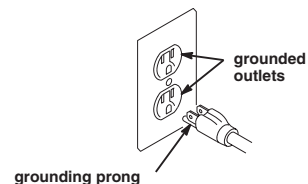

## Extension Cords

- Use only an extension cord with an undamaged, 3-prong plug.
- For 25 to 50 ft (7.6 to 15.2 m) cords, use 3-wire, 14 AWG (1.5 mm<sup>2</sup>) minimum.
- For up to 100 ft. (30.48 m) cord, use 3-wire, 12 AWG (2.5 mm<sup>2</sup>) minimum.

## Auxiliary Air Compressor

Do not use an auxiliary air compressor with this spray system.

## Generator Requirements

3500 W (3.5 KW) minimum.

## Hose Size and Length

The system comes with a hose set consisting of a 3/4 in. ID x 25 ft (25 mm x 7.6 m) material hose and a 3/8 in-ID air hose.

Do not use more than 25 ft. (7.6 m) of material hose.



### WARNING



page 2

# RotoFlex™ Pump

## Disassembly

1. **Relieve Pressure**, page 5.
2. Unplug sprayer from outlet.
3. Remove shroud (6 bolts).

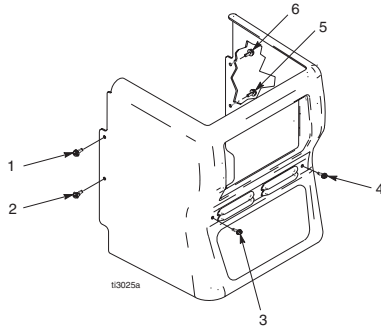

4. Remove hopper by loosening bottom fitting and then lifting hopper straight up, off unit.

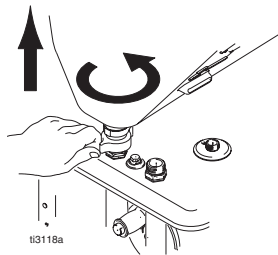

5. Remove material hose.

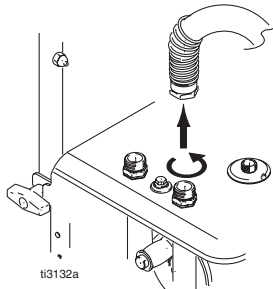

6. Loosen bolt (A) located between air and material hose outlets. Unscrew bolt to lower plate, leaving about 4-5 threads on bolt.

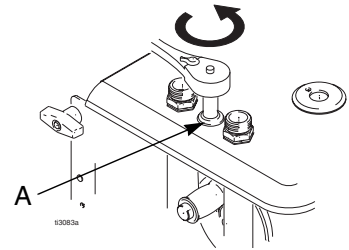

**DO NOT REMOVE BOLT COMPLETELY.**

7. Slide a 2 x 4 under motor for support.

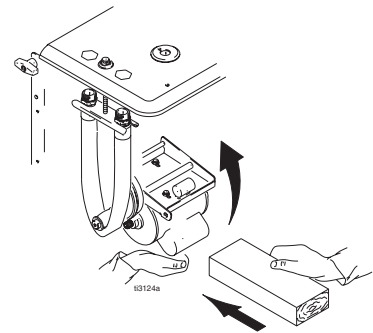

8. Rotate plate. Slide hose off by pushing outward on hose fitting.

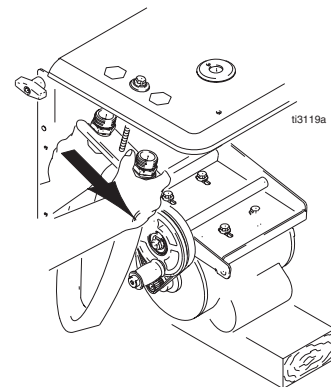

## Reassembly

Reinstall RotoFlex Pump hose on plate.

1. Kink hose as shown, making sure dots located on hose fitting face each other.

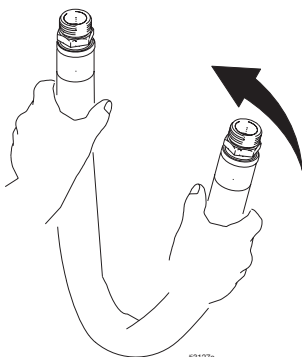

2. Slide hose onto plate as shown below, making sure plate slides into slot between hex fitting on end of hose.

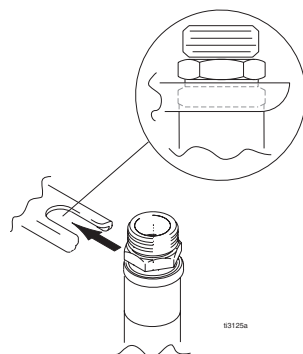

3. Align dots located on hose fitting, making sure they are facing each other at all times to ensure the hose does not twist during reinstallation.

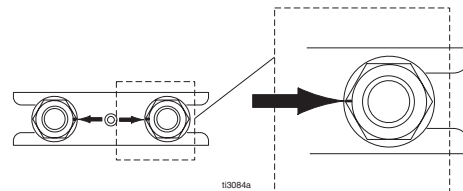

4. Reposition plate, aligning hex fittings with enclosure openings.
5. Remove 2 x 4 support under motor.
6. Tighten bolt. As bolt is tightened the plate will snug back into place.
7. Replace shroud (6 bolts).
8. Replace hopper.
9. Break in new pump by running dry or with warm water for 3-5 minutes.

# Compressor Repair

Use Compressor Repair Kit, 234211.

## Disassembly

1. **Relieve Pressure**, page 5.
2. Unplug sprayer.
3. Remove shroud (6 bolts)

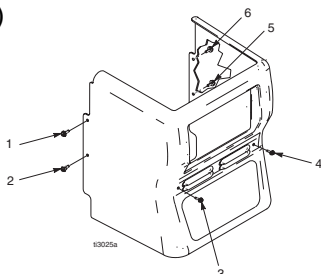

4. Remove green ground wire and black, and white wires to compressor.

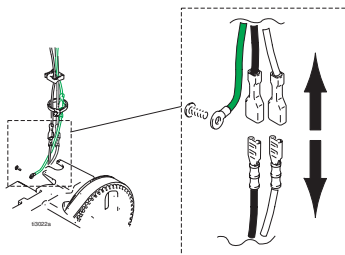

5. Loosen fittings (A and B) and remove air line.

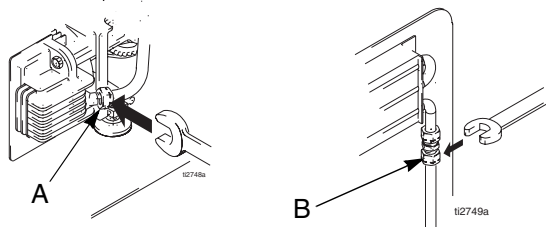

6. Using a socket wrench with extension, loosen bolts (3).

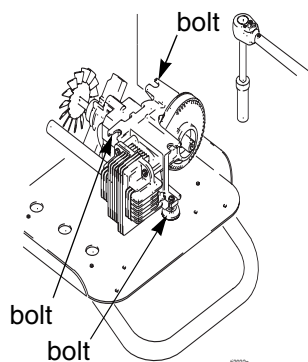

7. Tilt compressor forward and remove from housing.

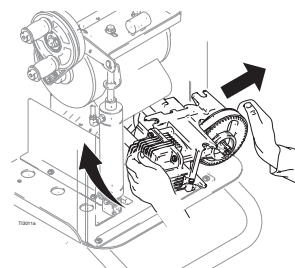

### CAUTION

Fan blades are very delicate and can be damaged very easily. When removing or replacing compressor, do not bump or jar shroud or fan blades.

8. Thoroughly clean inside housing, removing dust and debris.

## Reassembly

1. Carefully position compressor in housing.
2. Replace bolts using socket wrench to tighten. Torque to 85 in. lbs.
3. Reattach air lines to compressor. Finger tighten plus one full turn, fittings (A and B).

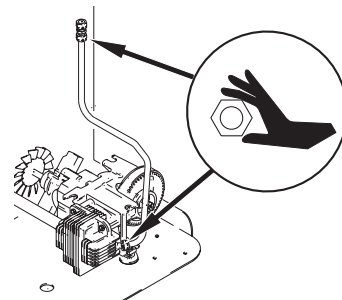

4. Reattach 3 wires to compressor matching green to green, black to black and white to white.

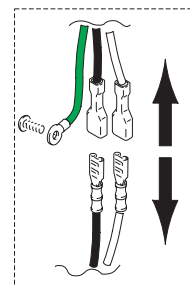

5. Replace shroud. Tighten bolts (6).



# Roller Replacement

Use Roller Repair Kit 234214.

## Disassembly

1. **Relieve Pressure**, page 5.
2. Unplug sprayer from outlet
3. Remove shroud (6 bolts).

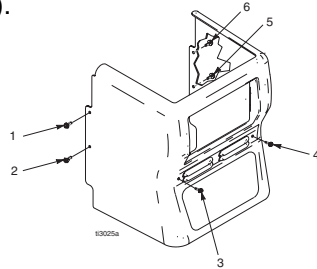

4. Remove RotoFlex Pump, page 6.
5. Using a crow bar as a wedge to keep rollers from moving, loosen shoulder bolt.

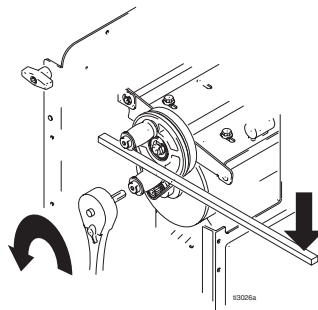

6. Remove rollers.

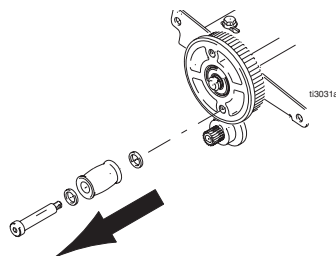

## Reassembly

### CAUTION

When installing bolt through roller, keep nylon washer on shoulder of bolt.

1. Replace rollers.

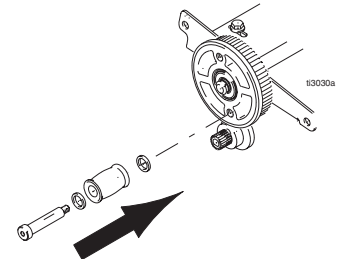

2. Using a crow bar as a wedge to keep rollers from moving, torque bolts to 40 ft. lbs.

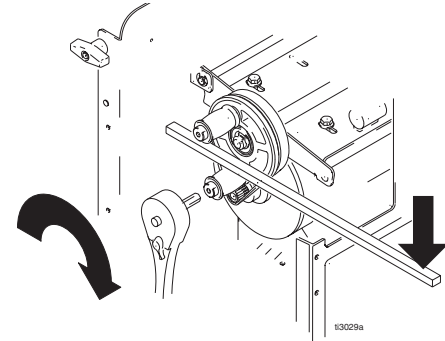

3. Reinstall RotoFlex Pump hose on plate, page 6.
4. Replace shroud. Tighten bolts (6).

# Cylinder

Use Cylinder Repair Kit 246574, RTX 750.  
Use Cylinder Repair Kit 246575, RTX 1000.

## Disassembly

1. **Relieve Pressure**, page 5.
2. Unplug sprayer from outlet.
3. Remove shroud (6 bolts).

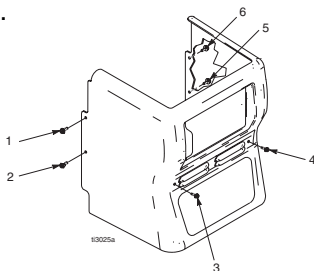

4. Disconnect air hose at quick disconnect fitting.

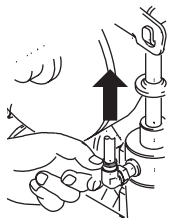

5. Remove clip.
6. Remove pin.

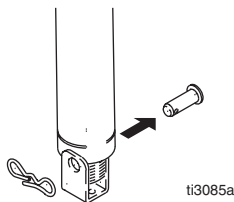

## Reassembly

1. Insert swing arm through hole.

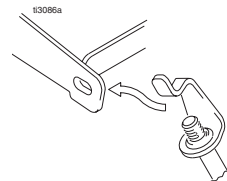

2. Align hole in bottom of cylinder with holes in bottom bracket.
3. Feed pin through.
4. Replace clip.

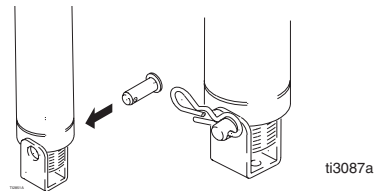

5. Reattach air hose to quick disconnect fitting.

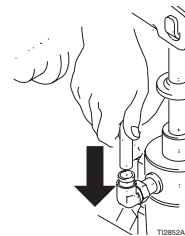

6. Replace shroud. Tighten bolts (6).

7. Pull swing arm out of opening.

# Capacitor Replacement

Use Capacitor Replacement Kit 244683.

## WARNING



page 2

## Disassembly

1. **Relieve Pressure**, page 5.
2. Unplug sprayer.
3. Remove shroud, (6 bolts).

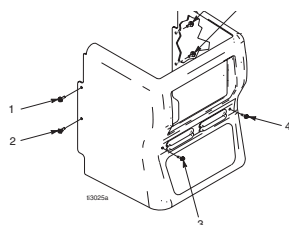

4. Capacitors can hold a charge. To prevent electric shock, use a flat bladed screw driver as a conductive device to short out the terminals. To do this, touch the blade of the flat screw driver between two terminal posts on the capacitor.

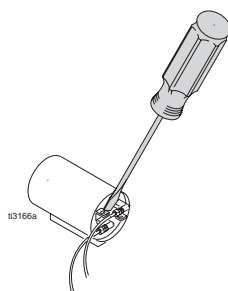

5. Cut strap.
6. Unplug capacitor and remove.

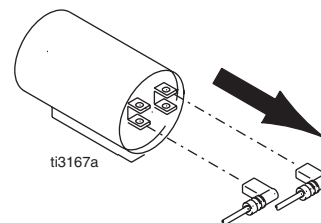

7. Clean surface to remove dirt and any remaining adhesive.

## Reassembly

1. Remove backing from one side of two-sided tape provided in kit and apply to bottom of capacitor.
2. Plug in new capacitor.

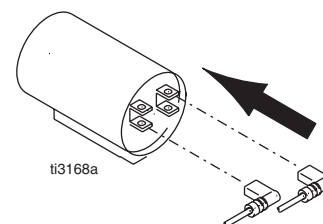

Wires are not polarized. It does not matter which wires are connected together between capacitor and motor.

3. Remove backing from bottom of two sided tape. Attach capacitor to plate, pressing taped side firmly into position. Secure using a wire tie.
4. Replace shroud. Tighten bolts (6).

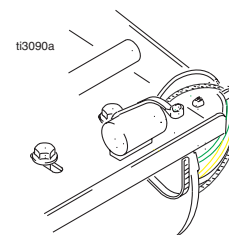

## CAUTION

Do not touch metal part of screw driver when shorting out capacitor.

# Motor Repair

Use Motor Repair Kit 246572.

## Disassembly

1. **Relieve Pressure**, page 5.
2. Unplug sprayer from outlet.
3. Remove shroud (6 bolts).

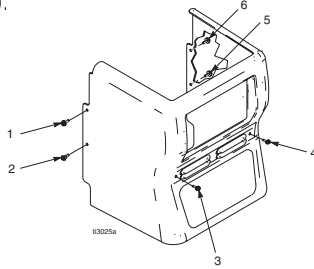

4. Remove RotoFlex Pump hose; page 6.
5. Remove Air Cylinder; page 10.
6. Cut wire tie (A).

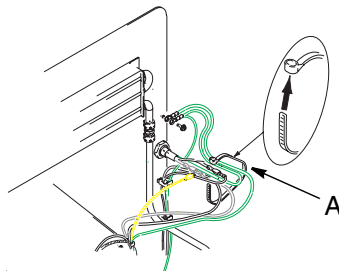

7. Remove yellow wire (B).

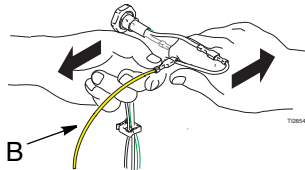

8. Remove ground nut (C).

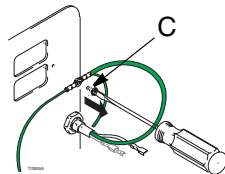

9. Remove blue wire to switch (D).

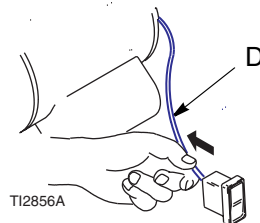

10. Using a flat screw driver, remove c-clip (E).

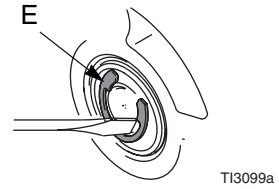

11. Using your hand to support the motor, carefully pull rod (F) out through back.

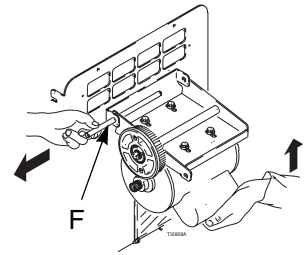

12. Bring motor to work-bench.

13. Remove 4 bolts (G) holding motor to bracket.

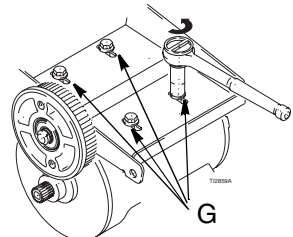

14. Cut wire tie. Remove capacitor from plate, page 11.

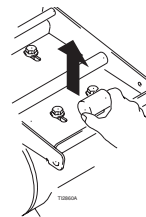

## Reassembly

1. Reposition motor in housing, keeping motor square and aligned to pulley.
2. Keeping tension on belt, tighten 4 bolts (G). Torque to 15 ft-lbs.

The motor will have a tendency to move when bolts are being tightened. Hold it securely in place, square and aligned to pulley.

3. Secure new capacitor to plate, page 11.

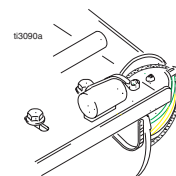

4. Using one hand to support motor, slide rod (F) through motor bracket.

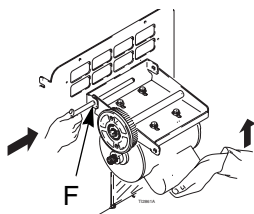

5. Replace c-clip (E).

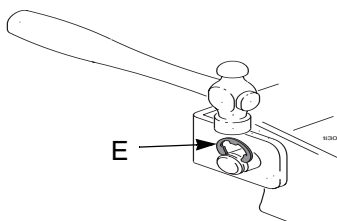

For steps 6-9 refer to illustration below Step 9.

6. Reattach blue wire to switch (D).
7. Replace ground nut (C).

8. Reattach yellow wire (B).
9. Secure all wires together with wire tie (A), making sure the wires do not touch air line (H) and the motor can swing the full travel (I) without stressing wires.

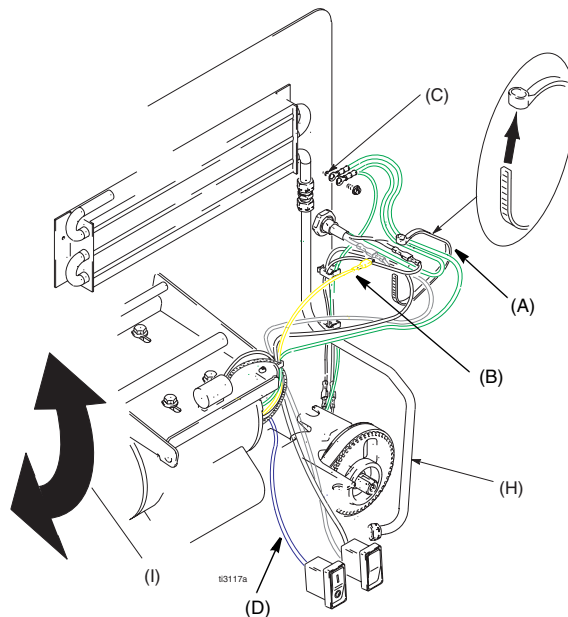

10. Reconnect RotoFlex Pump hose, page 6.
11. Replace shroud. Tighten bolts (6).

# Cooler Repair

Use Cooler Repair Kit 246578.

## Disassembly

1. **Relieve Pressure**, page 5.
2. Unplug sprayer.
3. Remove shroud (6 bolts).

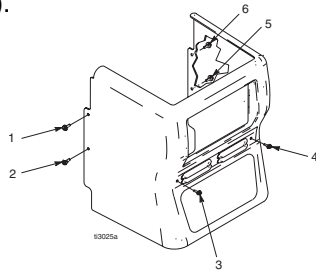

4. Loosen nuts (A and B).

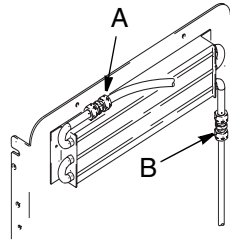

5. Disconnect air hose at fitting.

6. Carefully drill out rivets.

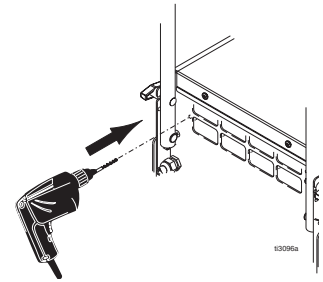

7. Pull cooler out of housing.

## Reassembly

1. Install cooler in housing.
2. Rivet (or use fasteners) in place.

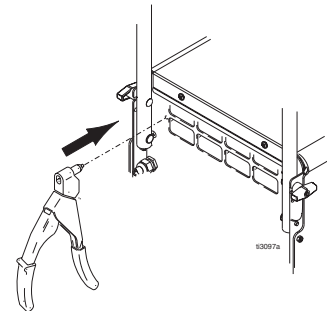

3. Reconnect tubing.  
Torque nuts (A and B) one full turn beyond hand tight.
4. Replace shroud. Tighten bolts (6).

# Relief Valve Replacement

Use Air Relief Valve Kit 246580.

## Disassembly

1. **Relieve Pressure**, page 5.
2. Unplug sprayer.
3. Remove shroud (6 bolts)

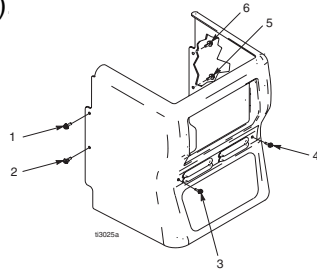

4. Remove screw on top of unit.
5. Remove air lines.

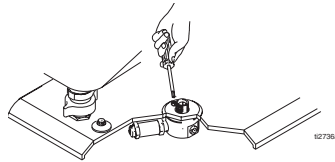

6. Pull air manifold down through inside of housing.
7. Disconnect air hose at quick disconnect fitting.

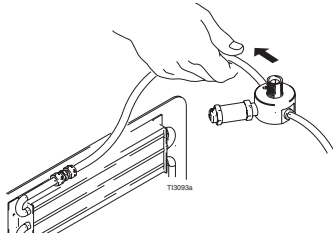

## Reassembly

1. Reattach air hoses at quick disconnect fitting.

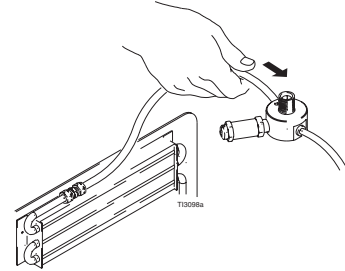

2. Slide air manifold back into position inside housing.

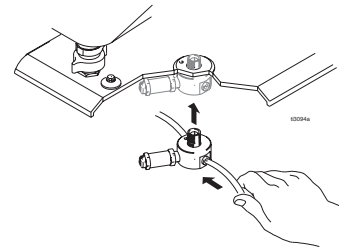

3. Replace screw on top of unit - torque to 30 in. lbs.
4. Replace shroud. Tighten bolts (6).

# Rotor Replacement

Use Rotor Kit 246585 (includes Roller Kit 234214)

7. Remove rotor.

## Disassembly

1. **Relieve Pressure**, page 5.
2. Unplug sprayer.
3. Remove shroud (6 bolts).
4. Remove RotoFlex pump hose, page 6, Disassembly, steps 4-8.
5. Remove rollers, page 9, Disassembly.
6. Using a flat screwdriver, remove c-clip (A).

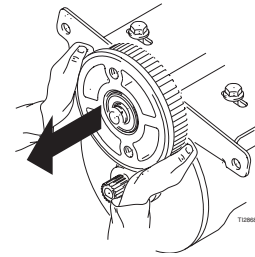
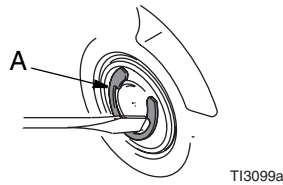
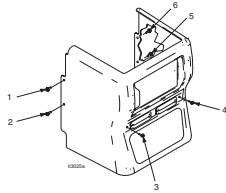

## Reassembly

1. Install rotor with flange facing outward.
2. Replace c-clip (A).
3. Install rollers, page 9, Reassembly.
4. Install RotoFlex Pump hose and shroud, page 7, Reassembly.



# Troubleshooting



## Pressure Relief, page 5

| Problem                                | Cause                                  | Solution  |
|--|--|---|
| Sprayer won't run                      | Power switch not on                    | Turn switch on.   |
|  | No power at wall outlet                | Check outlet by plugging in another appliance. If appliance does not work, try another outlet.  |
|  | Wrong size generator                   | Use a 3500 watt or larger generator. Refer to Generator Requirements, page 5  |
|  | Too many items on same circuit         | Unplug other items from circuit   |
|  | Extension cord too long or wrong gauge | Use a different extension cord. Refer to Grounding and Electric Requirements, page 5  |
|  | Breaker tripped                        | Reset breaker   |
| Pump won't pump material               | Selector switch in wrong position      | Move selector switch to correct position for application  |
|  | Air lock                               | Open air valve on gun   |
|  | Mix too thick                          | Add water to thin material. Use Material Thickness Gauge.   |
|  | Loose fittings                         | Check and retighten all fittings  |
|  | Plugged gun                            | <b>Relieve Pressure</b> , page 5. Remove gun from hose. Clean gun.  |
|  | RotoFlex pump worn out                 | Replace hose. Recommended hose replacement - once a year or every 3000 gallons.   |
|  | Pump cold or material frozen in pump   | Move pump to warm room and allow it to warm up or run hot water through sprayer.  |
| Material runs out of bottom of sprayer | Motor start capacitor failure          | Replace capacitor and restart   |
|  | RotoFlex pump worn out                 | Replace hose  |
| No air from compressor                 | Loose fittings                         | Check and retighten all fittings  |
|  | Gun air valve closed                   | Open gun air valve  |
|  | Low voltage                            | Check extension cord length and gauge. Replace if different than recommended. Refer to Grounding and Electrical Requirements, page 5. |
|  | Gun needle plugged                     | Clean needle and retry.   |
|  | Lines not connected                    | Check all quick disconnect connections to gun and hoses   |
|  | Damaged hose                           | Replace hose  |
|  | Worn compressor                        | Replace compressor. Contact a qualified Graco Service Center.   |

| Problem                                   | Cause                                     | Solution  |
|---|---|---|
| Speed of application too slow             | Material too thick                        | Thin material.  |
|   | Nozzle too small                          | Change nozzles to a larger size. See Operation Manual, Recommended Nozzle Selection Chart, page 10. |
|   | Too much air being used.                  | Partially close gun air valve to reduce air flow.   |
|   | Flow control (RTX 1000 model) set too low | Increase flow control setting   |
|   | Plugged or dirty gun                      | <b>Relieve Pressure</b> , page 5. Clean gun.  |
|   | Kinked hose                               | Unkink hose.  |
|   | Gun fluid flow adjustment set too low     | Increase flow adjustment with flow adjustment nut.  |
|   | RotoFlex pump worn                        | Replace hose.   |
| Intermittent flow/sputtering              | Hopper connection not tight               | Check gasket. Tighten connection.   |
|   | Debris in system                          | Clean   |
| Quick disconnect does not stay connected. | Dirty or corroded fitting                 | Clean thoroughly. Soak in oil. Apply a few drops of light oil.                                      |
| Gun will not shut off                     | Worn nozzle or needle.                    | <b>Relieve Pressure</b> , page 5. Replace worn parts.   |
|   | Debris in needle passage                  | <b>Relieve Pressure</b> , page 5. Clean.  |
| Fluid leaking at Flow Adjustment Nut      | Damaged seal.                             | <b>Relieve Pressure</b> , page 5. Replace seal.   |
| Fluid leaking out of either plug          | Missing or damaged o-rings                | <b>Relieve Pressure</b> , page 5. Replace o-rings.  |
|   | Gun damaged                               | Replace gun   |
| Needle adjustment won't adjust            | Dirty threads                             | Clean threads   |
|   | Nozzle not on gun                         | Put nozzle on gun   |

## Wiring Diagram

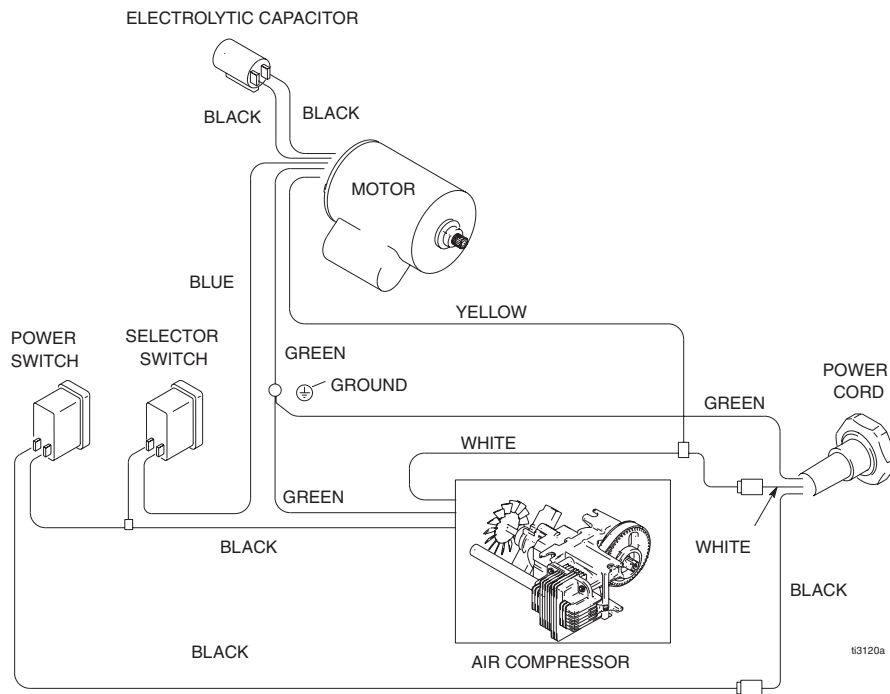

## Air Diagram

ALTERNATE RTX 1000 CONFIGURATION FOR UNITS WITH REGULATOR DIAL AND GAUGE.

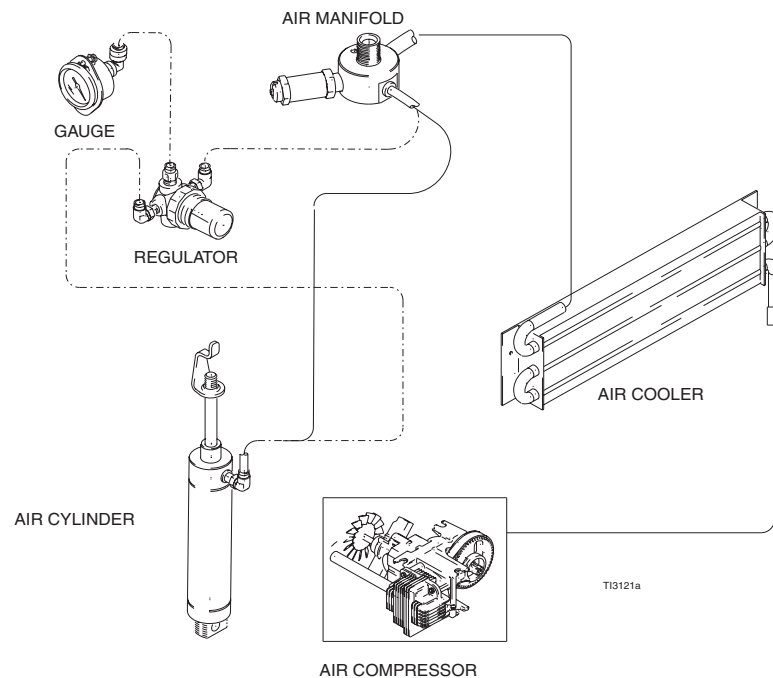

## Parts

Model 246183, RTX 750

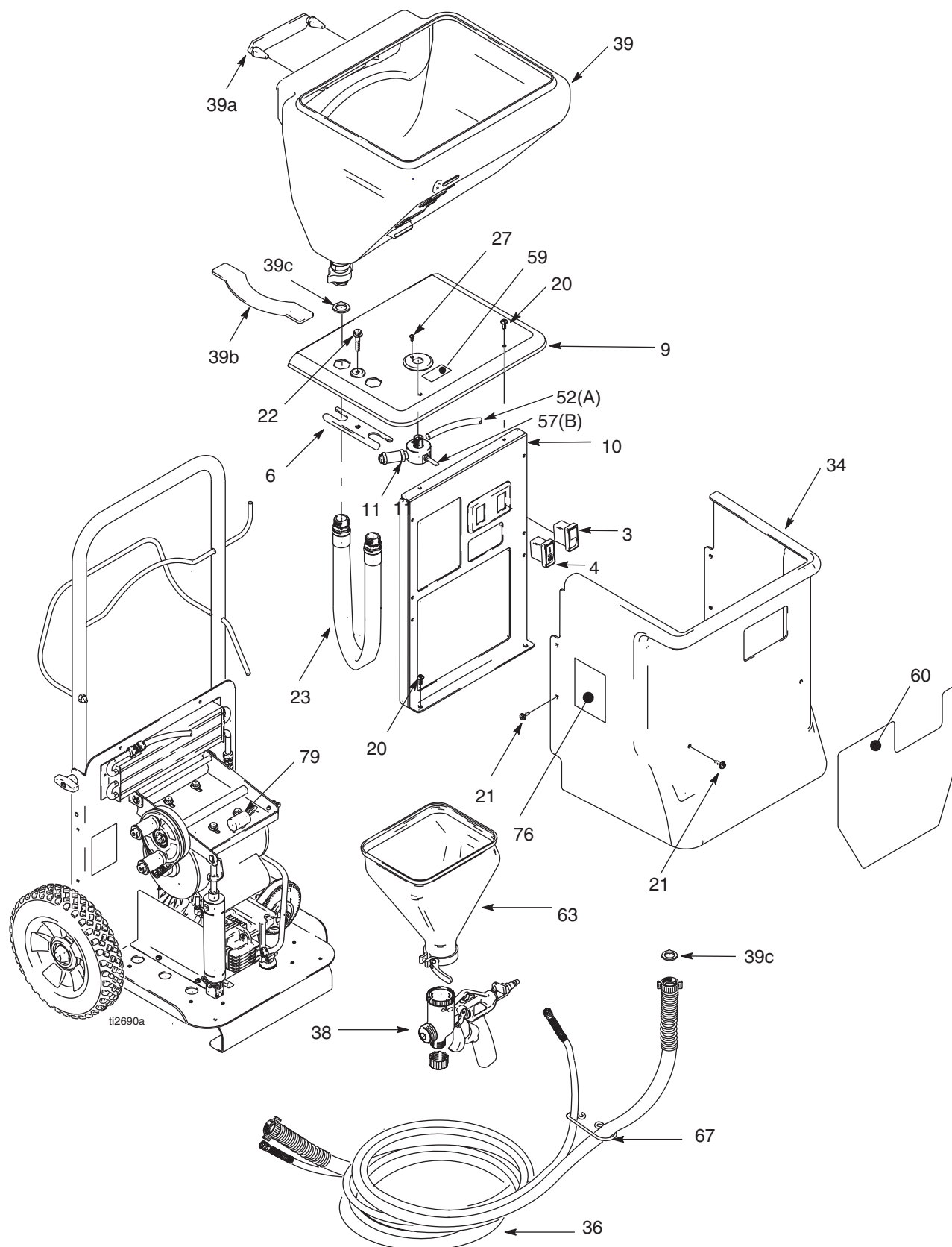

# Parts

Model 246183, RTX 750

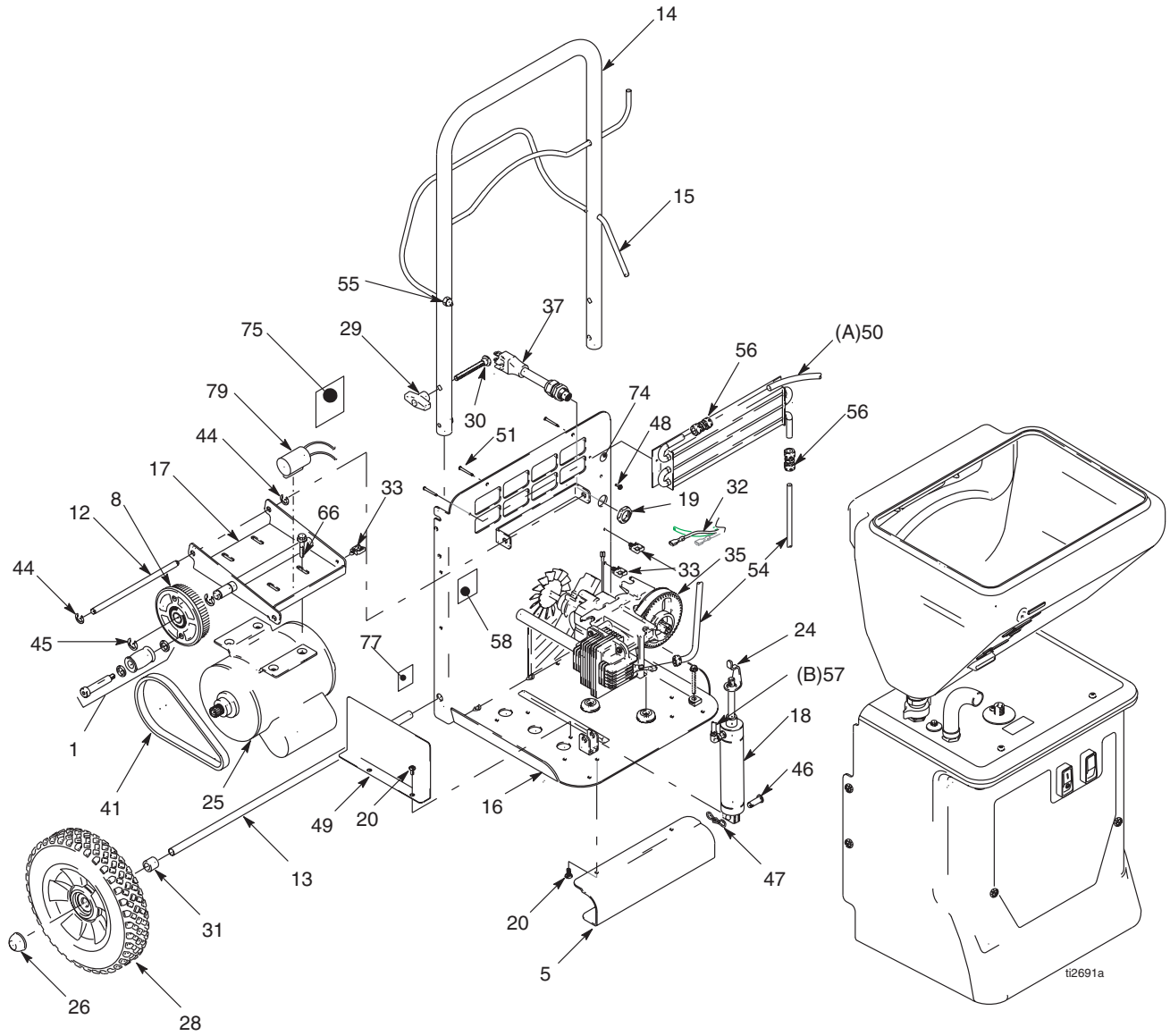

# Parts

## Model 246183, RTX 750

| Ref No. | Part No. | Description                             | Qty | Ref No. | Part No. | Description                                | Qty |
|---------|----------|---|-----|---------|----------|--|-----|
| 1       | 234214   | KIT, roller                             | 1   | 37      | 15B507   | CORD set, power                            | 1   |
| 2       |          | BEARING, ball                           | 2   | 38      | 246544   | GUN, texture, manual 309584                | 1   |
| 3       | 117563   | SWITCH, selector                        | 1   | 39      | 246316   | HOPPER, 6-gallon                           | 1   |
| 4       | 117693   | SWITCH, on/off                          | 1   | 39a     | 15B676   | STORAGE, nozzle                            | 1   |
| 5       | 15B859   | LEG, frame                              | 1   | 39b     | 15B990   | GUARD, burp                                | 1   |
| 6       | 15A903   | PLATE, hose                             | 1   | 39c     | 115099   | GASKET                                     | 1   |
| 8       | 246585   | KIT, pulley, includes 1, 2, 41          | 1   | 41      | 117672   | BELT, GT2, 3mm                             | 1   |
| 9       | 15B409   | PLATE, frame, top                       | 1   | 44      | 101134   | RING, retaining, ext.                      | 2   |
| 10      | 15B872   | SUPPORT, front, frame                   | 1   | 45      | 101242   | RING, retaining, ext                       | 2   |
| 11      | 246580   | KIT, manifold, air, includes 19         | 1   | 46      | 117671   | PIN, clevis                                | 1   |
| 12      | 15B439   | SHAFT, pivot, motor tray                | 1   | 47      | 117668   | PIN, cotter, bow tie                       | 1   |
| 13      | 15B530   | ROD, axle                               | 1   | 48      | 115498   | SCREW, mch, hx wash hd                     | 1   |
| 14      | 15B860   | HANDLE,                                 | 1   | 49      | 15B783   | SHIELD, spray                              | 1   |
| 15      | 15B543   | RACK, hose                              | 1   | 50      | 246578   | KIT, cooler, air, includes 51, 54, 56      | 1   |
| 16      | 15B856   | FRAME, bottom                           | 1   | 51      | 113084   | RIVET, blind                               | 2   |
| 17      | 246189   | TRAY, motor                             | 1   | 52      | 15B823   | TUBE, air                                  | 1   |
| 18      | 246574   | KIT, cylinder, air, includes 24, 46, 47 | 1   | 54      | 15B818   | TUBE, air                                  | 1   |
| 19      | 117625   | NUT, locking                            | 1   | 55      | 115651   | NUT, hex, acorn, 5/16-18                   | 1   |
| 20      | 117630   | SCREW, torx, tri-lob                    | 8   | 56      | 117728   | FITTING, compression, union                | 2   |
| 21      | 117633   | SCREW, slot, hex wash hd                | 6   | 57      | 15B822   | TUBE, air                                  | 1   |
| 22      | 117636   | SCREW, hex hd, flanged                  | 1   | 58▲     | 198492   | LABEL, warning                             | 1   |
| 23      | 234156   | KIT, RotoFlex pump                      | 1   | 59▲     | 290228   | LABEL, caution                             | 1   |
| 24      | 15B529   | ARM, cylinder                           | 1   | 60▲     | 15B883   | LABEL                                      | 1   |
| 25      | 246572   | KIT, motor, AC, includes 41, 66, 79     | 1   | 62      | 103473   | STRAP, tie, wire                           | 2   |
| 26      | 112612   | CAP, hub                                | 2   | 63      | 234222   | HOPPER, texture, 0.75 gal                  | 1   |
| 27      | 113415   | SCREW, mach, torx pan hd                | 1   | 66      | 117791   | SCREW, cap, tri-lobe                       | 4   |
| 28      | 115095   | WHEEL, 9"                               | 2   | 67      | 15B986   | CLIP, spring                               | 1   |
| 29      | 115480   | KNOB, t-handle                          | 2   | 74▲     | 186620   | LABEL, symbol, ground                      | 1   |
| 30      | 116630   | SCREW, carriage                         | 2   | 75▲     | 15C127   | LABEL, instruction                         | 1   |
| 31      | 195367   | SPACER                                  | 2   | 76▲     | 15C128   | LABEL, danger                              | 1   |
| 32      | 15B585   | HARNESS, wiring                         | 1   | 77▲     | 291292   | LABEL, identification                      | 1   |
| 33      | 117727   | CLIP, wire                              | 3   | 78      | 234220   | KIT, material thickness gauge, (not shown) | 1   |
| 34      | 15B865   | SHIELD                                  | 1   | 79      | 244683   | KIT, capacitor                             | 1   |
| 35      | 234211   | KIT, compressor, air, includes 54       | 1   |         |          |  |     |
| 36      | 234147   | KIT, hose                               | 1   |         |          |  |     |

▲ Replacement Danger and Warning labels, tags and cards are available at no cost.

## Parts

Model 246184, RTX 1000

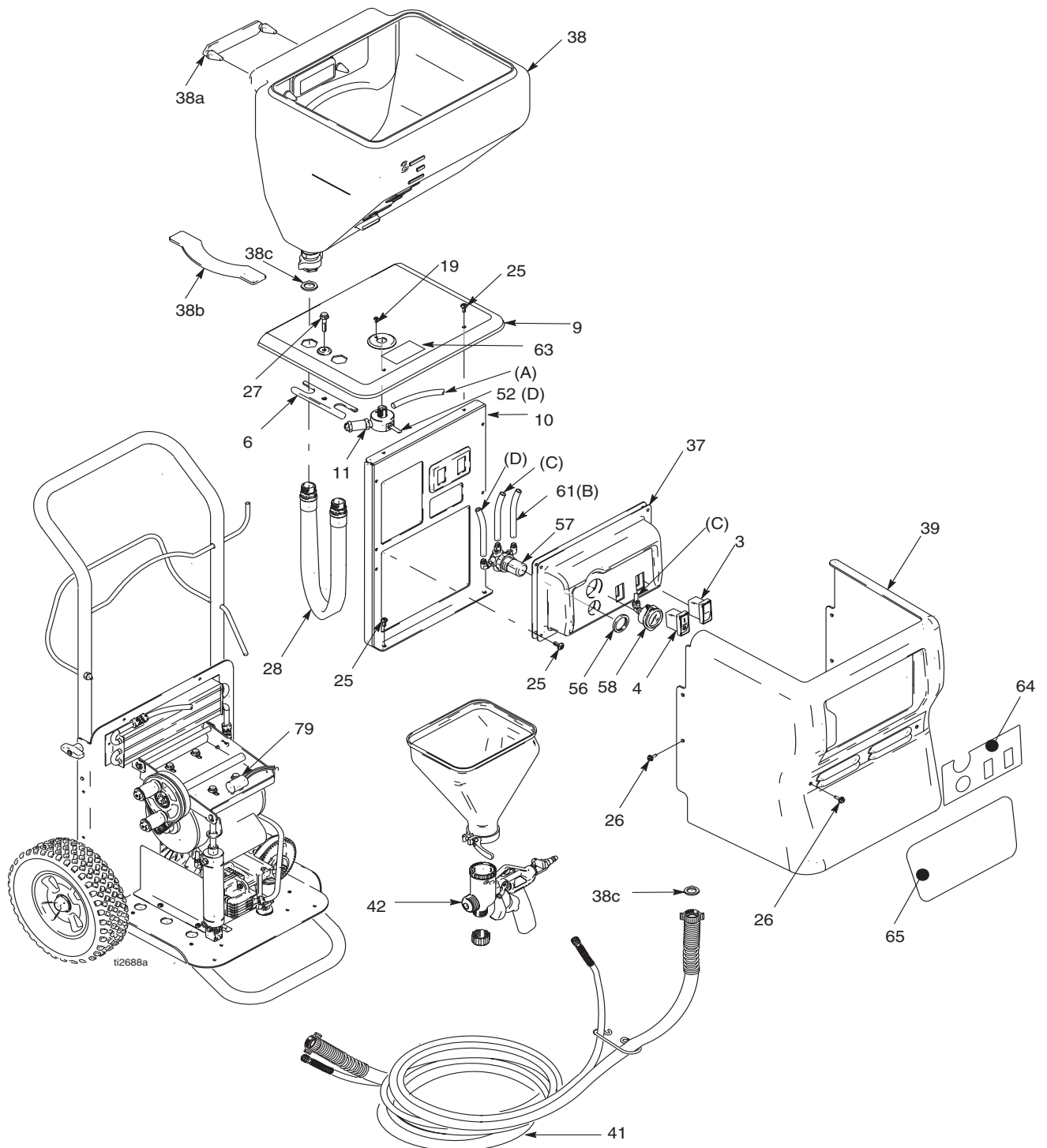

# Parts

## Model 246184, RTX 1000

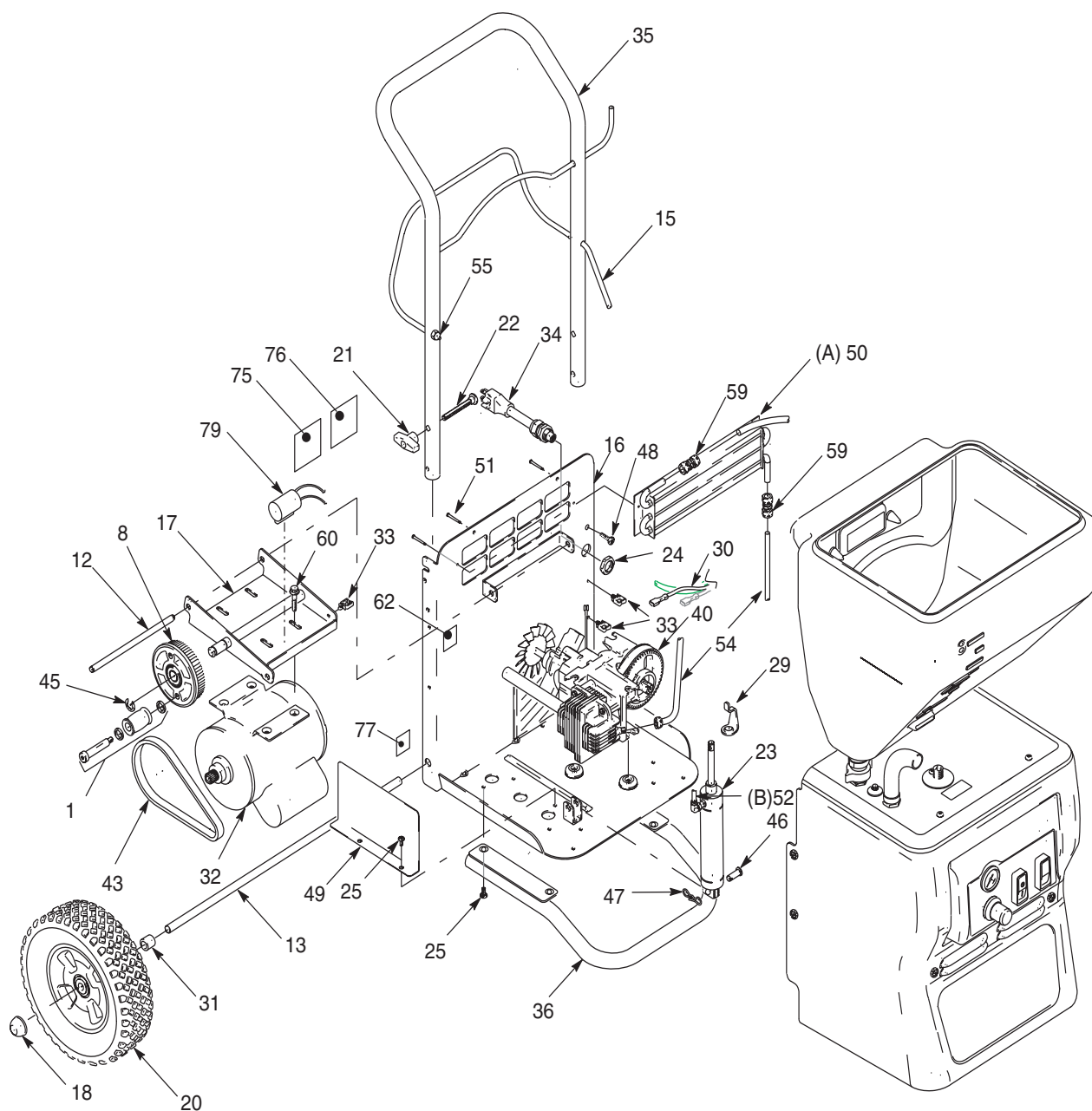



# Parts

## Model 246184, RTX 1000

| Ref No | Part No. | Description                             | Qty | Ref No | Part No. | Description                               | Qty |
|--------|----------|---|-----|--------|----------|---|-----|
| 1      | 234214   | KIT, roller                             | 1   | 38a    | 15B676   | STORAGE, nozzle                           | 1   |
| 2      |          | BEARING, ball                           | 2   | 38b    | 15B990   | GUARD, burp                               | 1   |
| 3      | 117563   | SWTICH, power                           | 1   | 38c    | 115099   | GASKET                                    | 1   |
| 4      | 117693   | SWITCH, power                           | 1   | 39     | 15B867   | SHIELD                                    | 1   |
| 6      | 15A903   | PLATE, hose                             | 1   | 40     | 234211   | KIT, compressor, includes 54, 59          | 1   |
| 8      | 246585   | KIT, pulley, includes 1, 2, 43          | 1   | 41     | 234147   | KIT, hose                                 | 1   |
| 9      | 15B409   | PLATE, frame top                        | 1   | 42     | 246544   | GUN, spray, manual 309584                 | 1   |
| 10     | 15B872   | SUPPORT, front frame                    | 1   | 43     | 117672   | BELT, GT2, 3mm                            | 1   |
| 11     | 246581   | KIT, manifold, air, includes 19         | 1   | 46     | 117671   | PIN, clevis                               | 1   |
| 12     | 15B439   | SHAFT, pivot, motor                     | 1   | 47     | 117668   | PIN, cotter, bow tie                      | 1   |
| 13     | 15B590   | ROD, axle                               | 1   | 48     | 115498   | SCREW, mch, slot, hex                     | 1   |
| 15     | 15B543   | RACK, hose                              | 1   | 49     | 15B783   | SHIELD, spray                             | 1   |
| 16     | 15B856   | FRAME, bottom                           | 1   | 50     | 246578   | KIT, cooler, air, includes 51, 54, 59     | 1   |
| 17     | 246189   | TRAY, motor                             | 1   | 51     | 113084   | RIVET, blind                              | 2   |
| 18     | 112612   | CAP, hub                                | 2   | 52     | 15B823   | TUBE, air                                 | 1   |
| 19     | 113415   | SCREW, mach, torx pan hd                | 1   | 54     | 15B818   | TUBE, air                                 | 1   |
| 20     | 115094   | WHEEL, 10"                              | 2   | 55     | 115651   | NUT, hex, acorn 5/16-18                   | 1   |
| 21     | 115480   | KNOB, t-handle                          | 2   | 56     | 115244   | NUT, regulator                            | 1   |
| 22     | 116630   | SCREW, carriage                         | 2   | 57     | 115242   | REGULATOR, air, 1/4 npt                   | 1   |
| 23     | 246575   | KIT, cylinder, air, includes 29, 46, 47 | 1   | 58     | 117720   | GAUGE, pressure                           | 1   |
| 24     | 117625   | NUT, locking                            | 1   | 59     | 117728   | FITTING, compression                      | 2   |
| 25     | 117630   | SCREW, torx, tri lob                    | 16  | 60     | 117791   | SCREW, motor                              | 4   |
| 26     | 117633   | SCREW, slot hex wash hd                 | 6   | 61     | 15B822   | TUBE, air                                 | 1   |
| 27     | 117636   | SCREW, hx hd, flanged                   | 1   | 62▲    | 198492   | LABEL, warning                            | 1   |
| 28     | 234156   | KIT, RotoFlex pump                      | 1   | 63▲    | 290228   | LABEL, caution                            | 1   |
| 29     | 15B529   | ARM, cylinder                           | 1   | 64▲    | 15B886   | LABEL, model, upper                       | 1   |
| 30     | 15B585   | HARNESS, wiring                         | 1   | 65▲    | 15B887   | LABEL, model, lower                       | 1   |
| 31     | 195367   | SPACER                                  | 2   | 75▲    | 15C127   | LABEL, instructions                       | 1   |
| 32     | 246572   | KIT, motor, AC, includes 43, 60, 79     | 1   | 76▲    | 15C128   | LABEL, danger                             | 1   |
| 33     | 117727   | CLIP, wire                              | 3   | 77▲    | 291292   | LABEL, serial number                      | 1   |
| 34     | 15B507   | CORD set, power                         | 1   |        | 234220   | KIT, material thickness gauge (not shown) | 1   |
| 35     | 287051   | HANDLE                                  | 1   | 79     | 244683   | KIT, capacitor                            | 1   |
| 36     | 15B541   | LEG                                     | 1   |        |          |   |     |
| 37     | 15B542   | PANEL, control                          | 1   |        |          |   |     |
| 38     | 246317   | HOPPER, 8-gallon                        | 1   |        |          |   |     |

▲ Replacement Danger and Warning labels, tags and cards are available at no cost.

## Technical Data

|  |  |
|--|--|
| Main unit power requirements . . . . .   | 120V AC, 60 hz, 15A, 1 phase                   |
| Maximum fluid working pressure . . . . . | 60 psi, (4.137 bar)                            |
| Maximum air working pressure. . . . .    | 45 psi (3.1 bar)                               |
| Compressor specifications . . . . .      | Universal motor thermally protected, oil-less  |
| Compressor air displacement. . . . .     | 4.5 displacement scfm at 30 psi                |
| Generator required . . . . .             | 3500 w minimum                                 |
| Electric Motor                           |  |
| Material pump motor . . . . .            | Capacitor start, 1/3 hp AC, 2.8 amp open frame |
| Compressor motor. . . . .                | Universal AC 10.5 amp                          |
| Power Cord. . . . .                      | 16 AWG, 3 wire, 25 ft.                         |
| Material hopper capacity . . . . .       | Sprayer Material Hopper: 6 gallons             |
|  | Gun material hopper: 3/4 gallon                |
| Maximum delivery with texture . . . . .  | 0.75-1 gpm (2.8-3.8 liter)                     |
| RTX 750 Dimensions and Weight            |  |
| Length . . . . .                         | 23 in. (584 mm) with handle                    |
| Width . . . . .                          | 23 in. (584 mm)                                |
| Height . . . . .                         | 39 in. (991 mm)                                |
| Weight without hoses or gun . . . . .    | 75 lbs (34 kg)                                 |
| RTX 1000 Dimensions and Weight           |  |
| Length . . . . .                         | 23 in. (584 mm) with handle                    |
| Width . . . . .                          | 23 in. (584 mm)                                |
| Height . . . . .                         | 42 in. (1067 mm)                               |
| Weight without hoses or gun . . . . .    | 80 lbs (36 kg)                                 |
| Wetted parts . . . . .                   | brass, aluminum, plastic                       |
| Sound data                               |  |
| Sound pressure level* . . . . .          | 83.2 dB(A)                                     |
| Sound power level** . . . . .            | 97.5 dB(A)                                     |
| Storage Temperature Range . . . . .      | 35°F - 160°F (1.6°C - 71°C)                    |
| Operating Temperature Range . . . . .    | 40°F - 115°F (4°C - 46°C)                      |
| Gun:                                     |  |
| Maximum Working Pressure . . . . .       | 60 psi (4.137 bar)                             |
| Air Maximum Working Pressure . . . . .   | 100 psi (6.895 bar)                            |
| CFM Rating . . . . .                     | 3.5 - 11 CFM                                   |
| Weight . . . . .                         | 1.1 lbs (500 grams)                            |

\* Measured while spraying at 1 m.

\*\* Measured per ISO-3744

NOTES



A series of horizontal lines for writing notes, starting from the first line below the pencil icon and continuing down the page.

# Graco Warranty

Graco warrants all equipment referenced in this document which is manufactured by Graco and bearing its name to be free from defects in material and workmanship on the date of sale by an authorized Graco distributor to the original purchaser for use. With the exception of any special, extended, or limited warranty published by Graco, Graco will, for a period of twelve months from the date of sale, repair or replace any part of the equipment determined by Graco to be defective. This warranty applies only when the equipment is installed, operated and maintained in accordance with Graco's written recommendations.

Graco warrants all equipment referenced in this document which is manufactured by Graco and bearing its name to be free from defects in material and workmanship on the date of sale by an authorized Graco distributor to the original purchaser for use. With the exception of any special, extended, or limited warranty published by Graco, Graco will, for a period of twelve months from the date of sale, repair or replace any part of the equipment determined by Graco to be defective. This warranty applies only when the equipment is installed, operated and maintained in accordance with Graco's written recommendations.

This warranty does not cover, and Graco shall not be liable for general wear and tear, or any malfunction, damage or wear caused by faulty installation, misapplication, abrasion, corrosion, inadequate or improper maintenance, negligence, accident, tampering, or substitution of non-Graco component parts. Nor shall Graco be liable for malfunction, damage or wear caused by the incompatibility of Graco equipment with structures, accessories, equipment or materials not supplied by Graco, or the improper design, manufacture, installation, operation or maintenance of structures, accessories, equipment or materials not supplied by Graco.

This warranty is conditioned upon the prepaid return of the equipment claimed to be defective to an authorized Graco distributor for verification of the claimed defect. If the claimed defect is verified, Graco will repair or replace free of charge any defective parts. The equipment will be returned to the original purchaser transportation prepaid. If inspection of the equipment does not disclose any defect in material or workmanship, repairs will be made at a reasonable charge, which charges may include the costs of parts, labor, and transportation.

**THIS WARRANTY IS EXCLUSIVE, AND IS IN LIEU OF ANY OTHER WARRANTIES, EXPRESS OR IMPLIED, INCLUDING BUT NOT LIMITED TO WARRANTY OF MERCHANTABILITY OR WARRANTY OF FITNESS FOR A PARTICULAR PURPOSE.**

Graco's sole obligation and buyer's sole remedy for any breach of warranty shall be as set forth above. The buyer agrees that no other remedy (including, but not limited to, incidental or consequential damages for lost profits, lost sales, injury to person or property, or any other incidental or consequential loss) shall be available. Any action for breach of warranty must be brought within two (2) years of the date of sale.

**GRACO MAKES NO WARRANTY, AND DISCLAIMS ALL IMPLIED WARRANTIES OF MERCHANTABILITY AND FITNESS FOR A PARTICULAR PURPOSE, IN CONNECTION WITH ACCESSORIES, EQUIPMENT, MATERIALS OR COMPONENTS SOLD BUT NOT MANUFACTURED BY GRACO.** These items sold, but not manufactured by Graco (such as electric motors, switches, hose, etc.), are subject to the warranty, if any, of their manufacturer. Graco will provide purchaser with reasonable assistance in making any claim for breach of these warranties.

In no event will Graco be liable for indirect, incidental, special or consequential damages resulting from Graco supplying equipment hereunder, or the furnishing, performance, or use of any products or other goods sold hereto, whether due to a breach of contract, breach of warranty, the negligence of Graco, or otherwise.

**TO PLACE AN ORDER OR FOR SERVICE**, contact your Graco distributor,  
or call 1-800-690-2894 to identify the nearest distributor.

All written and visual data contained in this document reflects the latest product information available at the time of publication.  
Graco reserves the right to make changes at any time without notice.

**Sales Offices:** Minneapolis, Detroit  
**International Offices:** Belgium, Korea, Hong Kong, Japan  
PRINTED IN USA 309586 1/2003, Rev. 4/2003