

# LubePro<sup>®</sup> 4-Way Valve Kit

335015B

EN

For use with LubePro<sup>®</sup> 26:1 Grease Pumps and LubePro 19:1 Oil Pumps with a maximum air input pressure of 150 psi (10.34 bar, 1.03 MPa) only. For professional use only.

**Part No.:**

- 24Y079 - 12VDC
- 24Y080 - 24VDC
- 24Y081 - 110VAC
- 24Y082 - 220VAC

*Maximum Working Pressure: 150 psi (10.34 bar, 1.03 MPa)*



**Important Safety Instructions**

Read all warnings and instructions in this manual and in the LubePro 26:1 Grease Pump or LubePro 19:1 Oil Pump Manual. Save all instructions.

Ref	Description	Qty
1	VALVE, 12VDC	1
	VALVE, 24VDC	1
	VALVE, 110VAC	1
	VALVE, 220VAC	1
2	BRACKET	1
3	SCREWS	2
4	WASHERS, lock	2
5	SCREWS, set	2
6	FITTING, straight	1
7	FITTINGS, elbow	3
8	TUBING, 4 ft, round, nylon	1

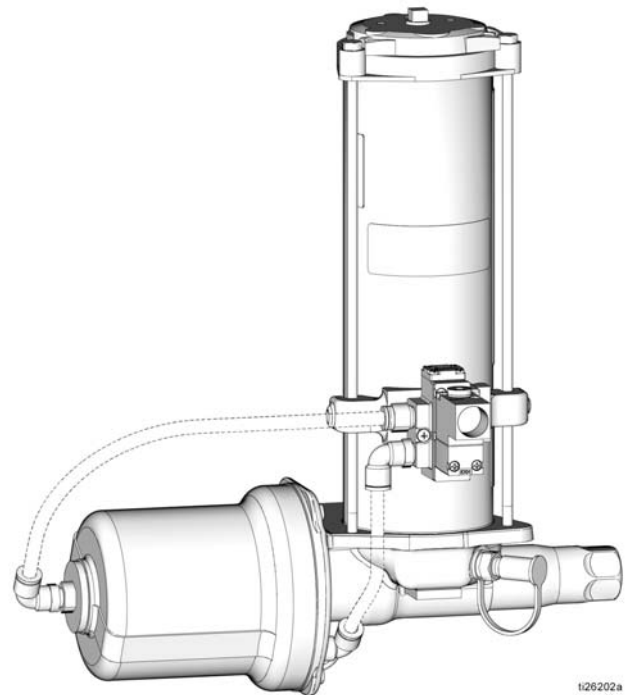

t26202a

# Instructions

**NOTE:**

- Install all components in the order shown.
- If installing the valve kit in a new installation location, begin procedure on Step 4.
- If installing the valve kit on a pump that is already installed in a lubrication system, begin installation on Step 1.

## Installation Procedure

Grounding is necessary when voltages above 30 VAC or 42 VDC are used for the low level switch or an air valve is attached to the pump. Improper grounding can cause electric shock. Grounding reduces the risk of electric shock by providing an escape wire for the electric current in the event of malfunction or breakdown.						

1. Disconnect power to controller and disconnect installed air valve from controller.
2. Use the following Pressure Relief Procedure, to relieve pressure.

### Pressure Relief Procedure

This equipment stays pressurized until pressure is manually relieved. To help prevent serious injury from pressurized fluid, such as skin injection, splashing fluid and moving parts, follow the Pressure Relief Procedure when you stop dispensing and before cleaning, checking, or servicing the equipment.					

- a. Close the bleed-type master air valve (required in the system).
  - b. **Slowly** loosen air line fittings and disconnect air lines.
- NOTE:** Air may be trapped in the air lines and expelled when fittings are opened.
3. Remove and discard the installed air valve and air lines according to all regulations for disposal of this equipment.
  4. Install the straight fitting (6), one elbow fitting (7) and a user supplied, 1/4 NPT fitting (f) in the valve (1) as shown in FIG. 1.

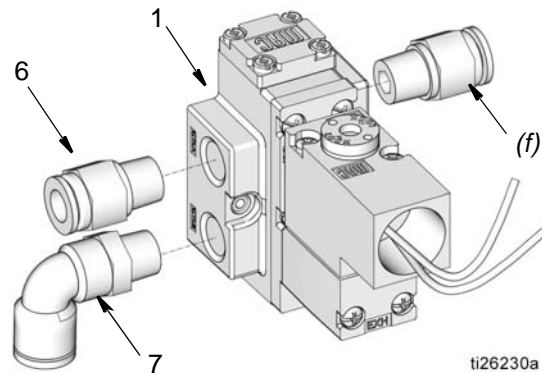

**FIG. 1**

5. Install valve (1) to bracket (2) using screws (3) and lock washers (4) (FIG. 2). Use a wrench to tighten securely.

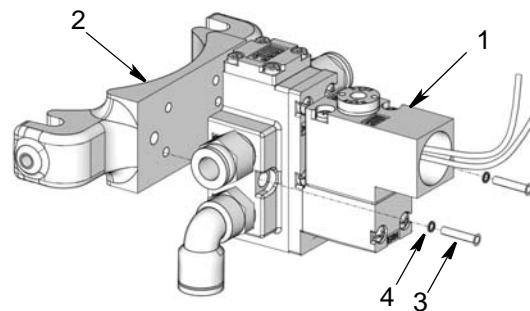

**FIG. 2**

6. Install valve (1) / bracket (2) assembly to pump tie rods (tr) (FIG. 3). Use a hex wrench to tighten set screws (5).

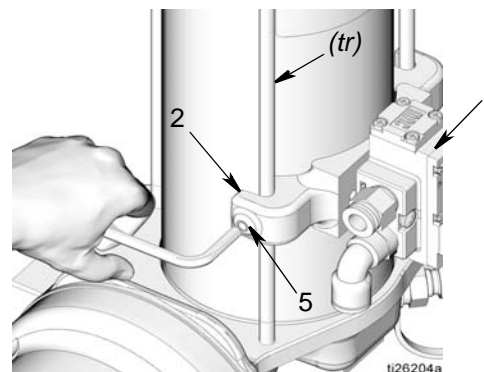

**FIG. 3**

7. Install elbow fittings (7) to pump air inlets in the air cylinder (FIG. 4) and pump base (FIG. 5).

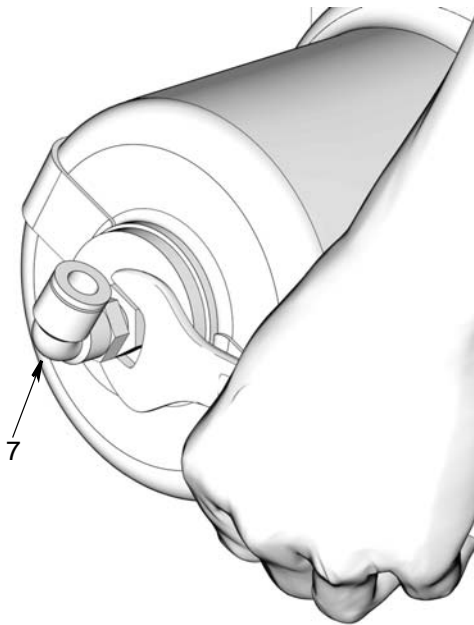

**FIG. 4: Air Cylinder**

8. Cut tubing (8) as needed for installation between the air inlet elbow (7a) installed on the air cylinder and the valve fitting (6) and between the air inlet elbow (7b) installed in the pump and valve fitting (7c) (FIG. 6).

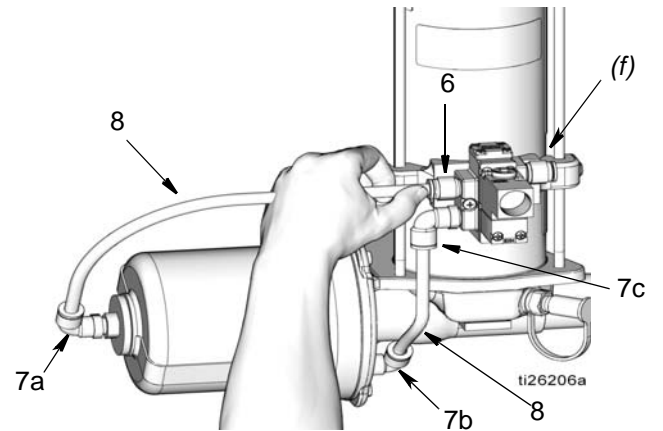

**FIG. 6**

9. Connect the system's main air line to fitting (f) (user supplied) (FIG. 6).
10. Make all electric connections between controller and valve.

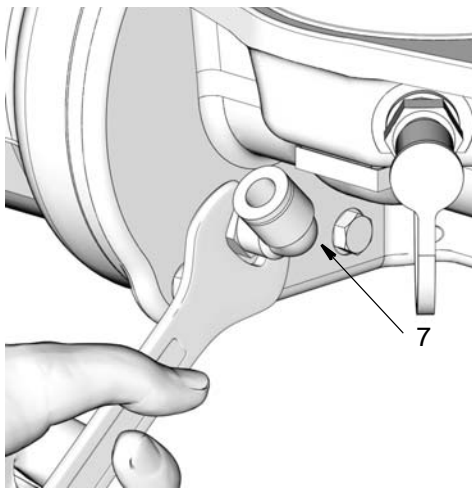

**FIG. 5: Pump Base**

## Graco Information

For the latest information about Graco products, visit [www.graco.com](http://www.graco.com).

**TO PLACE AN ORDER**, contact your Graco distributor or call to identify the nearest distributor.

**Phone:** 612-623-6928 or **Toll Free:** 1-800-533-9655, **Fax:** 612-378-3590

*All written and visual data contained in this document reflects the latest product information available at the time of publication.  
Graco reserves the right to make changes at any time without notice.*

*For patent information, see [www.graco.com/patents](http://www.graco.com/patents).*

Original instructions. This manual contains English. MM 335015

**Graco Headquarters:** Minneapolis

**International Offices:** Belgium, China, Japan, Korea

**GRACO INC. AND SUBSIDIARIES • P.O. BOX 1441 • MINNEAPOLIS MN 55440-1441 • USA**

**Copyright 2015, Graco Inc. All Graco manufacturing locations are registered to ISO 9001.**

[www.graco.com](http://www.graco.com)

August 2016