

## 190, 210, 290, 390 Fan Replacement Kit

3A3093A

EN





### IMPORTANT SAFETY INSTRUCTIONS

For detailed sprayer information and warnings, see the Owners manual included with your sprayer.

## Pressure Relief Procedure

### ⚠ WARNING

**SKIN INJECTION HAZARD:** This sprayer is capable of producing 3000 psi (21 MPa, 207 bar) during use. Follow this **Pressure Relief Procedure** whenever you stop spraying and before cleaning, checking, servicing, or transporting equipment to prevent serious injury.

						
To help prevent injection injuries, follow this procedure when you stop spraying and before you service or clean the sprayer, remove parts, or repair leaks.						

1. Turn ON/OFF switch to **OFF** position.
2. Unplug sprayer.
3. Engage trigger lock.
4. Turn prime/spray knob (A) down to the PRIME/DRAIN position.

Hold metal part of gun firmly to a grounded metal pail. Pull gun trigger to relieve pressure.

## Disassembly

1. Remove the two machine screws (12) that secure the motor shield (23), save the screws.
2. Slide motor shield (23) off the motor and set aside.

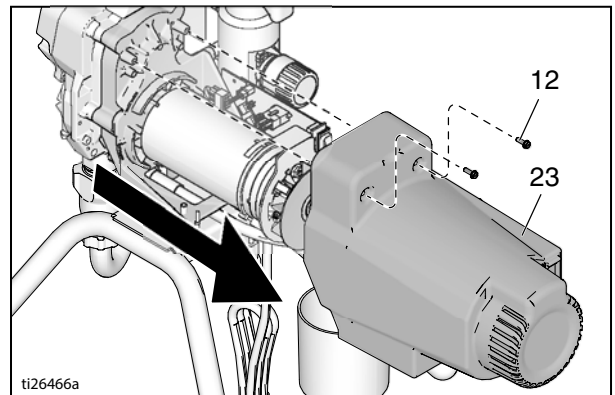

3. Pry fan retainer (54b) off the motor shaft with a small screwdriver.

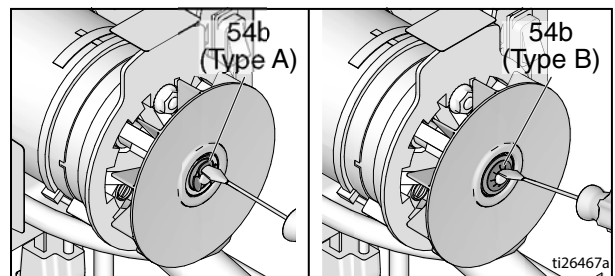

4. Remove and discard old retainer (54b), washer (54c), fan, and shaft adapter (54d). Shaft adapter Type A requires a 5/64" hex key to loosen the setscrew.

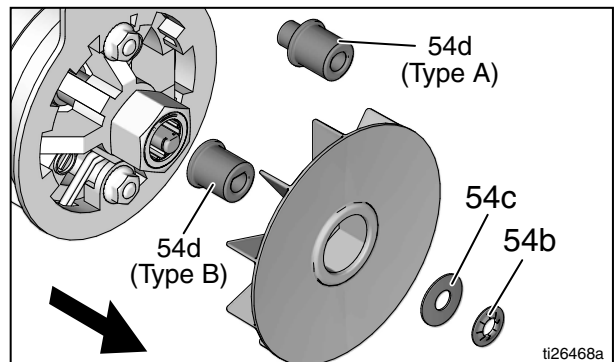

## Assembly

1. Install shaft adapter (54d) on to the motor shaft.

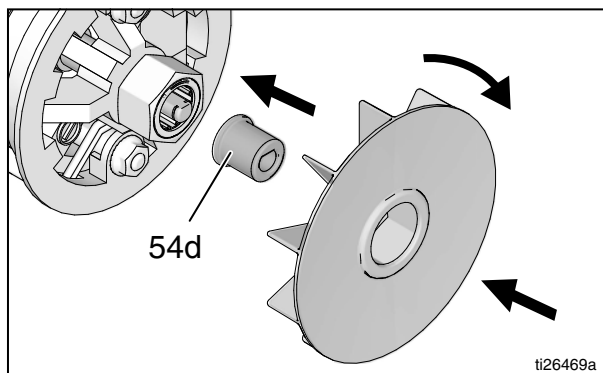

2. Rotate fan clockwise while sliding fan onto shaft adapter (54d) with the fins facing the motor. Slide wave washer (54c) onto motor shaft.

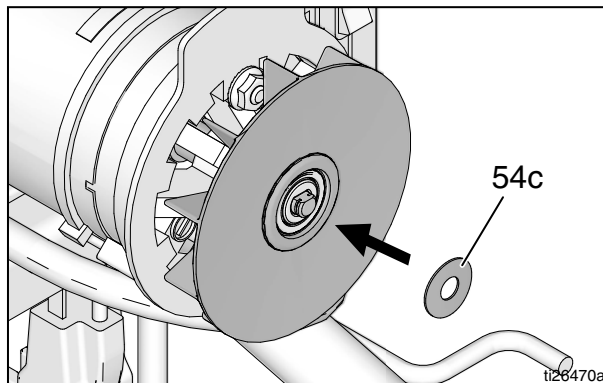

3. Place a push nut (54b) on a 3/8" or 10mm socket.

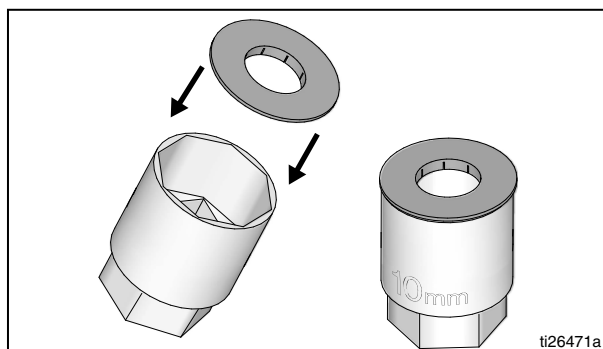

4. Position the push nut and socket at the end of the motor shaft. Use a small or light (8 oz./225g) hammer to drive the push nut onto the shaft compressing the wave washer.

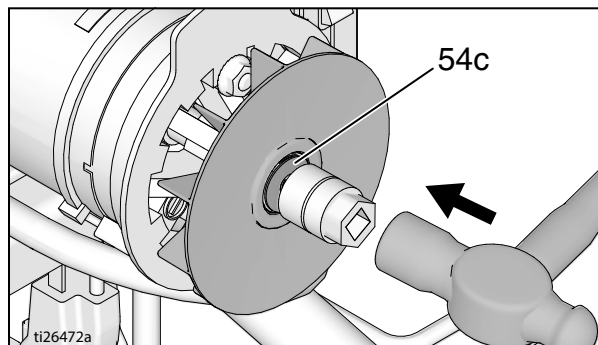

5. Slide motor shield (23) over the motor.
6. Secure the motor shield (23) using the two machine screws (12) removed earlier. Torque to 23–27 in-lb (2.6–3.1 N•m)

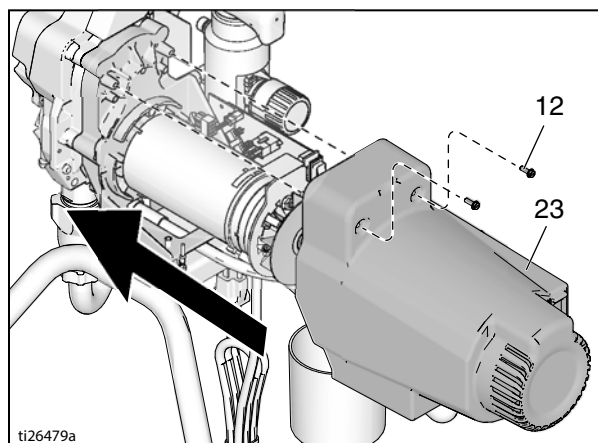

All written and visual data contained in this document reflects the latest product information available at the time of publication. Graco reserves the right to make changes at any time without notice. For patent information, see [www.graco.com/patents](http://www.graco.com/patents).

Original instructions. This manual contains English. MM 3A3093

**Graco Headquarters:** Minneapolis, **International Offices:** Belgium, China, Japan, Korea  
**GRACO INC. AND SUBSIDIARIES • P.O. BOX 1441 • MINNEAPOLIS MN 55440-1441 • USA**  
**Copyright 2015, Graco Inc. All Graco manufacturing locations are registered to ISO 9001.**  
[www.graco.com](http://www.graco.com) Revision A - May 2015