

GENUINE GRACO PARTS AND ACCESSORIES

221134 CARBIDE BALL AND SEAT CONVERSION KIT



For 400 and 1200 Series Glutton® Pumps



Important Safety Instructions

Read all warnings and instructions in manual 307843. Save all instructions.

405856C

ENG



WARNING

Pressure Relief Procedure

To reduce risk of serious bodily injury, including fluid injection, splashing fluid or solvent in eyes or on skin, always shut off air to pump, hold metal part of gun firmly to grounded metal waste container, trigger it, engage gun safety latch, and open pump drain valve, to relieve all system pressure before checking, adjusting, cleaning or repairing any part.

NOTE: Parts included in kit are referenced with part numbers. Use all parts in the kit for the best results.

1. Follow **Pressure Relief Procedure Warning**.
2. Disassemble the ball check valves.
3. Lubricate o-rings (103341) and place one in groove on each valve seat.
4. Install valve seat with o-ring facing down, ball guide, and ball (108286) into each outlet housing.
5. Lubricate o-rings (108822) and cap threads. Place one o-ring on each cap. Screw caps into housing and torque to 55-85 ft-lb (75-115 N•m).

Graco Inc. P.O. Box 1441 Minneapolis, MN 55440-1441

Original instructions. This manual contains English. MM 405856

Copyright 1988, Graco Inc. is registered to ISO 9001, Revised 05/2011

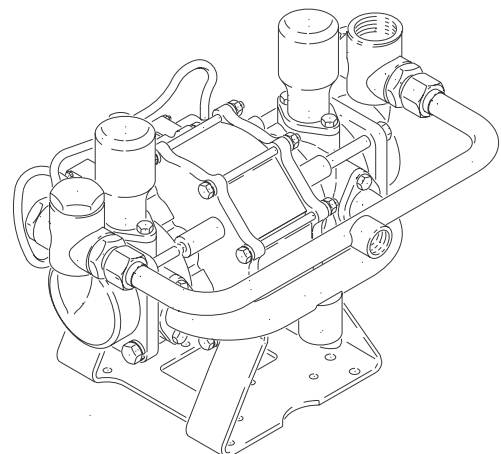
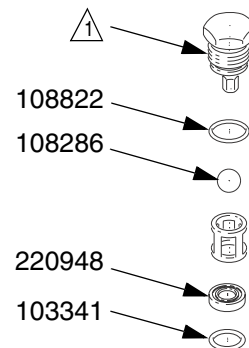

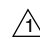
 Lubricate threads. Torque to 55-85 ft-lb (75-115 N•m).