

V-Packing Repair or Conversion Kits

406845D

Merkur™ Bellows Pumps

ENG

**Important Safety Instructions**

Read all warnings and instructions in manuals 312793 and 312795. Save all instructions.

See reverse for parts illustration.

TIP: Some o-rings are close in size. Stack on bench to differentiate.

Ref.	Description	OD in. (mm)			Qty.
		24A655 (Standard) and 24J858 (Reinforced PTFE Seals)† for LB050x (50cc)	24A656 (Standard) and 24J859 (Reinforced PTFE Seals)† for LB100x (100cc)	24A657 (Standard) and 24J860 (Reinforced PTFE Seals)† for LB150x (150cc)	
101	SPRING, piston				1
102	GLAND, male, piston				1
103	V-PACKING, piston, UHMWPE	1.7 (43)	2.2 (56)	2.6 (66)	3
104	V-PACKING, piston, PTFE				2
105	GLAND, female, piston				1
106	O-RING, foot cap	1.8 (46)	2.4 (61)	2.7 (69)	1
107	SPRING, throat				1
108	GLAND, male, throat				1
109	V-PACKING, throat, UHMWPE	1.3 (33)	1.6 (41)	1.9 (48)	3
110	V-PACKING, throat, PTFE				2
111	GLAND, female, throat				1
112	O-RING, packing nut bottom	1.6 (41)	2.0 (51)	2.3 (58)	1
113	O-RING, packing nut top	1.9 (48)	1.9 (48)	1.9 (48)	1
114	O-RING, bellows chamber	2.5 (64)	2.5 (64)	2.5 (64)	1
115*	O-RING, piston	0.6 (15)	0.8 (20)	0.8 (20)	1
116†	PACKING, throat, reinforced PTFE	1.7 (43)	2.2 (56)	2.6 (66)	5
117†	PACKING, piston, reinforced PTFE	1.3 (33)	1.6 (41)	1.9 (48)	5

* May not be used. Piston and rod may separate during disassembly. If separated, always replace the o-ring before reassembly.

† Optional packing kit. See illustration on reverse. Use with materials that cause chemical compatibility concerns with UHMWPE, such as acid catalyst materials.

Graco Inc. P.O. Box 1441 Minneapolis, MN 55440-1441

Original instructions. This manual contains English. MM 406845

Copyright 2010, Graco Inc. is registered to ISO 9001

Revised 06/2011

NOTE: Full disassembly shown. Disassemble only as far as needed for the parts being replaced.

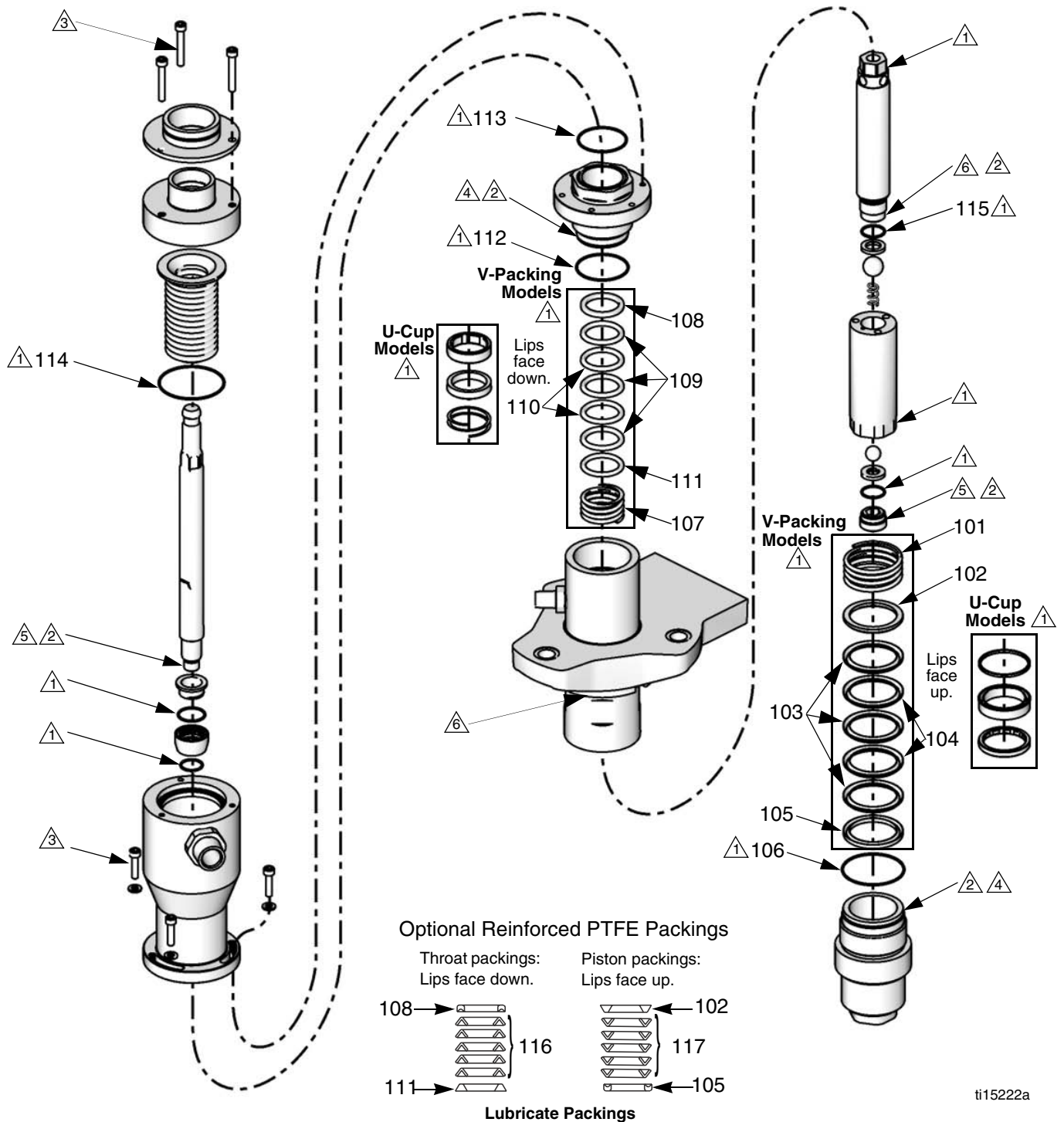

ti15222a

① Apply grease.

② Apply thread lubricant.

④ Torque to 54-66 ft-lb (73-89 N•m).

⑥ Torque to 91-109 ft-lb (123-148 N•m).

③ Torque to 100-120 in-lb (11-14 N•m).

⑤ Torque to 74-86 ft-lb (100-117 N•m).