

Bellows Kit with Seals

406852D

Merkur™ Bellows Pumps

ENG



Important Safety Instructions

Read all warnings and instructions in manuals 312793 and 312795. Save all instructions.

See reverse for parts illustration.

TIP: Some o-rings are close in size. Stack on bench to differentiate.

Kits 24A267 (Standard) and 24J850 (PTFE)◆ LB050x (50cc) pumps

Ref	Description	OD in. (mm)	Qty
101	BELLOWS, UHMWPE, Kit 24A267		1
	BELLOWS, PTFE, Kit 24J850		
102	O-RING, snap bushing	0.9 (23)	1
103*	O-RING, packing nut top	1.9 (48)	1
104*	O-RING, packing nut bottom	1.6 (41)	1
105	O-RING, bellows chamber	2.5 (64)	1
106	O-RING, snap bushing, FKM	1.1 (28)	1
107	O-RING, foot cap, (see page 2)	1.8 (46)	1
108**	O-RING, piston	0.6 (15)	1

Kits 24E764 (Standard) and 24J851 (PTFE)◆ LB100x (100cc) and LB150x (150cc) pumps

Ref	Description	OD in. (mm)	Qty
101	BELLOWS, UHMWPE, Kit 24E764		1
	BELLOWS, PTFE, Kit 24J851		
102	O-RING, snap bushing	0.9 (23)	1
103*	O-RING, packing nut top	1.9 (48)	1
104*†	O-RING, packing nut bottom LB100x (100 cc)	2.0 (51)	1
	LB150x (150 cc)	2.3 (58)	
105	O-RING, bellows chamber	2.5 (64)	1
106	O-RING, snap bushing, FKM	1.1 (28)	1
107†	O-RING, foot cap, (see page 2) LB100x (100 cc)	2.4 (61)	1
	LB150x (150 cc)	2.7 (69)	1
108**	O-RING, piston	0.8 (20)	1

* May not be used. Remove packing nut only if necessary. If removed, replace o-rings before reassembly.

** May not be used. Piston and rod may separate during disassembly. If separated, always replace the o-ring before reassembly.

† Differentiate by size to be sure you use the correct o-rings for your pump model.

◆ Use with materials that cause chemical compatibility concerns with UHMWPE, such as acid catalyst materials.

Graco Inc. P.O. Box 1441 Minneapolis, MN 55440-1441

Original instructions. This manual contains English. MM 406852

Copyright 2010, Graco Inc. is registered to ISO 9001

Revised 6/2011

NOTE: Full disassembly shown. Disassemble only as far as needed for the parts being replaced.

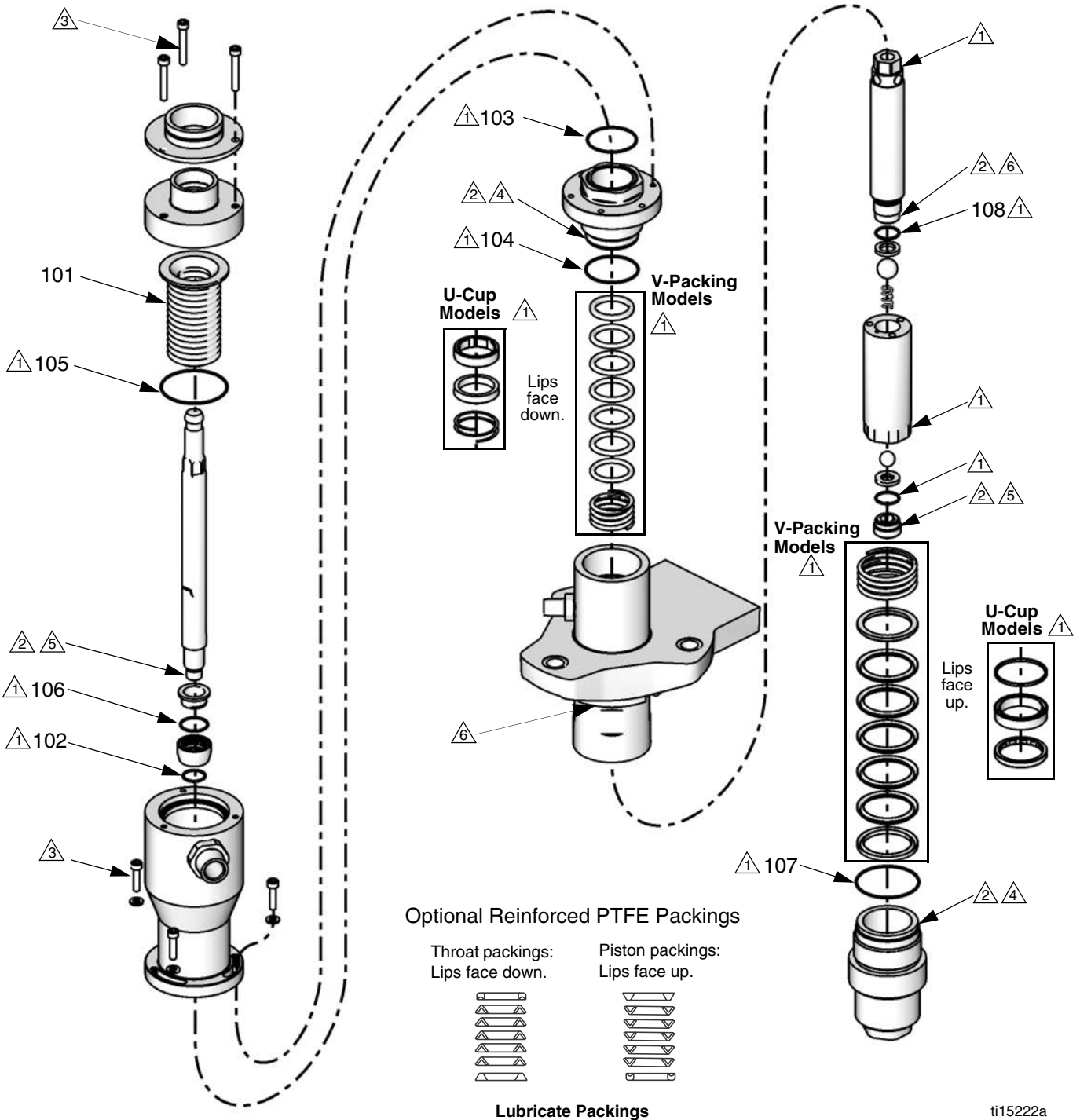

ti15222a

① Apply grease.

② Apply thread lubricant.

④ Torque to 54-66 ft-lb (73-89 N•m).

⑥ Torque to 91-109 ft-lb (123-148 N•m).

③ Torque to 100-120 in-lb (11-14 N•m).

⑤ Torque to 74-86 ft-lb (100-117 N•m).