

# Overflow Chamber Kit

Merkur™ Bellows Pumps

406862A

ENG





### Important Safety Instructions

Read all warnings and instructions in manuals 312793 and 312795. Save all instructions.

Ref.	Description	Qty.
101	LID	1
102	O-RING	1
103	BOTTLE	1
104	FITTING, 2 x 1/4-18 npt	1
105	NUT, retaining	1
106	D-SHAPED SEAL	1

### Kit 24E298

						
---	---	---	--	--	--	--

To avoid the buildup of electrostatic charge, do not rub the plastic bottle with a dry cloth while it is attached to the pump. Remove the bottle to clean, if needed.

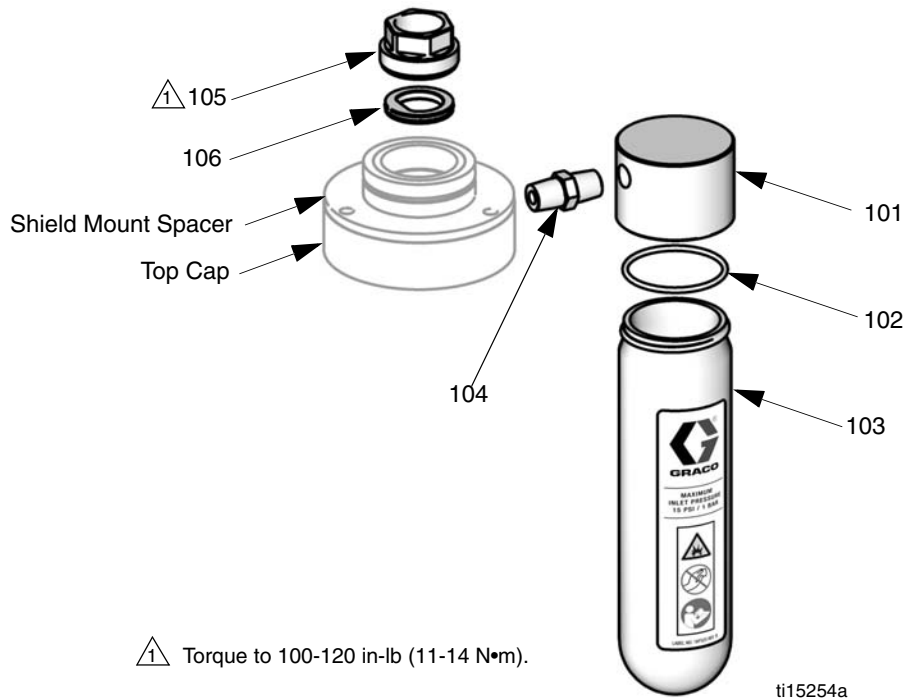

Graco Inc. P.O. Box 1441 Minneapolis, MN 55440-1441

Original instructions. This manual contains English. MM 406862

Copyright 2010, Graco Inc. is registered to ISO 9001

## Preparation/Disassembly



Follow all warnings and instructions in your pump manual to flush the pump, relieve the pressure, and prepare for service.

**Tip:** Tilt the bottle to install or remove.

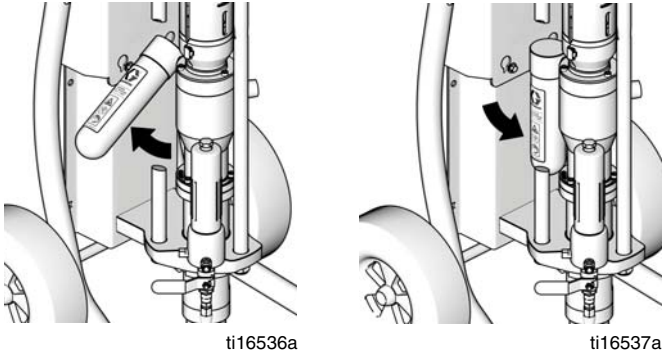

**FIG. 1. Remove/Install Bottle.**

**NOTE:** If replacing an existing overflow chamber that contains fluid, unscrew the bottle (103) and discard.

1. Remove the coupler shield and loosen the screws on the top cap.
2. Hold the coupling nut with a wrench. Use another wrench to turn the motor shaft. To avoid damage to the bellows top cap and the D-shaped seal, **do not turn the coupling nut.**
3. Lower the coupling nut and remove the coupling collars.

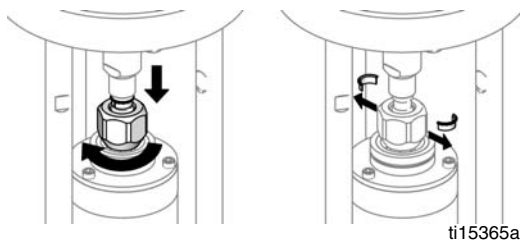
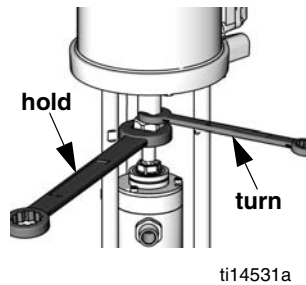

4. Push up the motor shaft. Remove the coupling nut.

**NOTE:** If needed, follow all steps in your displacement pump manual to replace the bellows.

**If installing a new overflow chamber:**

Go to Installation/Reassembly.

**If replacing an existing overflow chamber:**

5. Unscrew the overflow chamber bottle (103) if not already removed. See FIG. 1. Remove fitting (104), with lid (101) attached, from the pump's top cap. Then, remove the lid (101) from the fitting (104), and discard the lid.
6. Remove the retaining nut (105) in the pump's top cap. Remove and discard the D-shaped seal (106).

## Installation/Reassembly

**NOTE:** If the pump was disassembled for service, follow all reassembly steps in your displacement pump manual. Do not install the top cap, shield mount spacer, coupling collars, or coupling nut. Rotate the rod so the flat faces the front of the pump.

1. Set the pump's top cap and spacer on the connecting rod. Do not tighten.
2. Install the new D-shaped seal (106) in the top cap. Hold connecting rod with 19 mm (3/4 in.) wrench. Install and tighten the retaining nut (105). Torque to 100-120 in-lb (11-14 N•m). **Do not overtighten.**
3. Hold the motor shaft up with one hand. With your other hand, put the coupling nut on the rod.
4. Put the coupling collars into the coupling nut so large flanges point upward. Gently let the motor shaft drop onto the displacement rod. Torque the coupling nut (7) to 75-80 ft-lb (138-146 N•m).
5. Turn connecting rod to align holes in top cap with holes on bellows chamber so the D-flat in the top cap faces the front of the pump. Reattach the top cap and spacer. Torque screws to 100-120 in-lb (11-14 N•m).
6. Insert the o-ring (102) and fitting (104) onto the lid (101) of the overflow chamber. Install lid assembly on the pump's top cap. Hand tighten until cap aligns for bottle installation. **Do not overtighten.**
7. Screw the new bottle (103) onto the lid (101) and rotate into position. See FIG. 1.