

## Repair Parts for Check-Mate<sup>®</sup> 250cc Displacement Pumps

312469G

EN

---

**With priming piston and Severe Duty<sup>®</sup> or MaxLife<sup>®</sup> rod and cylinder.  
For professional use only.  
Not for use in explosive atmospheres.**



### **Important Safety Instructions**

Read all warnings and instructions in manual 312375. Save those instructions.



See manual 312375 for complete disassembly and reassembly instructions.

**KEY:**

- ⚠ Torque to 239-271 ft-lb (323-366 N•m)
- ⚠ Torque to 95-115 ft-lb (128-155 N•m)
- ⚠ Torque to 345-435 ft-lb (466-587 N•m)
- ⚠ Torque to 71-79 ft-lb (96-107 N•m)
- ⚠ Torque to 92-102 ft-lb (124-138 N•m)
- ⚠ Torque to 57-63 ft-lb (77-85 N•m)
- ⚠ Torque to 130-190 ft-lb (176-258 N•m)
- ⚠ Apply thread sealant
- L: Piston Check Valve Assembly
- M: Throat Packings
- N: Intake Valve Packings

Lubricate all soft seal components before installation.

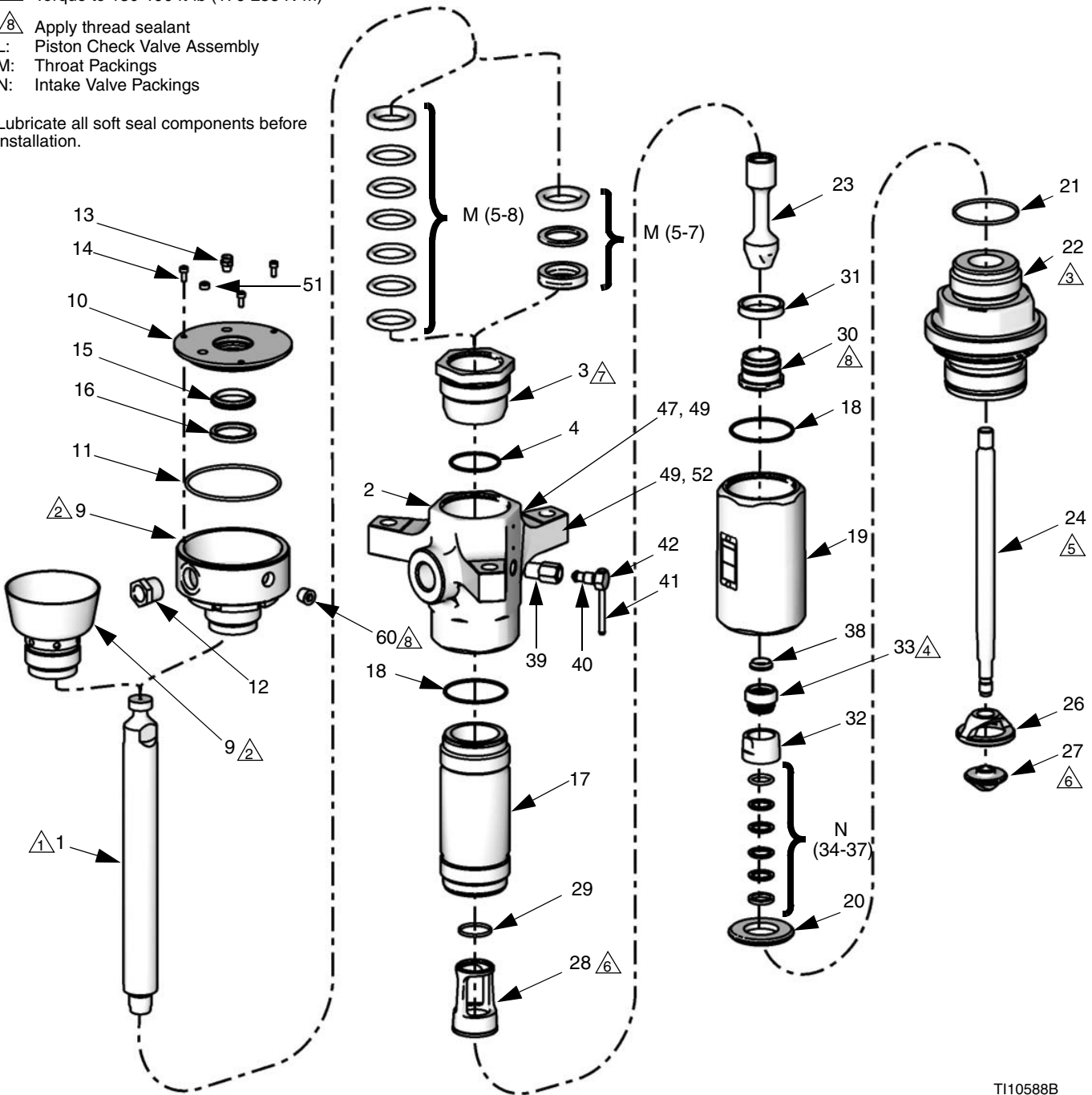

TI10588B

**Parts**

Ref.	Part	Description	Qty.
1	★✱255573	KIT, rod, displacement; chrome (includes 18, 21)	1
	✱✱255574	KIT, rod, displacement; MaxLife (includes 18, 21)	1
2	★✱255605	KIT, outlet, housing (includes 18, 21, 47, 49, 52)	1
	✱✱255606	KIT, outlet, housing, SST (includes 18, 21, 47, 49, 52)	1
3	★✱189641	CARTRIDGE	1
	✱✱189645	CARTRIDGE; SST	1
4‡	166073	O-RING	1
5‡	★✱	GLAND, packing female; see <b>Packing Kits</b>	1
	✱✱	GLAND, packing, u-cup; see <b>Packing Kits</b>	1
6‡	★✱	V-PACKING; PTFE; see <b>Packing Kits</b>	3
	✱✱	SPACER, u-cup; see <b>Packing Kits</b>	1
7‡	★✱	V-PACKING; UHMWPE; see <b>Packing Kits</b>	2
	✱✱	SPACER, acetal; see <b>Packing Kits</b>	1
8‡	★✱	GLAND, packing male; see <b>Packing Kits</b>	1
9‡	★	NUT, packing, open	1
	✱	CUP, wet, enclosed	1
	✱✱	CUP, wet; SST	1
10‡	✱✱	COVER, wet cup	1
11‡	✱✱104095	O-RING	1
12‡	✱✱	SIGHTGLASS	1
13‡	✱✱	COVER, oil hole	1
14‡	✱✱	SCREW, socket hd cap; M5 x 12	3
15‡	✱✱	WIPER, wet cup cover	1
16‡	✱✱	SEAL, wet cup cover	1
17‡	★✱	CYLINDER, pump	1
	✱✱	CYLINDER, pump, MaxLife	1
18‡	109499	O-RING	2
19	★✱237978	HOUSING, valve	1
	✱✱237979	HOUSING, valve; SST	1
20‡		SEAT, valve	1
21‡	189492	SEAL,	1
22	★✱255611	KIT, intake housing (includes 21)	1
	✱✱255612	KIT, intake housing; SST (includes 21)	1
23‡		SEAT, piston	1
24‡	★✱	ROD, piston	1
	✱✱	ROD, piston; MaxLife	1
26	276378	PISTON	1
27	190241	SEAT, piston	1
28	★✱15M655	GUIDE, piston	1
	✱✱15M523	GUIDE, piston; SST	1
29‡		BEARING, guide	1

Ref.	Part	Description	Qty.
30‡		SEAT, piston	1
31‡		SEAL, piston; see <b>Packing Kits</b>	1
32‡		VALVE, intake	1
33‡	★✱	NUT, packing	1
	✱✱	NUT, packing; SST	1
34‡		GLAND, male, piston; SST; see <b>Packing Kits</b>	1
35‡		V-PACKING; see <b>Packing Kits</b>	2
36‡	★✱	V-PACKING; PTFE; see <b>Packing Kits</b>	2
	✱✱	V-PACKING; leather; see <b>Packing Kits</b>	2
37‡		GLAND, female, piston; SST; see <b>Packing Kits</b>	1
38‡		SEAL, valve	1
39‡	★✱	HOUSING, valve	1
	✱✱	HOUSING, valve; SST	1
40‡	★✱	PLUG, valve	1
	✱✱	PLUG, valve; SST	1
41‡		HANDLE, outlet bleed	1
42‡		CLIP, outlet bleed	1
47▲	★✱184090	LABEL, warning	1
	✱✱184462	LABEL, warning	1
49	★✱100508	SCREW, drive	4
	✱✱109202	SCREW, drive	4
50▲	172479	TAG, instruction, safety	1
51	✱✱	PLUG, pipe	1
52	197561	PLATE, identification	1
60	✱✱	PLUG, pipe	1

★ *Model L250CS only.*

✱ *Model L250CM only.*

✱ *Model L250SS only.*

✱ *Model L250SM only.*

‡ *See **Kits** table.*

▲ *Replacement Danger and Warning labels, tags, and cards are available at no cost.*

# Kits

The following table indicates which parts (according to reference number) are included in each kit.

Kit	Reference Numbers																																						
	4	5	6	7	8	9	10	11	12	13	14	15	16	17	18	20	21	23	24	29	30	31	32	33	34	35	36	37	38	39	40	41	42	51	60				
255513	✓	✓	✓	✓	✓										✓		✓				✓	✓				✓	✓	✓	✓	✓									
255514	✓	✓	✓	✓				✓					✓	✓		✓		✓			✓	✓				✓	✓	✓	✓	✓									
255515	✓	✓	✓	✓	✓										✓		✓				✓	✓				✓	✓	✓	✓	✓									
255516	✓	✓	✓	✓							✓			✓	✓		✓				✓	✓				✓	✓	✓	✓	✓									
255528	✓	✓	✓	✓	✓																																		
255529	✓	✓	✓	✓	✓																																		
255530	✓	✓	✓	✓							✓																												
255536															✓		✓				✓		✓																
255543																	✓									✓	✓	✓	✓	✓									
255544																	✓									✓	✓	✓	✓	✓									
255545																	✓									✓	✓	✓	✓	✓									
255546																	✓									✓	✓	✓	✓	✓									
255554															✓		✓	✓			✓	✓	✓																
255561																✓	✓							✓	✓	✓	✓	✓	✓	✓									
255562																✓	✓							✓	✓	✓	✓	✓	✓	✓									
255563																✓	✓							✓	✓	✓	✓	✓	✓	✓									
255564																✓	✓							✓	✓	✓	✓	✓	✓	✓									
255583															✓		✓			✓						✓	✓	✓	✓	✓									
255584															✓		✓			✓						✓	✓	✓	✓	✓									
255585															✓		✓			✓						✓	✓	✓	✓	✓									
255586															✓		✓			✓						✓	✓	✓	✓	✓									
255597															✓	✓		✓				✓		✓															
255598															✓	✓		✓				✓		✓															
237908																																				✓	✓	✓	✓
255616																																				✓	✓	✓	✓
255620																																							
255694	✓	✓	✓		✓										✓		✓							✓		✓		✓	✓	✓									
255698	✓	✓	✓	✓		✓	✓	✓	✓	✓	✓	✓	✓	✓																							✓	✓	
255701	✓	✓	✓	✓		✓	✓	✓	✓	✓	✓	✓	✓																								✓	✓	

## Kit Descriptions

Kit	Description
255513	Complete Seal Kit, L250CS
255514	Complete Seal Kit, L250CM
255515	Complete Seal Kit, L250SS
255516	Complete Seal Kit, L250SM
255528	Throat Seal Kit, L250CS
255529	Throat Seal Kit, L250SS
255530	Throat Seal Kit, L250CM and L250SM
255536	Piston Kit
255543	Intake Soft Seal Kit, L250CS
255544	Intake Soft Seal Kit, L250CM
255545	Intake Soft Seal Kit, L250SS
255546	Intake Soft Seal Kit, L250SM
255554	Piston Seal Metal and Soft Kit
255561	Intake Valve Seal Metal and Soft Kit; L250CS
255562	Intake Valve Seal Metal and Soft Kit; L250CM
255563	Intake Valve Seal Metal and Soft Kit; L250SS
255564	Intake Valve Seal Metal and Soft Kit; L250SM
255573	Displacement Rod Kit, L250CS and L250SS
255574	Displacement Rod Kit, L250CM and L250SM
255583	Priming Piston Rod Kit; L250CS
255584	Priming Piston Rod Kit; L250CM
255585	Priming Piston Rod Kit; L250SS
255586	Priming Piston Rod Kit; L250SM
255597	Cylinder Kit; L250CS and L250SS
255598	Cylinder Kit; L250CM and L250SM
255605	Outlet Kit; Carbon models
255606	Outlet Kit; SST models
255611	Intake Housing Kit; Carbon models
255612	Intake Housing Kit; SST models
237908	Bleed Valve Kit, all Carbon models

Kit	Description
255616	Bleed Valve Kit, all SST models
255620	Enclosed Wet Cup Seal Kit; MaxLife, L250CM and L250SM
255694	Complete Seal Kit; PTFE Alternative; includes all PTFE alternative kits listed under <b>Packing Kits</b> , page 6.
255698	Enclosed Wet Cup Kit; L250CM
255701	Enclosed Wet Cup Kit; L250SM

# Packing Kits

## Throat Packings

### Severe Duty

Ref.	Description	Qty.
5	★ GLAND, packing, female	1
	* GLAND, packing, female; SST	1
6	V-PACKING; UHMWPE	3
7	V-PACKING; PTFE	2
8	★ GLAND, packing, male	1
	* GLAND, packing, male; SST	1

### MaxLife

Ref.	Description	Qty.
5	SEAL, u-cup	1
6	SPACER, metal	1
7	SPACER, acetal	1

### Severe Duty

\* Lips face down

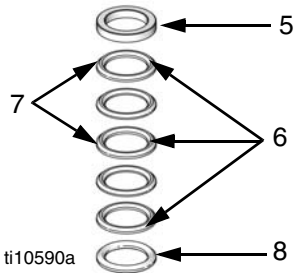

### MaxLife

\* Lips face down

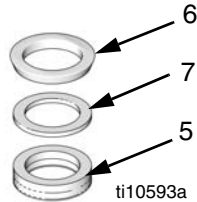

### PTFE Alternative

Ref.	Description	Qty.
5	GLAND, packing, female	1
6	V-PACKING, PTFE	5
8	GLAND, packing, male	1

\* Lips face down

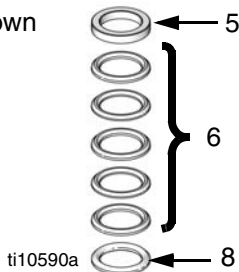

# Intake Valve Packings

## Severe Duty and MaxLife

Ref.	Description	Qty.
34	GLAND, male, priming piston: SST	1
35	PACKING; UHMWPE	2
36	★* PACKING; PTFE (Severe Duty)	2
	*✕ PACKING; leather (MaxLife)	2
37	GLAND, female, priming piston	1

★ Model L250CS only.

\*✕ Model L250CM only.

\* Model L250SS only.

✕ Model L250SM only.

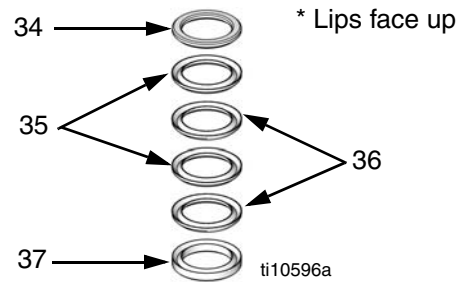

### PTFE Alternative

Ref.	Description	Qty.
34	GLAND, male, priming piston	1
35	PACKING, PTFE	4
37	GLAND, female, priming piston	1

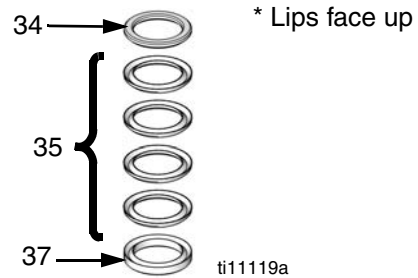

## Piston Packings

### PTFE Alternative

Ref.	Description	Qty.
31	SEAL, piston	1

All written and visual data contained in this document reflects the latest product information available at the time of publication. Graco reserves the right to make changes at any time without notice.

For patent information, see [www.graco.com/patents](http://www.graco.com/patents).

Original instructions. This manual contains English. MM 312469

**Graco Headquarters:** Minneapolis  
**International Offices:** Belgium, China, Japan, Korea

**GRACO INC. AND SUBSIDIARIES • P.O. BOX 1441 • MINNEAPOLIS MN 55440-1441 • USA**

Copyright 2007, Graco Inc. All Graco manufacturing locations are registered to ISO 9001.

[www.graco.com](http://www.graco.com)

Revised February 2013